



Rookwood Way, E3

£600,000

A two double bedroom flat situated by River Lea in the upcoming Fish Island Village. The property has an open plan kitchen/living area, ample storage and a private south west facing balcony which can be accessed from the both reception room and one of the bedrooms.

The property is located a short walk from the greeneries of Queen Elizabeth Olympic Park and Victoria Park. Hackney Wick overground station is also close by as well as Westfield Shopping centre across the park.

Features

- Private Balcony
- Long Lease
- Fourth Floor
- Concierge & Gym
- Queen Elizabeth Park
- Victoria Park

Rookwood Way, London, E3

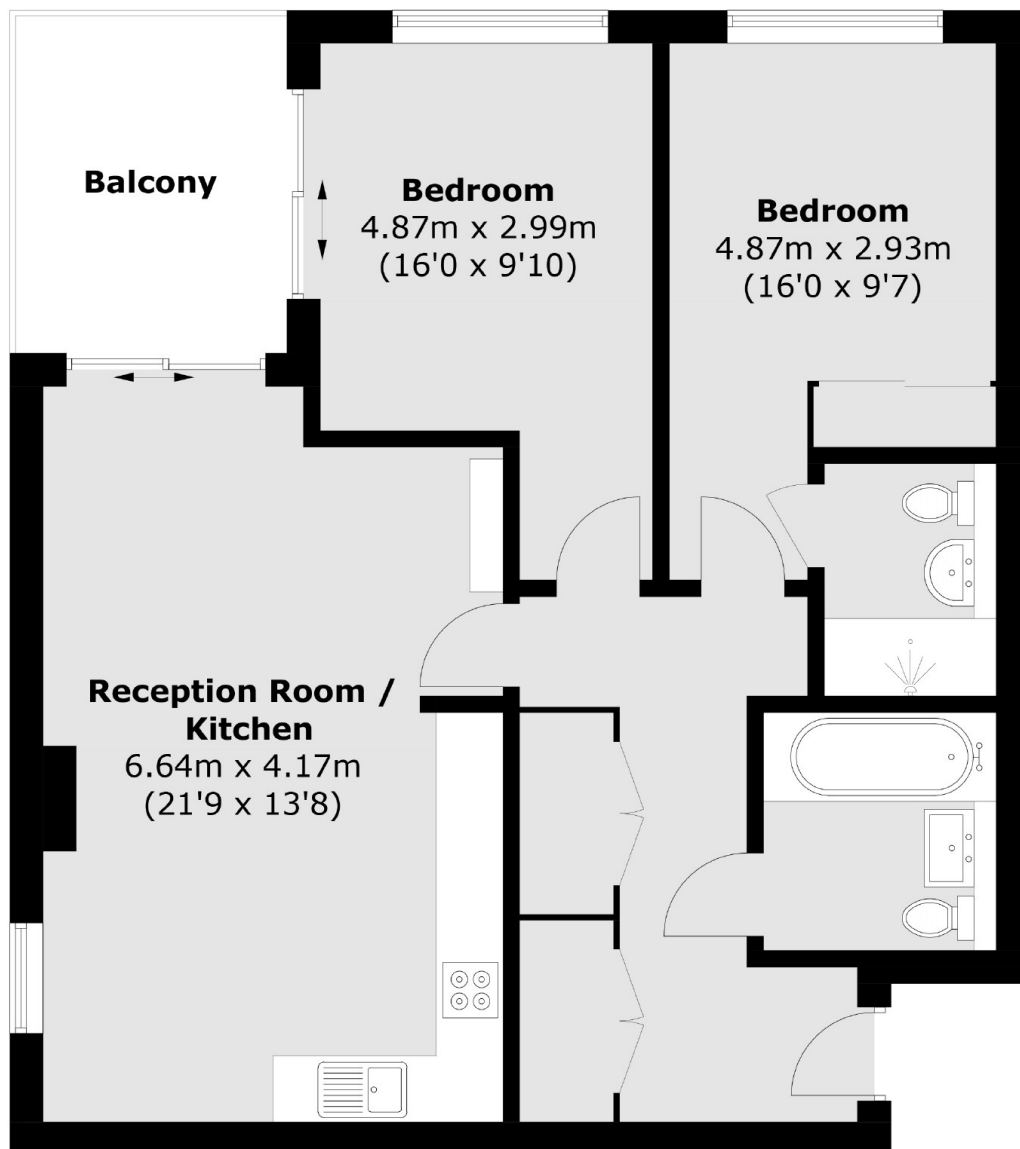

Total area (approx.): 74.8 sq. m (805.1 sq. ft)
Balcony: 7.5 sq. m (80.7 sq. ft)