



## Shore Place, E9

£576 Per week

A large two bedroom apartment in Grendon House, moments away from Victoria Park. This property has been completely refurbished throughout and comes furnished with a separate kitchen and wood floors throughout.

Central location within each reach of Broadway Market, London Fields and Victoria Park Village for all local shops, bars and restaurants.

### Features

- Two Double Bedrooms
- Refurbished
- Separate Kitchen
- Wood Floors
- Bright Throughout
- Furnished

# Shore Place, London, E9

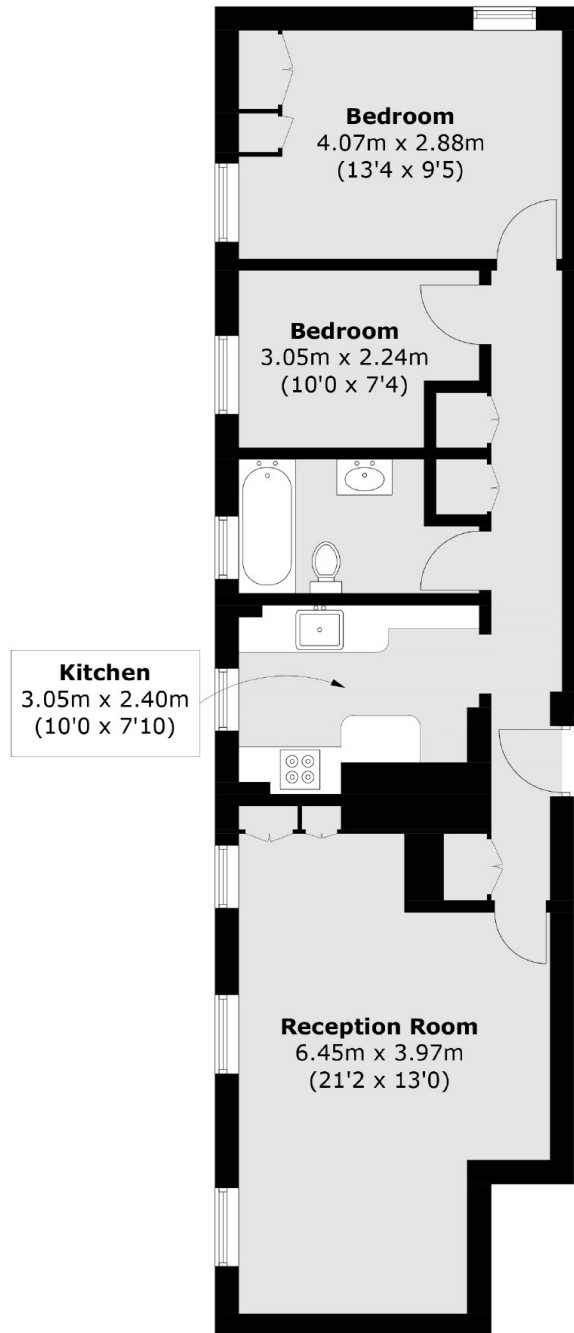

Total area (approx.): 63.7 sq. m (685.7 sq. ft)