



Lovelace Street, E8

£634 Per week

A large two double bedroom apartment in the ever popular North Mill Apartments. This property comes with an open plan reception, wooden flooring throughout and private balcony with an on site concierge.

Located opposite Haggerston Park and within easy reach of Dalston Kingsland, Shoreditch and Broadway Market for all local cafés, restaurants and bars.

Features

- Two Double Bedrooms
- Two Bathrooms
- Private Balcony
- Wood Floors
- Concierge
- Furnished

Lovell Street, London, E8

Fifth Floor

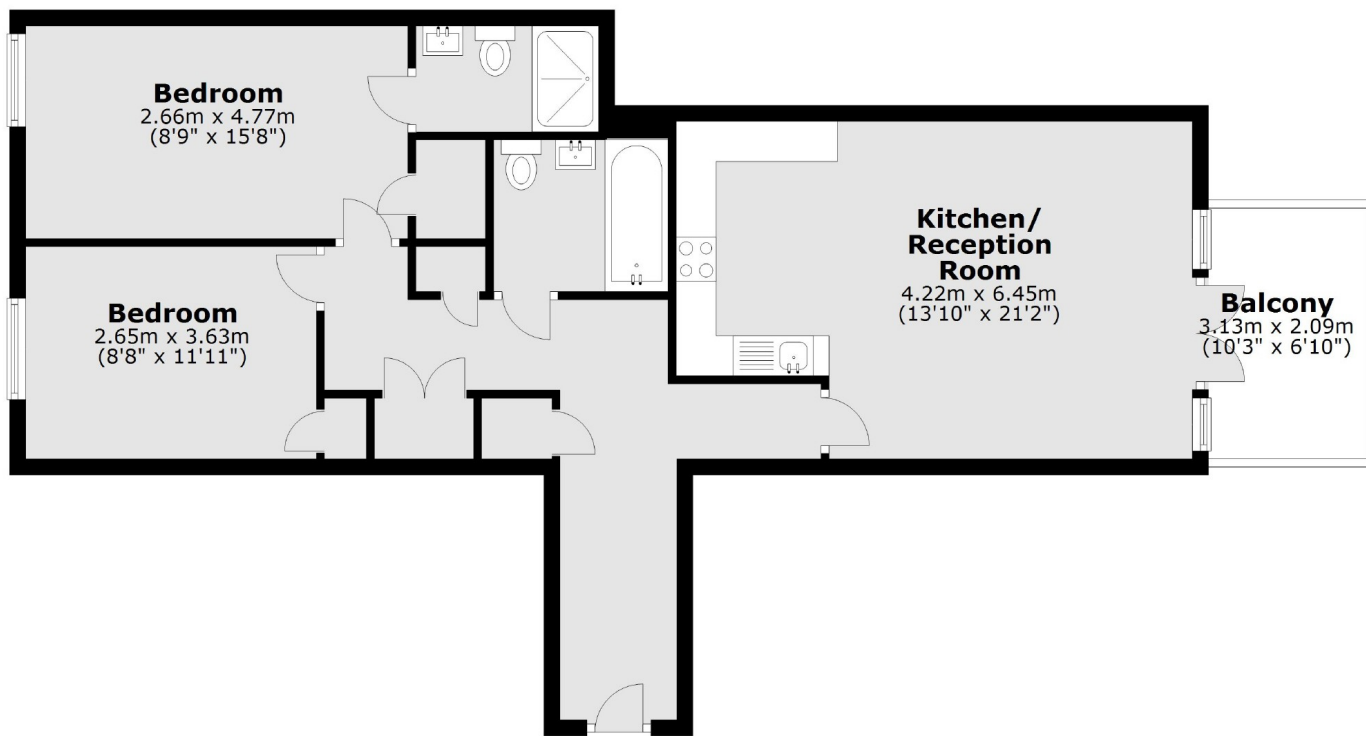

Total area: approx. 74.7 sq. metres (804.4 sq. feet)