



Roman Road, E3

£500,000

A two double bedroom lateral apartment with a private courtyard garden. This property has been lovingly renovated by the current owners with wooden flooring, open plan living area, a kitchen designed for entertaining and cooking. This property has large wooden sash windows throughout and exposed beams.

Located on the vibrant roman road, this apartment has an abundance of cafes, shops and eateries on its doorstep. Victoria park is under a quarter of a mile walk. Bow Road, Mile End, Bow Church and Hackney Wick are all within a mile distance, linking you easily to the district, H&C, central, DLR and overground.

Features

Offers In Excess Of
Two Double Bedrooms
Period Features
Open Plan
Courtyard Garden
Sash Windows
Wooden Flooring

Roman Road, London, E3

First Floor

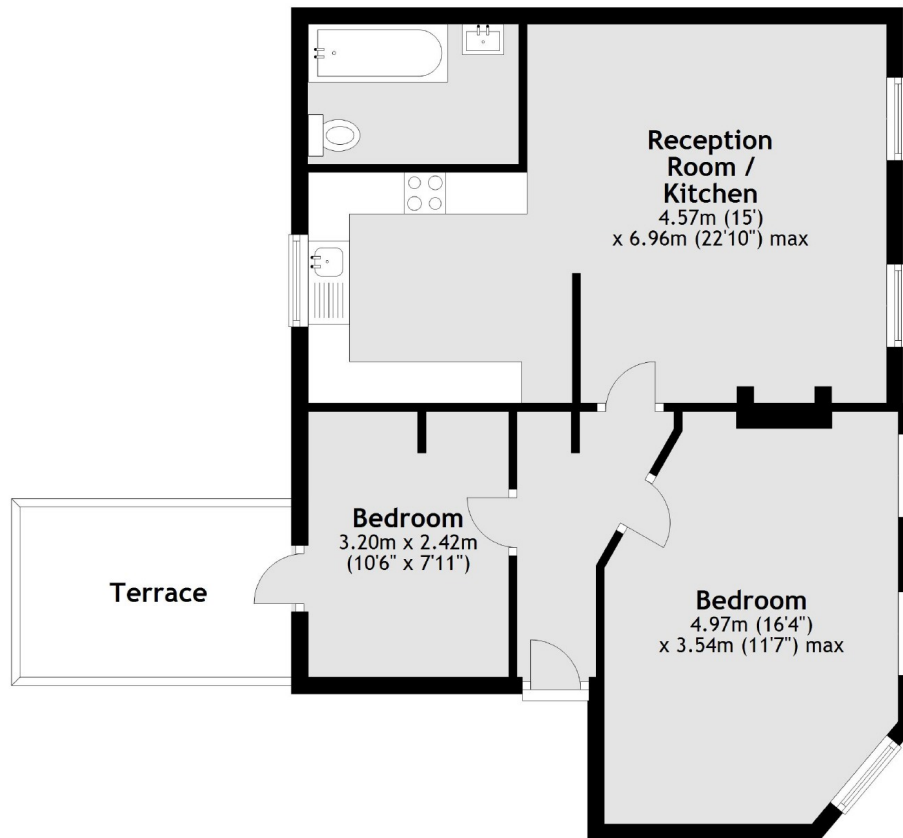

Main area: Approx. 60.9 sq. metres (655.0 sq. feet)
Plus roof terrace, approx. 6.9 sq. metres (74.3 sq. feet)