



## Darnley Road, E9

£450,000

An end of terrace, grade two listed, two double bedroom apartment with a private outdoor area. This property has sash windows throughout, an open plan living and kitchen area, good storage and access to a shared garden. It is being offered chain free and also comes with residential parking.

Darnley road is located off Mare Street and the abundance of shops, restaurants and amenities of Hackney Central can be located under a quarter of mile walk. The nearest station is London Fields on the overground.

### Features

Offers In Excess Of  
Available Chain Free  
Residential Parking  
Two Double Bedrooms  
Grade Two Listed Building  
Sash Windows  
Private Outdoor Area  
Open Plan Living

# Darnley Road, London, E9

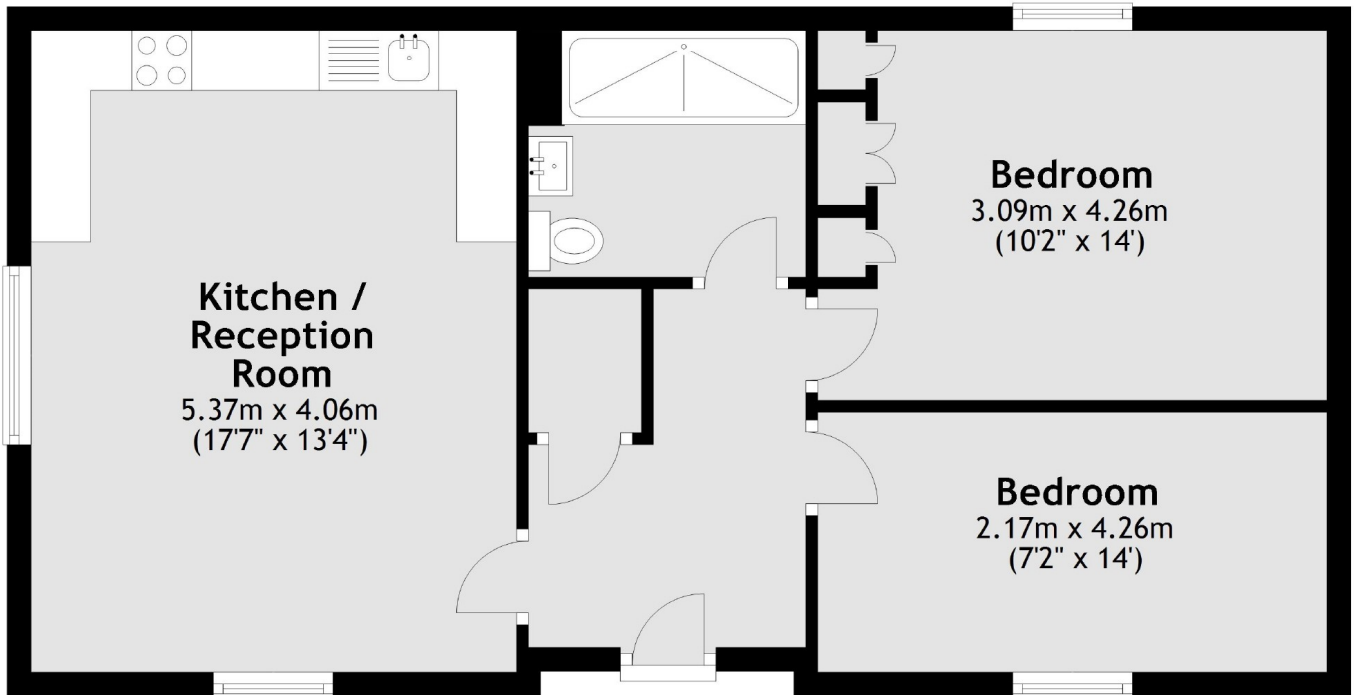

Total area: approx. 57.7 sq. metres (620.6 sq. feet)