



Darnley Road, E9

£475,000

An end of terrace, grade two listed, two double bedroom apartment with a private outdoor area. This property has sash windows throughout, an open plan living and kitchen area, good storage and access to a shared garden. It is being offered chain free and also comes with residential parking.

Darnley road is located off Mare Street and the abundance of shops, restaurants and amenities of Hackney Central can be located under a quarter of mile walk. The nearest station is London Fields on the overground.

Features

Offers In Excess Of
Available Chain Free
Residential Parking
Two Double Bedrooms
Grade Two Listed Building
Sash Windows
Private Outdoor Area
Open Plan Living

Darnley Road, London, E9

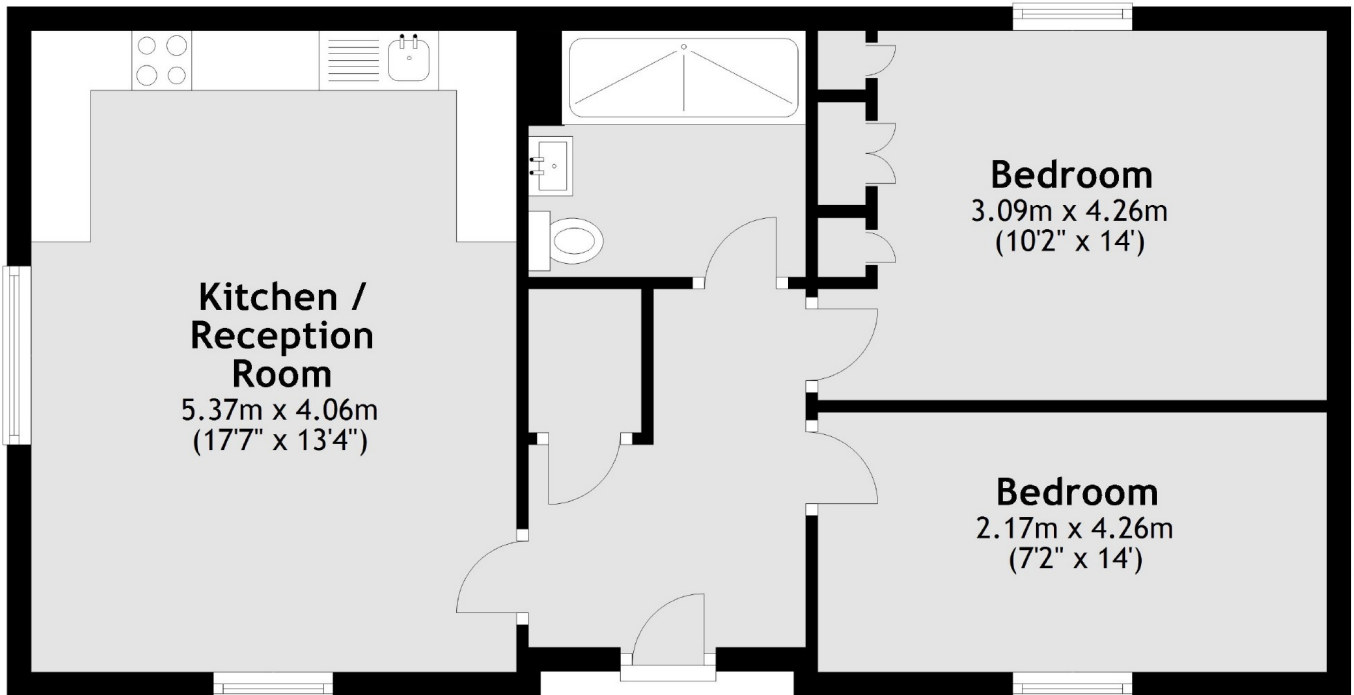

Total area: approx. 57.7 sq. metres (620.6 sq. feet)