



Cardigan Road, E3

£875,000

A three double bedroom terraced Victorian home in the heart of Bow. This property benefits from two reception rooms and a separate kitchen, which leads out to a private landscaped garden.

Well located nearby to ample green spaces such as Victoria Park and Queen Elizabeth Olympic Park. Both Mile End and Bow Road stations are just over half a Mile away, making for great transport links in and around the city.

Features

- Three Double Bedrooms
- Double Reception Room
- Private Garden
- Victoria Park
- Bow Road Station
- Mile End Station

Cardigan Road, London, E3

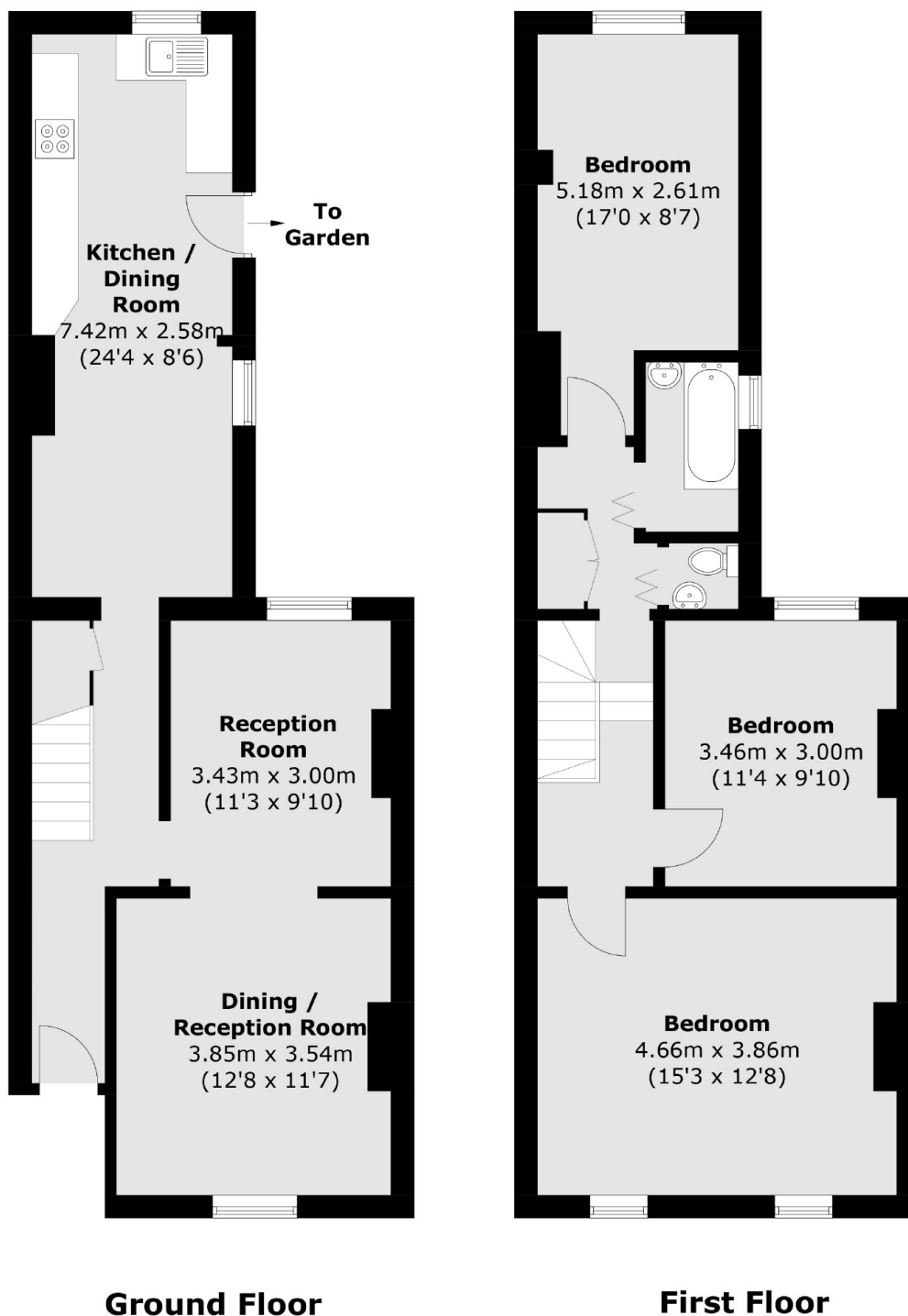

Total area (approx.): 107.3 sq. m (1,155.0 sq. ft)