

4 RIVERLIGHT QUAY

LONDON SW11

Riverlight Quay, SW11

APPROX. GROSS INTERNAL AREA *
1987 Sq Ft - 184.59 Sq M

This floorplan is for GUIDANCE ONLY and NOT FOR VALUATION purposes.

Key :
CH - Ceiling Height

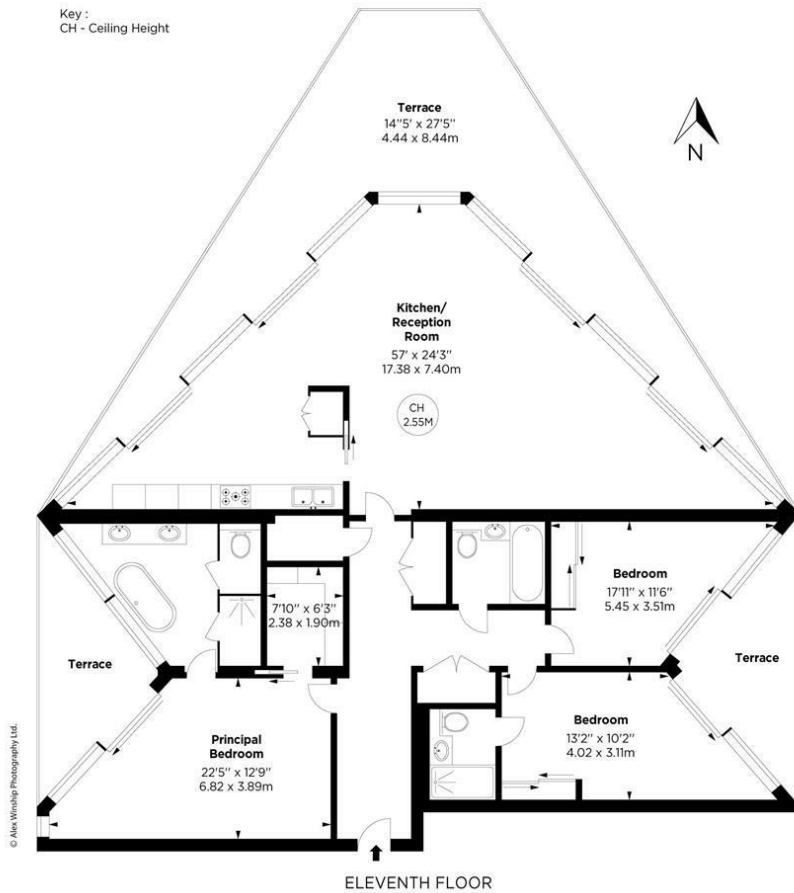

This eleventh floor three-bedroom penthouse (1,987 sq ft / 185 sq m) has stunning panoramic views of London. The reception room and open plan kitchen benefit from wrap around floor-to-ceiling windows which open onto a covered roof terrace overlooking the River. The apartment has been furnished to a high standard and has one underground parking space, whilst the development has a 24-hour concierge service, excellent security and residents` facilities including a pool, gym and private screening room. ALSO AVAILABLE FOR SHORT LET AT £4,000 PER WEEK.

Riverlight Quay has an enviable position on the south bank of the River Thames close to Kensington and Chelsea. With excellent infrastructure, Battersea Park and Queenstown Road overground stations run regular trains to Victoria and Waterloo, whilst Vauxhall overground and underground station provides further access to the London rail and tube network.

Deposit: equivalent to six weeks' rent (or eight weeks if permission to keep a pet in the property is granted). Minimum tenancy length: 12 months. Council Tax: Band H.

Furnished

Viewing strictly by appointment with Mark Tunstall Property

Energy Efficiency Rating		
	Current	Potential
Very energy efficient - lower running costs		
(92 plus) A		
(81-91) B	86	86
(69-80) C		
(55-68) D		
(39-54) E		
(21-38) F		
(1-20) G		
Not energy efficient - higher running costs		
England & Wales	EU Directive 2002/91/EC	



MARK
TUNSTALL
PROPERTY

INFO@TUNSTALLPROPERTY.CO.UK
+44 (0)20 3011 1775

IMPORTANT NOTICE

THIS BROCHURE AND THE DESCRIPTIONS AND MEASUREMENTS HEREIN DO NOT CONSTITUTE REPRESENTATION AND WHILST EVERY EFFORT HAS BEEN MADE TO ENSURE ACCURACY, THIS CANNOT BE GUARANTEED A COPY OF THE FULL ENERGY PERFORMANCE CERTIFICATE IS AVAILABLE UPON REQUEST.