



PEMBROKE SQUARE

LONDON W8



MARK TUNSTALL
PROPERTY



A beautiful Grade-II listed four bed family house (2,909 sq ft / 270 sq m) arranged over five floors, with a wonderful private south facing garden (64ft / 19.7m) and access to the square garden and its hard tennis court. The house is strong on reception space with an elegant first floor drawing room with floor-to-ceiling windows providing leafy views over the square, a kitchen/dining room on the ground floor and a lower ground floor that provides two further interconnecting reception rooms with access up to the garden.

Pembroke Square is a delightful garden square situated between Scarsdale Villas and Edwardes Square, south of Kensington High Street, which provides excellent communications via bus and underground, and a broad range of shops and restaurants. The open space of Holland Park is within easy walking distance.'

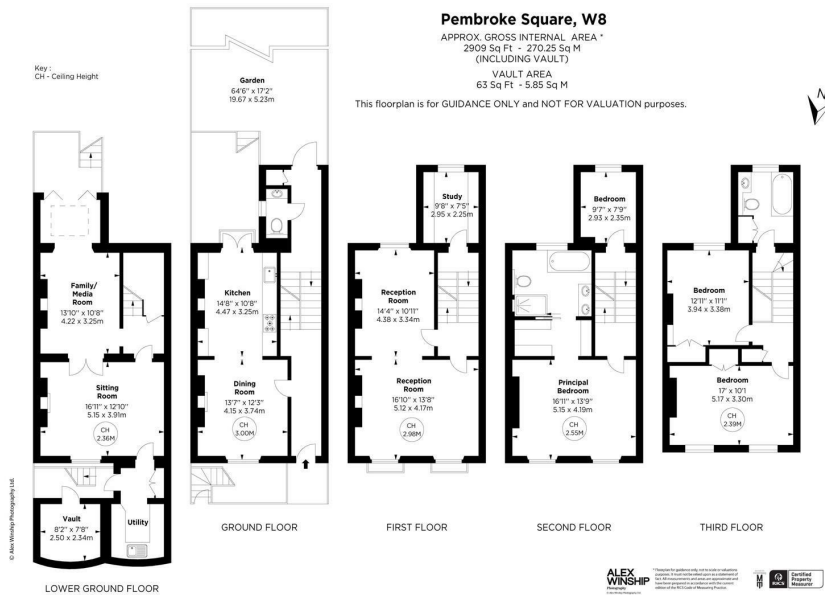

Unfurnished
 Viewing strictly by appointment with Mark Tunstall Property

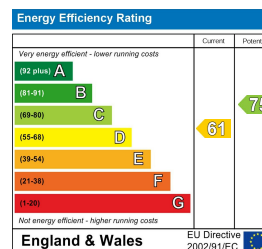

MARK TUNSTALL PROPERTY
 INFO@TUNSTALLPROPERTY.CO.UK
 +44 (0)20 3011 1775

IMPORTANT NOTICE

THIS BROCHURE AND THE DESCRIPTIONS AND MEASUREMENTS HEREIN DO NOT CONSTITUTE REPRESENTATION AND WHILST EVERY EFFORT HAS BEEN MADE TO ENSURE ACCURACY, THIS CANNOT BE GUARANTEED A COPY OF THE FULL ENERGY PERFORMANCE CERTIFICATE IS AVAILABLE UPON REQUEST.