

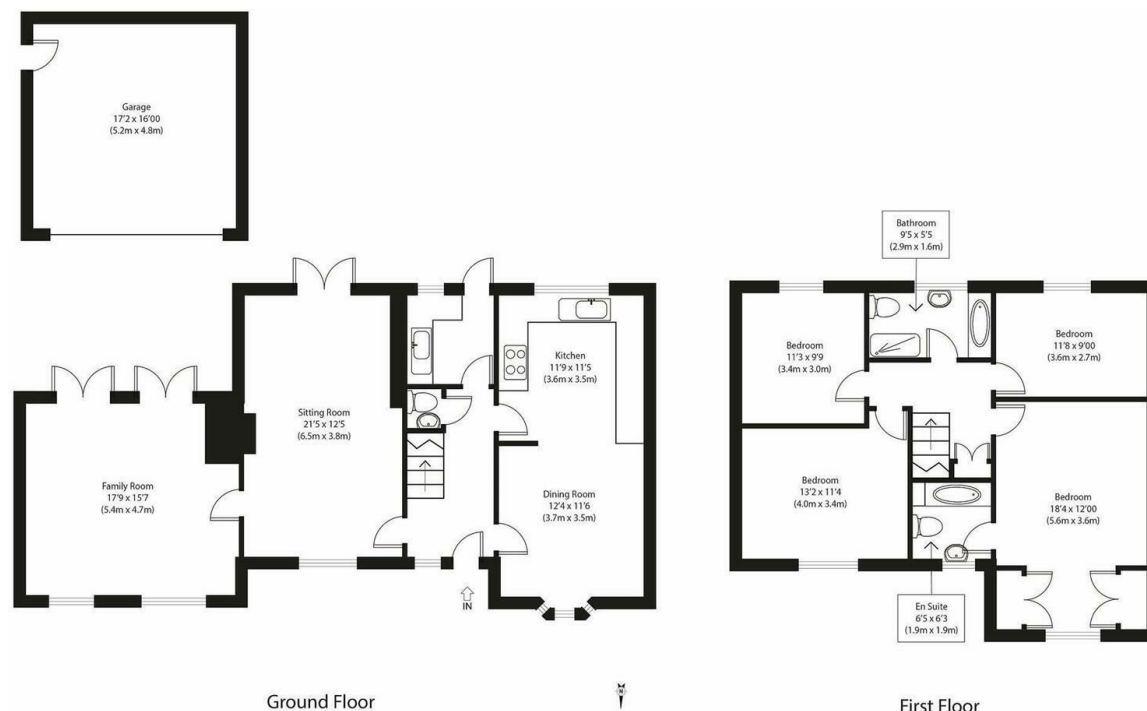

15 Deben Road, Colchester, CO4 3UZ

£2,000 Per Month

- Exceptionally Spacious Detached House
- Three Large Reception Rooms
- Detached Double Garage with Power
- Available End of October
- Four Double Bedrooms
- Kitchen & Utility
- Situated In The Popular "Roach Vale" Cul-De-Sac
- En-Suite & Built-In Wardrobes to the Master Bedroom
- South Facing Garden with Patio
- Unfurnished



Approximate Gross Internal Area
Main House 2050 sq ft (190 sq m)
Garage 275 sq ft (26 sq m)
Total 2325 sq ft (216 sq m)

Disclaimer: Floorplans are approximate and are for illustrative purposes only. While we do not doubt the floor plan accuracy and completeness, you or your advisors should conduct a careful independent investigation of the property in respect of necessary situations. copyright www.sphotos.co.uk

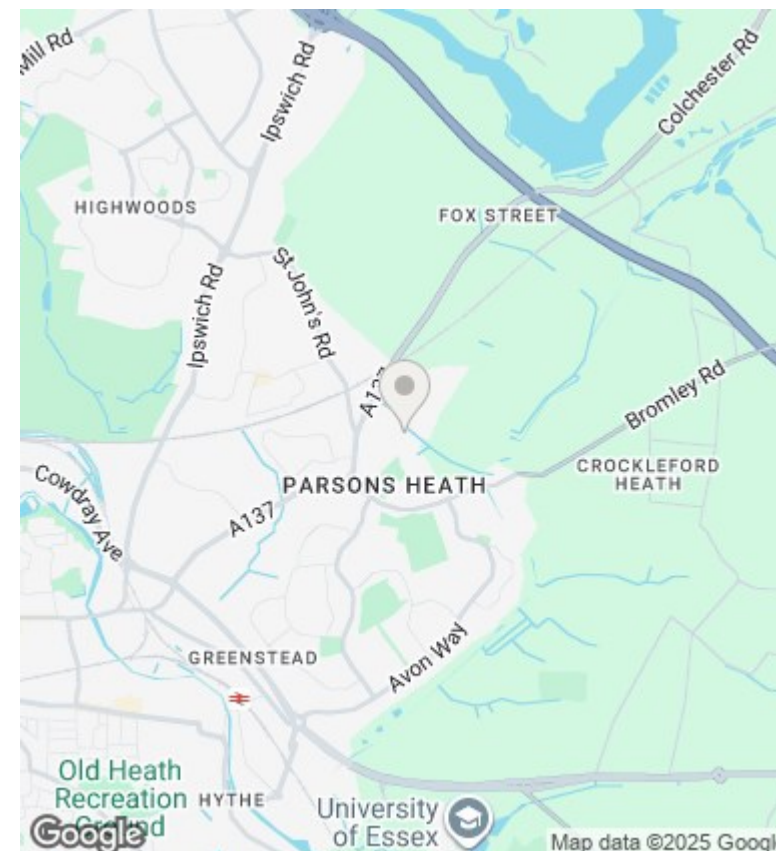

Directions

Viewings

Viewings by arrangement only. Call 01206 572555 to make an appointment.

Council Tax Band

EPC Rating:

Energy Efficiency Rating		
	Current	Potential
Very energy efficient - lower running costs		
(92 plus) A		
(81-91) B		
(69-80) C		
(55-68) D		
(39-54) E		
(21-38) F		
(1-20) G		
Not energy efficient - higher running costs		
England & Wales	EU Directive 2002/91/EC	