



HERTFORD STREET

MAYFAIR W1J



A TWO DOUBLE BEDROOM, TWO BATHROOM APARTMENT ON THE FIRST FLOOR WITH A LARGE RECEPTION ROOM OVERLOOKING THE COURTYARD.

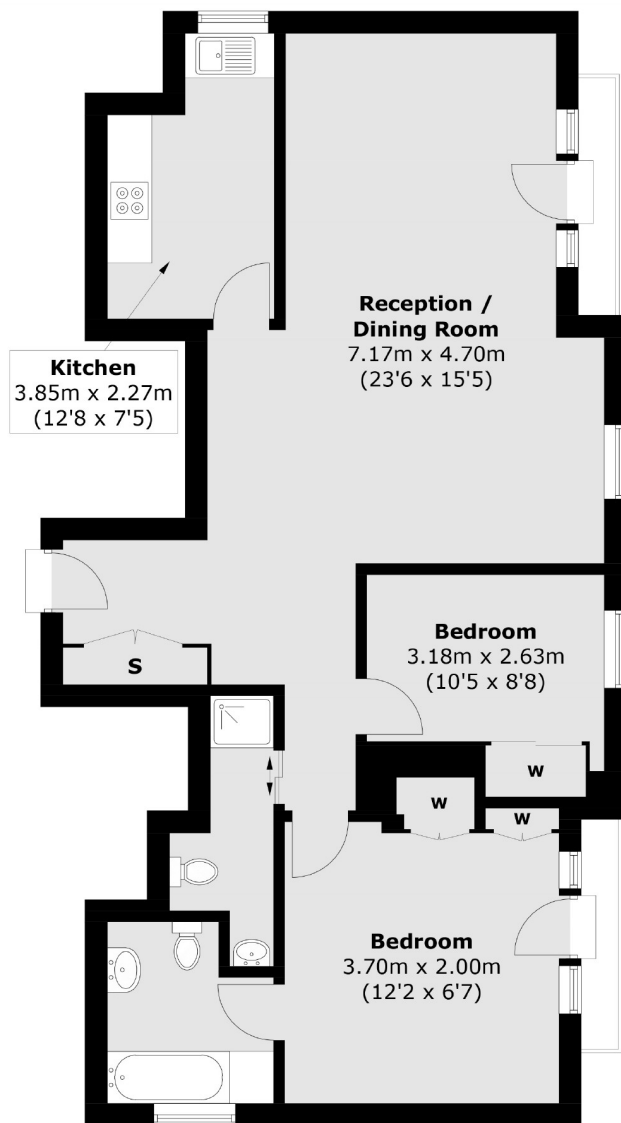

Total area (approx.): 84.2 sq. m (906.6 sq. ft)
External area : 3.1 sq. m (33.3 sq. ft)

We aim to make our particulars both accurate and reliable. However they are not guaranteed; nor do they form part of an offer or contract. If you require clarification on any points then please contact us, especially if you're traveling some distance to view. Please note that appliances and heating systems have not been tested and therefore no warranties can be given as to their working order. Energy Rating: E



Within the vibrant area of Shepherd's Market this building is to the east side of Hertford Street, close to Green Park underground station.

FEATURES

- Two Double Bedrooms
- Two Bathrooms
- Lift Access
- 24 hr Porter
- Wood Flooring
- Green Park

Price: £1,100 Per week



WETHERELL
MAYFAIR'S FINEST PROPERTIES

102 Mount Street • London • W1K 2TH
T: 020 7529 5588 E: rentals@wetherell.co.uk
wetherell.co.uk

NO ONE KNOWS MAYFAIR BETTER THAN WETHERELL