



# HAYS MEWS

## MAYFAIR W1J



THIS THREE BEDROOM MEWS APARTMENT, LOCATED OFF BERKELEY SQUARE HAS BEEN REFURBISHED TO AN EXCELLENT STANDARD THROUGHOUT.

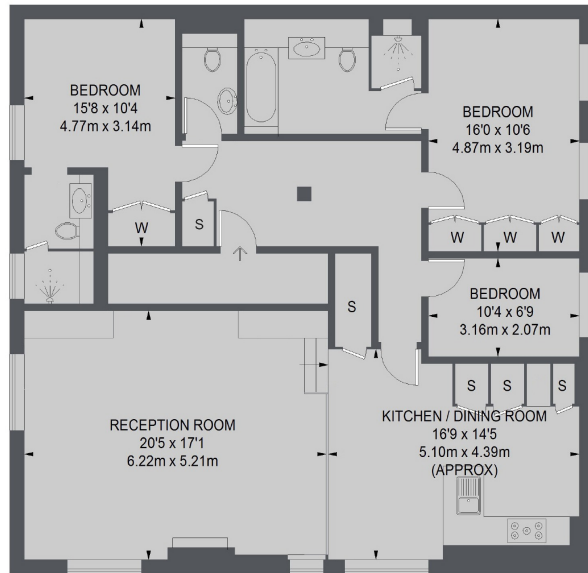

FIRST FLOOR

TOTAL APPROX. FLOOR AREA  
(EXCLUDING COMMUNAL AREA)  
1359 SQ. FT. (126.25 SQ. M.)

Boasting excellent dining and entertaining space, the double reception room is split across two levels. The upper level has an open plan kitchen, breakfast bar and dining space and the lower level provides the reception room for relaxing or entertaining guests.

The two large double bedrooms both benefit from built-in storage and luxury en suite bathrooms. The third bedroom can double up as a study space with additional guest WC. The property has been recently renovated offering wooden flooring and contemporary fixtures, fittings and furnishings throughout.

#### FEATURES

- Three Bedrooms
- Recently Refurbished
- Split-Level Reception
- Two Bathrooms
- Contemporary Finish
- Excellent Location

Price: £1,950 Per week

We aim to make our particulars both accurate and reliable. However they are not guaranteed; nor do they form part of an offer or contract. If you require clarification on any points then please contact us, especially if you're traveling some distance to view. Please note that appliances and heating systems have not been tested and therefore no warranties can be given as to their working order. Energy Rating: E

The apartment is located on the corner of Hays Mews and Chesterfield Hill, close to the open spaces of Green Park and Hyde Park.



**WETHERELL**  
MAYFAIR'S FINEST PROPERTIES

102 Mount Street • London • W1K 2TH  
T: 020 7529 5588 E: [rentals@wetherell.co.uk](mailto:rentals@wetherell.co.uk)

[wetherell.co.uk](http://wetherell.co.uk)

NO ONE KNOWS MAYFAIR BETTER THAN WETHERELL