



WETHERELL
MAYFAIR'S FINEST PROPERTIES



GROSVENOR SQUARE, W1K

£4,600 PER WEEK

Situated on the first floor of the building, the apartment comprises of Entrance Hall, Double Reception, 3 Double Bedrooms, 1 Single Bedroom, 3 Bathrooms (1 En-Suite), Utility Room and Kitchen.

This delightful Four-Bedroom apartment has built-in wardrobes and the master has an en suite bathroom. There are a further two bathrooms as well as an independent guest WC. The spacious entrance hall leads directly to an open plan, spacious reception, and dining room. The apartment also benefits from its own utility room just off the large kitchen. There are plenty of storage cupboards both in bedrooms and reception rooms alike. Located on the 1st floor with lift access alongside 24-hour porter service, this apartment is approximately 2,304 Sq Ft.

This exceptional building with its magnificent entrance hall benefits from 24-hour portage together with a top-class security system. The apartments have a lofty elegance which is typical for this type of mansion block. The apartments are refurbished to the highest standards with large reception rooms that are ideal for entertaining. The apartment block benefits from a private outdoor space available for all residents as well as the open space of Grosvenor Square itself, which is just across the road from the main entrance. The building is pet-friendly.

CENTRALLY LOCATED IN THE HEART OF MAYFAIR, THIS PRESTIGIOUS BLOCK OVERLOOKS THE BEAUTIFUL GARDENS OF GROSVENOR SQUARE.



FEATURES

- Four Bedrooms • Four Bathrooms • Wooden Flooring • 24hr Porter and Security • Newly Renovated • First Floor (Lift Access) •



GROSVENOR SQUARE, LONDON, W1K

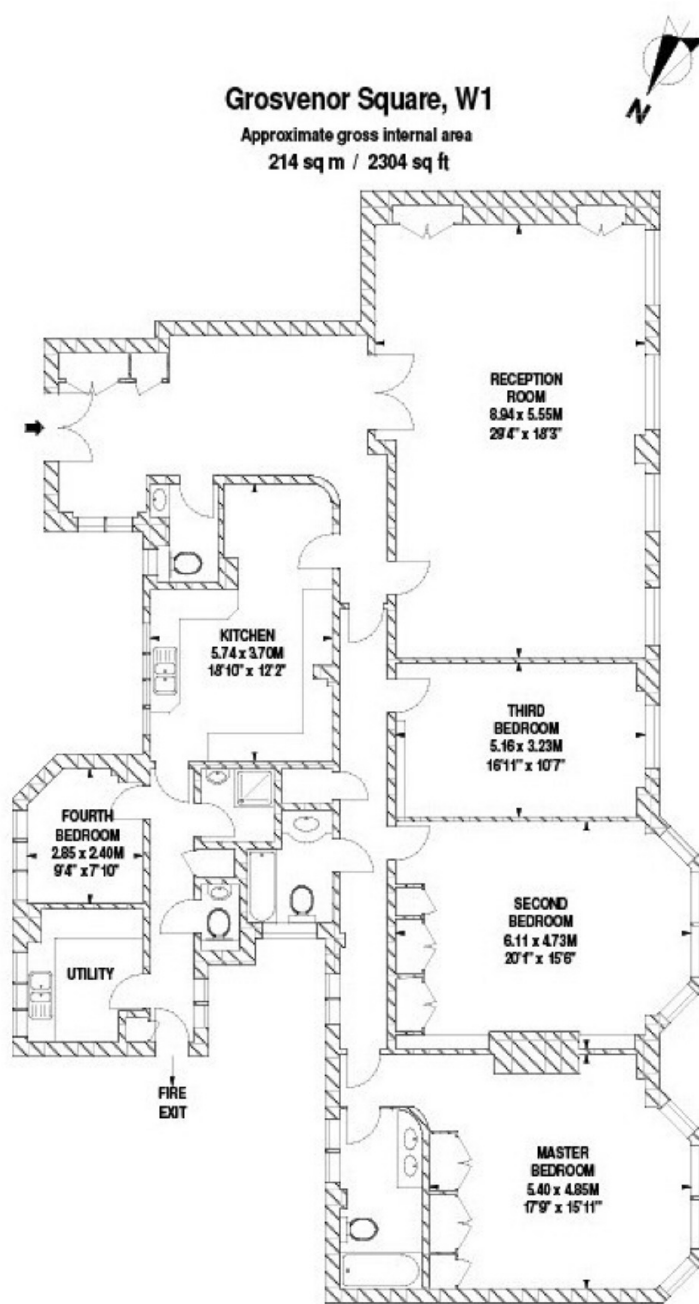

Grosvenor Square

Scale 1:125

Scale floor plans produced by Mays Floorplans ©. Tel 020 3397 4594
All measurements are maximum, and include wardrobes and window bays where applicable



WETHERELL
MAYFAIR'S FINEST PROPERTIES

102 Mount Street,
London, W1K 2TH
T: 020 7529 5566
E: sales@wetherell.co.uk

We aim to make our particulars both accurate and reliable. However they are not guaranteed; nor do they form part of an offer or contract. If you require clarification on any points then please contact us, especially if you're traveling some distance to view. Please note that appliances and heating systems have not been tested and therefore no warranties can be given as to their working order.

wetherell.co.uk