

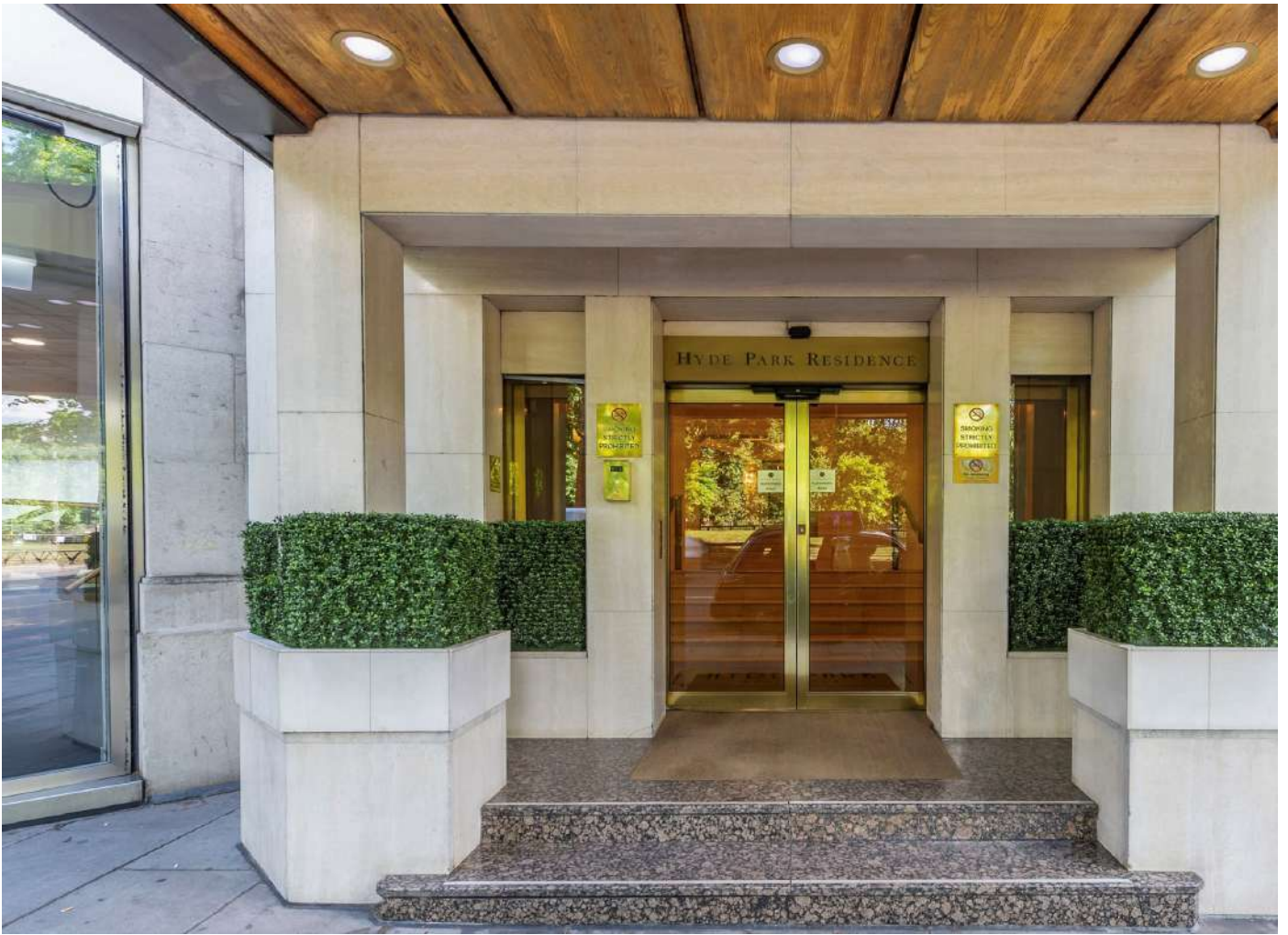

WETHERELL
MAYFAIR'S FINEST PROPERTIES



PARK LANE, W1K

£1,500,000

A one-bedroom apartment in a prestigious block in the heart of Mayfair.

Situated on the 8th floor of this prestigious Park Lane residential block, this well-presented one bedroom apartment measures 694 sq. Ft.

There is a double reception room, currently laid out as a reception and study area, large double bedroom with built in wardrobes, separate bathroom and modern kitchen with integrated appliances.

55 Park Lane is one of the most exclusive addresses in Mayfair, providing residents with 24-hour concierge & security as well as the option (at additional cost) for housekeeping services, laundry and underground parking.

LOCATED OPPOSITE HYDE PARK, BETWEEN THE DORCHESTER AND GROSVENOR HOUSE HOTELS AND WITH ALL OF MAYFAIR ON IT'S DOORSTEP INCLUDING MICHELIN-STARRED RESTAURANTS, PRIVATE MEMBER'S CLUBS AND BOUTIQUE STORES.



FEATURES

- One Bedroom • Park Lane Address • 24 hour Concierge • Lift Access • Long Lease • 694 sq ft •



PARK LANE, LONDON, W1K

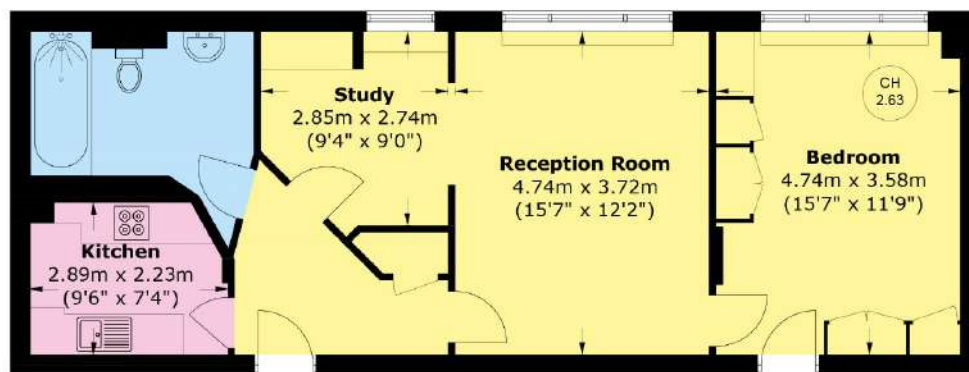

Eighth Floor

Total area (approx.): 64.5 sq. m (694.5 sq. ft)



WETHERELL
MAYFAIR'S FINEST PROPERTIES

102 Mount Street,
London, W1K 2TH
T: 020 7529 5566
E: sales@wetherell.co.uk

We aim to make our particulars both accurate and reliable. However they are not guaranteed; nor do they form part of an offer or contract. If you require clarification on any points then please contact us, especially if you're traveling some distance to view. Please note that appliances and heating systems have not been tested and therefore no warranties can be given as to their working order.

wetherell.co.uk