



**WETHERELL**  
MAYFAIR'S FINEST PROPERTIES



## CHARLES STREET, W1J

**£2,750 PER WEEK**

A beautifully presented three double bedroom penthouse apartment in an attractive period building near to Berkeley Square.

Split over the fourth and fifth floors of this period building access is granted directly via lift on the fourth floor or communal stairway.

The fourth floor gives way to a large reception and separate kitchen diner fitted with high specification German appliances and breakfast bar. The large main suite can be found on the fifth floor along with two further double bedrooms. All bedrooms are en suite.

---

CHARLES STREET RUNS FROM BERKELEY SQUARE AND IS LOCATED IN THE HEART OF RESIDENTIAL MAYFAIR AND IS CONSIDERED ONE OF MAYFAIR'S ORIGINAL PREMIER STREETS.



### FEATURES

- Three Double Bedrooms
- Three Bathrooms
- Large Reception Room
- Direct Lift Access
- Wood Flooring
- Prime Mayfair





# CHARLES STREET, LONDON, W1J

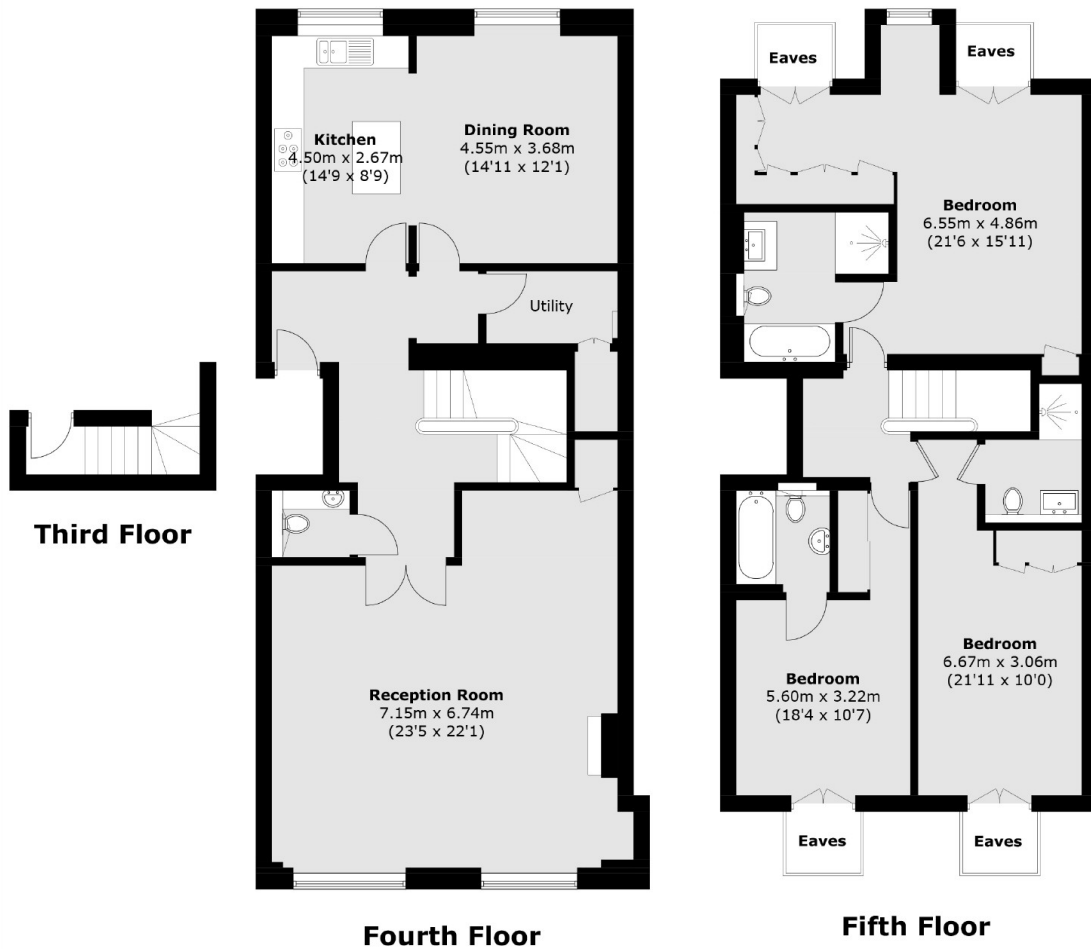

Total area (approx.): 185.9 sq. m (2,000.9 sq. ft)  
(Excluding Eaves)