

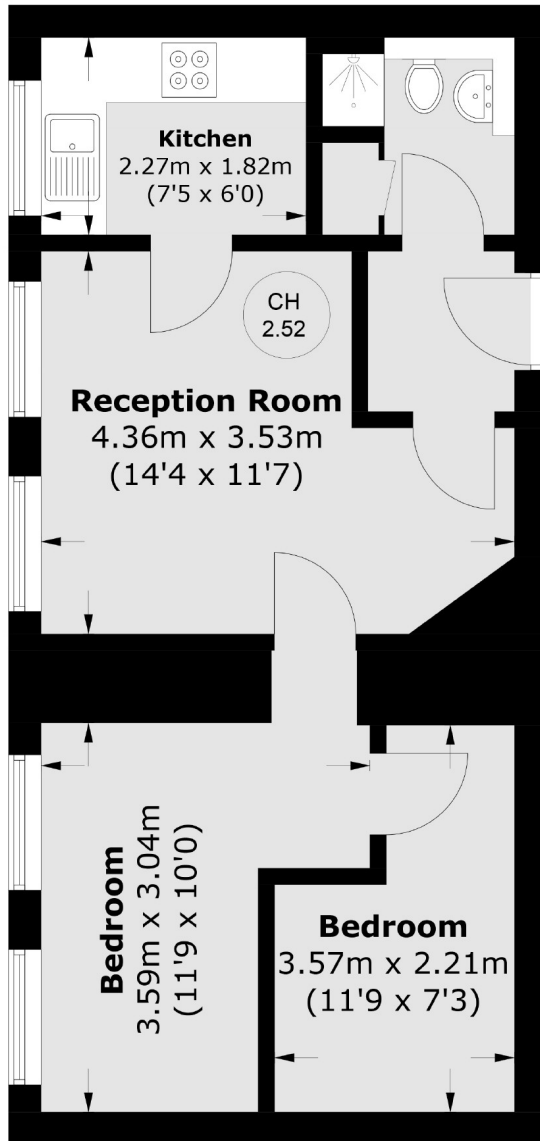

# JERMYN STREET MAYFAIR SW1Y



A MODERN AND WELL PRESENTED ONE BEDROOM APARTMENT SET WITHIN A LOVELY PERIOD BLOCK BENEFITTING FROM DAY PORTER IN THE HEART OF ST. JAMES'.



Total area (approx.): 43.3 sq. m (466.1 sq. ft)



A modern and well presented one bedroom apartment set within a lovely period block benefitting from day porter in the heart of St. James'.

Jermyn Street, well known for its established gentleman's outfitters, art galleries, hotels, and restaurants, is excellently located close to Piccadilly and St James Park. Dating from 1664, it retains a feeling of traditional charm whilst affording modern convenience.

#### FEATURES

- One Double Bedroom
- Built-In Storage
- Secure Portered Building
- Large Reception Room
- Lift
- Excellent Location

Price: £850 Per week

We aim to make our particulars both accurate and reliable. However they are not guaranteed; nor do they form part of an offer or contract. If you require clarification on any points then please contact us, especially if you're traveling some distance to view. Please note that appliances and heating systems have not been tested and therefore no warranties can be given as to their working order. Energy Rating:



**WETHERELL**  
MAYFAIR'S FINEST PROPERTIES

102 Mount Street • London • W1K 2TH  
T: 020 7529 5588 E: rentals@wetherell.co.uk

wetherell.co.uk