



DOWN STREET

MAYFAIR W1J



SHORT LET. AN EXCEPTIONAL ONE DOUBLE BEDROOM APARTMENT WITH HIGH CEILINGS AND FULLY EQUIPPED KITCHEN, THIS PROPERTY IS IDEAL FOR TENANTS LOOKING FOR LONDON LIVING.

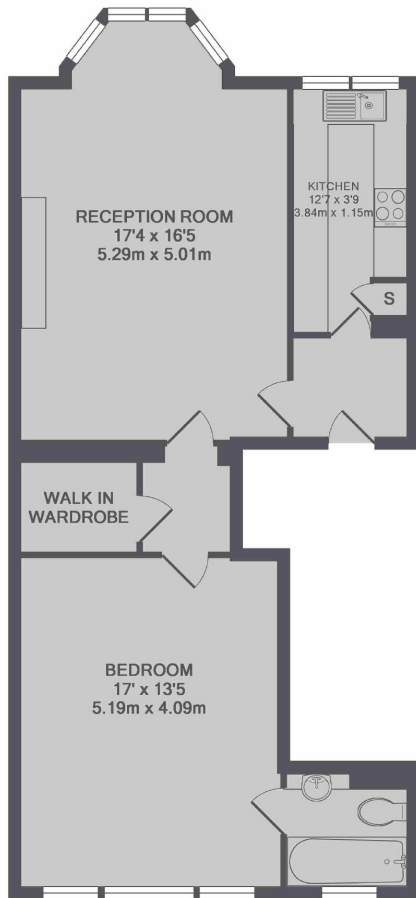

TOTAL APPROX. FLOOR AREA 708 SQ.FT. (65.8 SQ.M.)



SHORT LET. An exceptional one double bedroom apartment with high ceilings and fully equipped kitchen, this property is ideal for tenants looking for London living.

Situated close to one of London's most famous streets Down Street is close to Green Park and Hyde Park Corner stations, both offering great transport links around the city.

FEATURES

- SHORT LET
- All Bills Inclusive
- Fully Furnished
- High Ceilings
- Ample Storage
- Second Floor (Lift Access)

Price: £1,100 Per week

We aim to make our particulars both accurate and reliable. However they are not guaranteed; nor do they form part of an offer or contract. If you require clarification on any points then please contact us, especially if you're traveling some distance to view. Please note that appliances and heating systems have not been tested and therefore no warranties can be given as to their working order. Energy Rating: D



WETHERELL
MAYFAIR'S FINEST PROPERTIES

102 Mount Street • London • W1K 2TH
T: 020 7529 5588 E: rentals@wetherell.co.uk

wetherell.co.uk

NO ONE KNOWS MAYFAIR BETTER THAN WETHERELL