



HAY HILL

MAYFAIR W1J



AN IDEAL ONE BEDROOM PIED-A-TERRE, LOCATED ON THE FIFTH FLOOR AND JUST STEPS AWAY FROM BERKELEY SQUARE. THIS SPACIOUS AND BRIGHT PROPERTY HAS THE ADDED BENEFIT OF LIFT ACCESS AND PORTERAGE.

Hay Hill, W1J

Approximate Gross Internal Area = 57 sq m / 613 sq ft

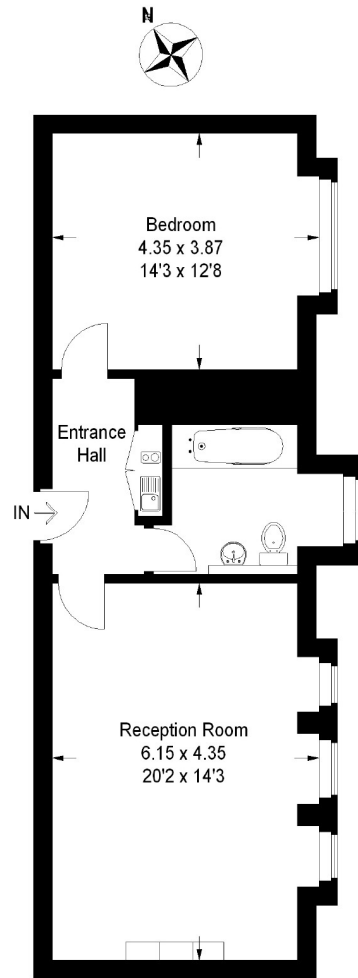

Fifth Floor

Illustration for identification purposes only, measurements are approximate, not to scale.
FloorplansUsketch.com © 2014 (ID91826)

We aim to make our particulars both accurate and reliable. However they are not guaranteed; nor do they form part of an offer or contract. If you require clarification on any points then please contact us, especially if you're traveling some distance to view. Please note that appliances and heating systems have not been tested and therefore no warranties can be given as to their working order. Energy Rating: C



Located near the amenities of Piccadilly, it is also within easy reach of Mayfair's world renowned shops and restaurants.

FEATURES

- South Facing Reception Room
- Large Double Bedroom
- Separate Kitchen
- Lift Access
- Porter
- Excellent Location

Price: £675 Per week



WETHERELL
MAYFAIR'S FINEST PROPERTIES

102 Mount Street • London • W1K 2TH
T: 020 7529 5588 E: rentals@wetherell.co.uk
wetherell.co.uk

NO ONE KNOWS MAYFAIR BETTER THAN WETHERELL