



GROSVENOR STREET

MAYFAIR W1K



A ONE BEDROOM APARTMENT SET WITHIN THIS PURPOSE BUILT RED BRICK MANSION BLOCK WITH LIFT AND PORTER. THE PROPERTY HAS A SEPARATE KITCHEN, BUILT-IN STORAGE AND WOODEN FLOORING IN THE BEDROOM.

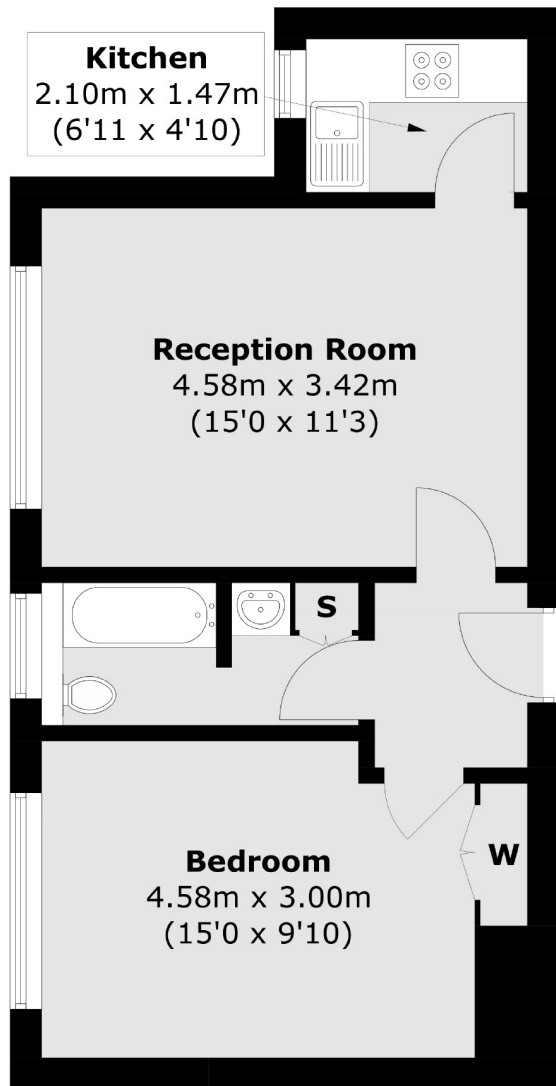

Third Floor

Total area (approx.): 40.5 sq. m (435.9 sq. ft)

We aim to make our particulars both accurate and reliable. However they are not guaranteed; nor do they form part of an offer or contract. If you require clarification on any points then please contact us, especially if you're traveling some distance to view. Please note that appliances and heating systems have not been tested and therefore no warranties can be given as to their working order. Energy Rating: E



The property is ideally situated close to Bond Street station and close to Oxford Street and Grosvenor Square.

FEATURES

- Spacious Double Bedroom
- Porter
- Lift Access
- Built-In Storage
- Open Plan Kitchen
- Excellent Location

Price: £625 Per week



WETHERELL

MAYFAIR'S FINEST PROPERTIES

102 Mount Street • London • W1K 2TH
T: 020 7529 5588 E: rentals@wetherell.co.uk

wetherell.co.uk

NO ONE KNOWS MAYFAIR BETTER THAN WETHERELL