



WETHERELL
MAYFAIR'S FINEST PROPERTIES



BERKELEY STREET, W1J

£1,500,000

Located next to Berkeley Square, an immaculate two bedroom apartment in an attractive building with porter, lift access and a long lease.

Situated on the fifth floor of a purpose built block, this lateral apartment of 748 sq ft has impressive ceiling heights and is finished to a high standard throughout. Upon entry, the hallway draws you to the 24ft wide reception room with two large sash windows and dark wood flooring.

The two bedrooms are neatly positioned either side of the hallway, both with built-in wardrobes and plush carpeting. There is a separate, modern kitchen and a shower room. Savile House has a day porter and lift.

Berkeley Street connects Piccadilly with one of Mayfair's premier garden squares allowing immediate access to both the open green spaces of Green Park and Berkeley Square.

THE LOCATION OFFERS A LARGE SELECTION OF MICHELIN STARRED RESTAURANTS, FINE ART HOUSES AND SOME OF THE VERY BEST BOUTIQUE STORES IN LONDON. GREEN PARK IS THE NEAREST UNDERGROUND STATION.



FEATURES

- Two Bedrooms • Bathroom • 24 ft Wide Reception Room • Porter • Lift • Long Lease •



BERKELEY STREET,
LONDON, W1J

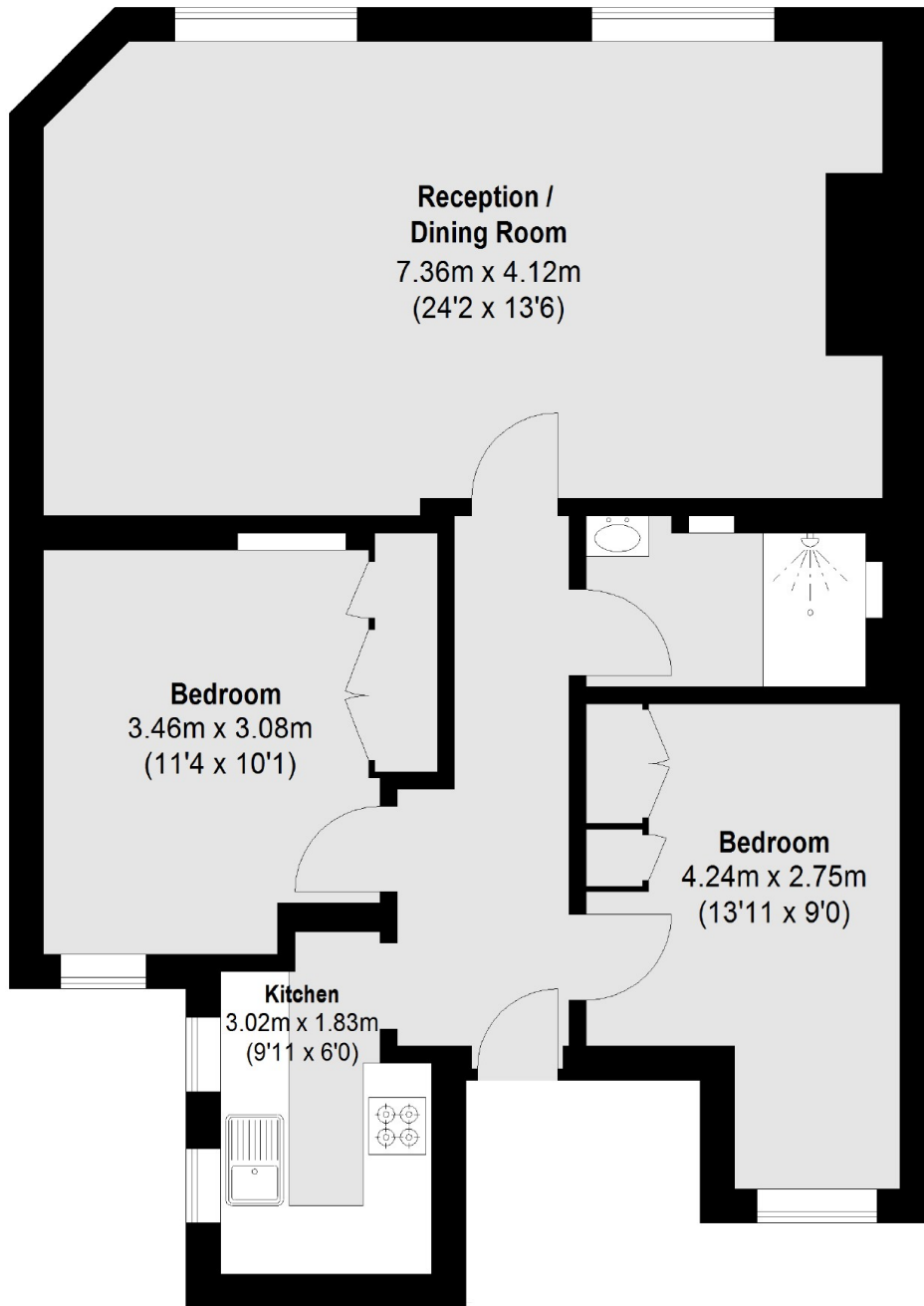

Total area (approx.): 69.53 sq. m (748 Sq. ft)