



# CHESTERFIELD GARDENS

## MAYFAIR W1J



A RECENTLY REFURBISHED ONE BEDROOM, ONE BATHROOM APARTMENT  
LOCATED WITHIN A PERIOD RED BRICK BUILDING WITH LIFT ACCESS.

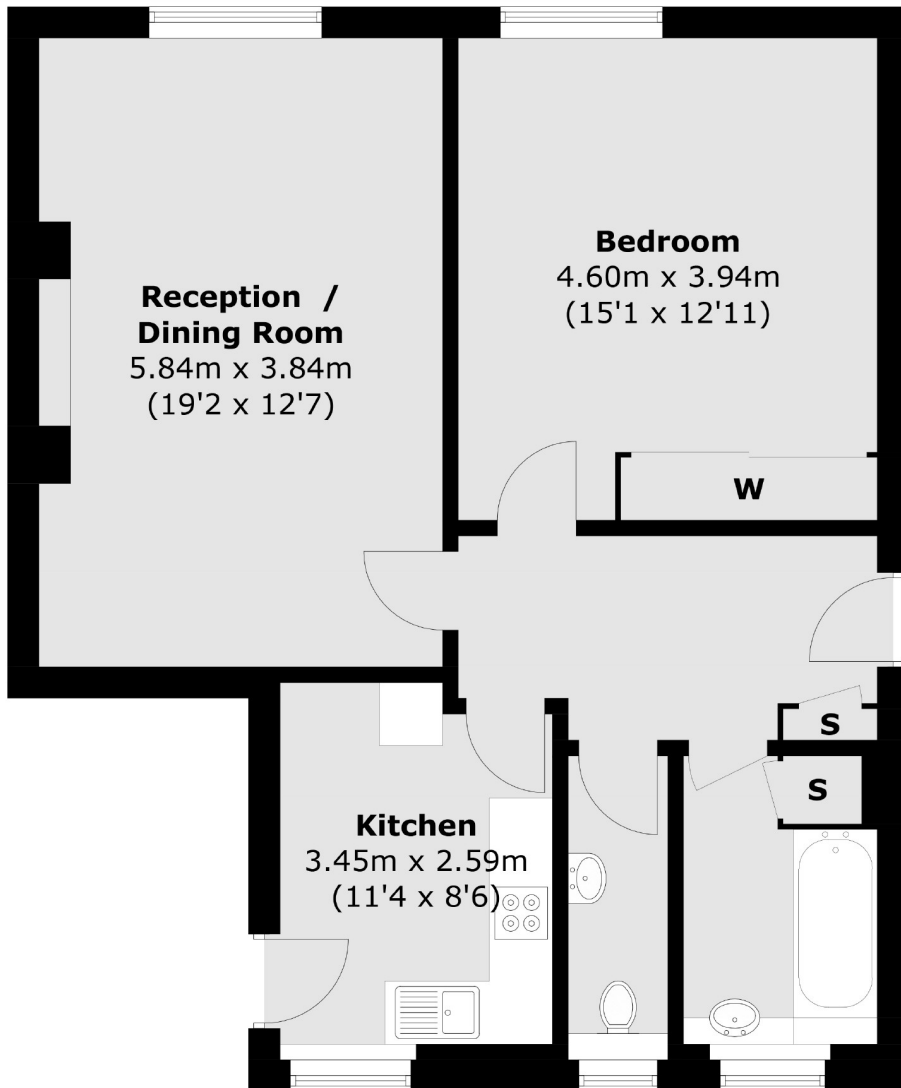

### Fourth Floor

Total area (approx.): 67.6 sq. m (728.0 sq. ft)

We aim to make our particulars both accurate and reliable. However they are not guaranteed; nor do they form part of an offer or contract. If you require clarification on any points then please contact us, especially if you're traveling some distance to view. Please note that appliances and heating systems have not been tested and therefore no warranties can be given as to their working order. Energy Rating: C



Chesterfield House is ideally located on Chesterfield Gardens, close to the open spaces of both Hyde Park and Green Park.

#### FEATURES

- Spacious Double Bedroom
- 24-Hour Porter
- Red Brick Building
- Recently Refurbished
- Excellent Location
- Lift Access

Price: £690 Per week



# WETHERELL

MAYFAIR'S FINEST PROPERTIES

102 Mount Street • London • W1K 2TH  
T: 020 7529 5588 E: rentals@wetherell.co.uk

wetherell.co.uk

NO ONE KNOWS MAYFAIR BETTER THAN WETHERELL