



- Retirement Apartment
- One Bedroom
- Lounge/Dining Area
- Bathroom
- Communal Gardens
- Parking
- Over 55's
- Sold As A 70% Share

29 Rutland Court Kennerley Road
Stockport, SK2 6EU

£80,500

A top floor one bedroom over 55's retirement apartment, located on this popular development. Being sold as a 70% this second floor apartment comprises of a communal entrance hall with lift to all floor, entrance hall, lounge/dining area, kitchen and bathroom with walk in shower. Externally there is well maintained communal gardens and parking. No onward chain. Service charge £186.64 PCM. Lease 99 years.

Ground Floor

Communal Entrance

Stairs and lift to all floors.

Entrance Hallway 10' 6" x 6' 2" (3.20m x 1.88m)

Radiator, storage cupboard, laminate flooring.

Lounge 18' 0" x 10' 0" (5.48m x 3.05m)

Two radiators, window to rear.

Kitchen 7' 9" x 7' 1" (2.36m x 2.16m)

A range of units incorporating a sink and drainer, space for cooker and fridge freezer, window to rear.

Bedroom 12' 4" x 10' 2" (3.76m x 3.10m)

Built in wardrobes, radiator, access to left area, window to the rear.

Bathroom 7' 4" x 5' 6" (2.23m x 1.68m)

Low level WC, wash basin, walk in shower, towel radiator, tiled walls.

External

Externally there is well maintained communal gardens and parking.





Second Floor

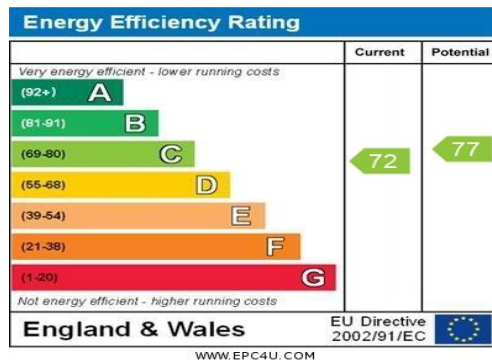
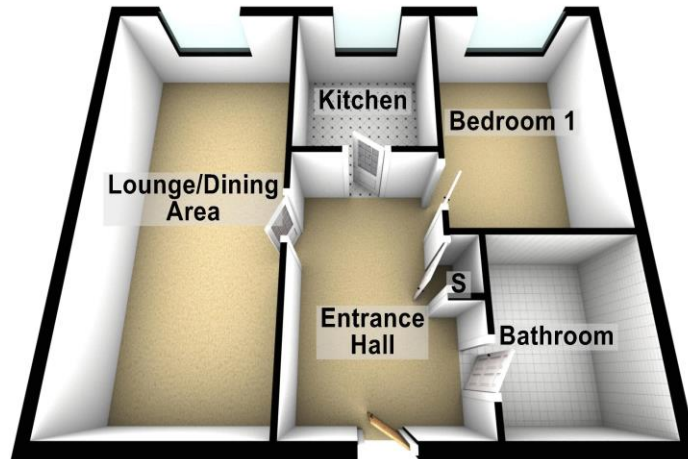

Tenure: We have been advised by the vendor that the property is tbc (please note that details of the tenure should be confirmed by any prospective purchasers solicitor).

Services: All main services are understood to be connected to the property. No services or appliances have been tested.

Agents Notes: We endeavor to make all our descriptions and dimensions as accurate as possible, however their accuracy is not guaranteed.

Property Misdescriptions Act 1991: These details do not form part of any contract. They have been produced in good faith and are intended to be a general guide to the property. None of the statements in this document are to be taken as fact and any intending purchasers are to satisfy themselves by inspections or otherwise as to the correctness of statements in these details.

No person in the employment of this company has the authority to make or give any representation or warranty in relation to this property.

Make Your Move

Plumlife Move, Armitt House, Monmouth Road, Cheadle Hulme, Stockport, SK8 7EF

Tel: 0161 486 7700 Fax: 0161 485 5858 Email: move@plumlife.co.uk

www.plumlifemove.co.uk