



- One Bedroom Bungalow
- Lounge/Dining Area
- Kitchen
- Bathroom
- Double Bedroom
- Designated Parking
- Over 55's Or Disabled
- Sold As A 35% Share

91 Hawthorn Road
Clitheroe, BB7 9ER

£52,500

A rare opportunity to purchase this one double bedroom bungalow, ideally located for Barrow and Clitheroe town centre. For anyone who is over 55 or has a disability, this 35% shared ownership property comprises of an entrance hall, lounge/dining area, kitchen, double bedroom and a bathroom. Externally there is a designated parking space, plus additional visitors spaces. The property also benefits from enjoying an open aspect over farm land. Rent, Management charge and insurance £263.28 PCM. Lease 246 years. N.B. Local connection restriction applies.

Ground Floor

Entrance Hall 10' 0" x 4' 8" (3.05m x 1.42m)

Radiator, storage cupboard.

Lounge/Dining Area 19' 1" x 11' 5" (5.81m x 3.48m)

Radiator, opening to kitchen, window to rear.



Kitchen 9' 7" x 6' 5" (2.92m x 1.95m)

Base and eye level units incorporating a sink and drainer, gas hob with extractor over, oven, built in fridge freezer, space for washing machine, spotlighting, window to front.



Double Bedroom 16' 5" x 9' 2" (5.00m x 2.79m)

Radiator, window to rear.

Bathroom 7' 6" x 6' 0" (2.28m x 1.83m)

Low level WC, wash basin, panelled bath with shower over, part tiled walls, towel radiator, spot lighting, window to front.



External

Externally there is a designated parking space, plus additional visitors spaces. The property also benefits from enjoying an open aspect over farm land.



Ground Floor

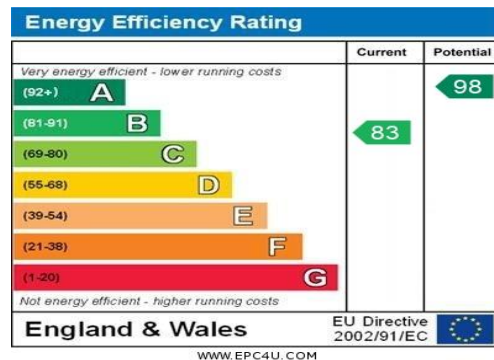
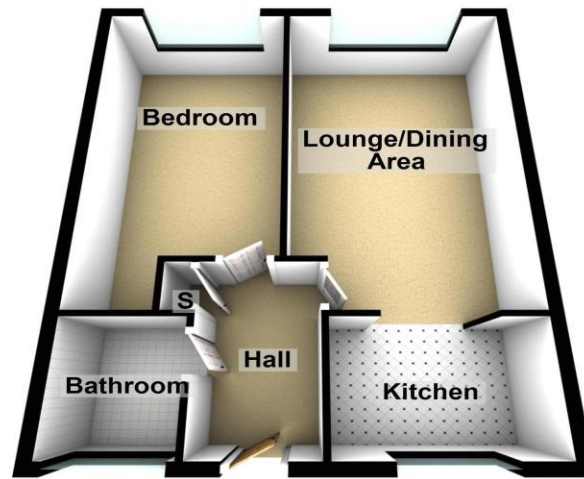

Tenure: We have been advised by the vendor that the property is tbc (please note that details of the tenure should be confirmed by any prospective purchasers solicitor).

Services: All main services are understood to be connected to the property. No services or appliances have been tested.

Agents Notes: We endeavor to make all our descriptions and dimensions as accurate as possible, however their accuracy is not guaranteed.

Property Misdescriptions Act 1991: These details do not form part of any contract. They have been produced in good faith and are intended to be a general guide to the property. None of the statements in this document are to be taken as fact and any intending purchasers are to satisfy themselves by inspections or otherwise as to the correctness of statements in these details.

No person in the employment of this company has the authority to make or give any representation or warranty in relation to this property.

Make Your Move

Plumlife Move, Armitt House, Monmouth Road, Cheadle Hulme, Stockport, SK8 7EF

Tel: 0161 486 7700 Fax: 0161 485 5858 Email: move@plumlife.co.uk

www.plumlifemove.co.uk