



- Maisonette Retirement Apartment
- Over 55's
- First Floor
- Lounge & Kitchen
- Two Double Bedrooms & Bathroom
- Communal Gardens & Parking
- No Onward Chain
- Sold As A 75% Share

4 Ash Close  
Stockport, SK2 7QR

£120,000

**CASH BUYERS ONLY !!!!** A two bedroom retirement apartment for the over 55's, situated at the end of a quiet cul-de-sac. on this popular development. Being sold as a 75% share, this first floor maisonette apartment comprises of an entrance hall, lounge, kitchen, two double bedrooms and a bathroom. Externally the property boasts well kept communal gardens to the front and rear, enclosed bin store and ample communal parking. No pets allowed. No onward chain. Service charge £104.56 PCM. No rent payable. Lease 74 years.

### Ground Floor

**Entrance Hall** 7' 4" x 3' 2" (2.23m x 0.96m)

Stairs to first floor.

### First Floor

#### Lounge

**Lounge** 13' 4" x 11' 1" (4.06m x 3.38m)

Radiator, window to front.



**Kitchen** 13' 2" x 8' 0" (4.01m x 2.44m)

Base and eye level units incorporating sink and drainer, space for gas cooker and washing machine, radiator, window to front.



**Bedroom One** 14' 9" x 9' 5" (4.49m x 2.87m)

Radiator, window to rear.

**Bedroom Two** 11' 0" x 9' 6" (3.35m x 2.89m)

Radiator, window to rear.

**Bathroom** 7' 1" x 5' 9" (2.16m x 1.75m)

Low level WC, wash basin, panelled bath with shower over, radiator, part tiled walls.



### External

Externally the property boasts well kept communal gardens to the front and rear, enclosed bin store and ample communal parking.



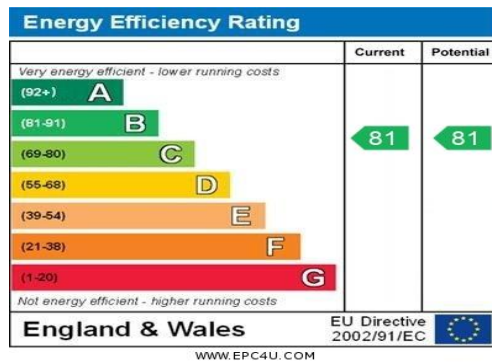
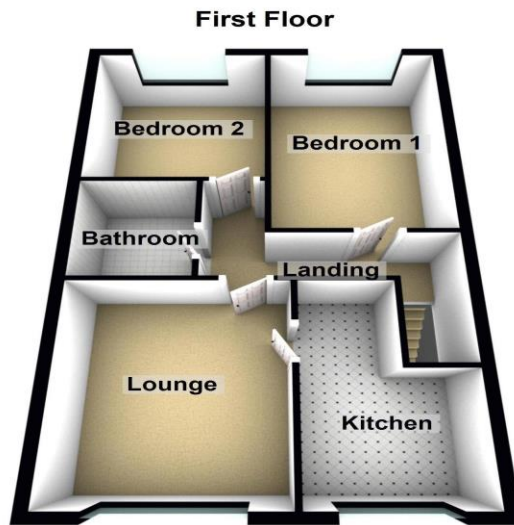

**Tenure:** We have been advised by the vendor that the property is tbc (please note that details of the tenure should be confirmed by any prospective purchasers solicitor).

**Services:** All main services are understood to be connected to the property. No services or appliances have been tested.

**Agents Notes:** We endeavor to make all our descriptions and dimensions as accurate as possible, however their accuracy is not guaranteed.

**Property Misdescriptions Act 1991:** These details do not form part of any contract. They have been produced in good faith and are intended to be a general guide to the property. None of the statements in this document are to be taken as fact and any intending purchasers are to satisfy themselves by inspections or otherwise as to the correctness of statements in these details.

No person in the employment of this company has the authority to make or give any representation or warranty in relation to this property.

*Make Your Move*

Plumlife Move, Armitt House, Monmouth Road, Cheadle Hulme, Stockport, SK8 7EF

Tel: 0161 486 7700 Fax: 0161 485 5858 Email: [move@plumlife.co.uk](mailto:move@plumlife.co.uk)

[www.plumlifemove.co.uk](http://www.plumlifemove.co.uk)