



- Two Bedroom Apartment
- First Floor
- Lounge
- Kitchen
- Bathroom
- Parking
- Communal Gardens
- Sold As A 50% Share

Flat 8, Howbeck Court Bidston Road
Prenton, CH43 6UJ

£67,500

A first floor, two bedroom apartment located in this popular development, close to Oxtton and Claughton village. Being sold as a 50% share, the accommodation comprises of an communal entrance hall, private entrance, lounge, kitchen, two bedrooms and a bathroom. Externally there is parking and communal gardens. Rent and management charges £237.14 PCM.

Ground Floor

Communal entrance hall, stairs to all floors.

Entrance Hall 10' 0" x 4' 5" (3.05m x 1.35m)

Radiator, laminate flooring, two storage cupboards, entry phone system.

Lounge 14' 11" x 14' 0" (4.54m x 4.26m)

Radiator, laminate flooring, windows to rear.

Kitchen 9' 1" x 8' 2" (2.77m x 2.49m)

Fitted with a range of base and eye level units, sink and drainer, gas hob, oven, space for washing machine, fridge freezer and tumble dryer, laminate flooring, window to rear.

Bedroom One 12' 2" x 8' 10" (3.71m x 2.69m)

Radiator, laminate flooring, window to front.

Bedroom Two 8' 10" x 6' 7" (2.69m x 2.01m)

Radiator, laminate flooring, window to front.

Bathroom 8' 2" x 5' 6" (2.49m x 1.68m)

Suite comprising of a low level WC, wash basin, panelled bath with shower over, tiled flooring, part tiled walls, towel radiator.

Externally

Externally there is parking and communal gardens.





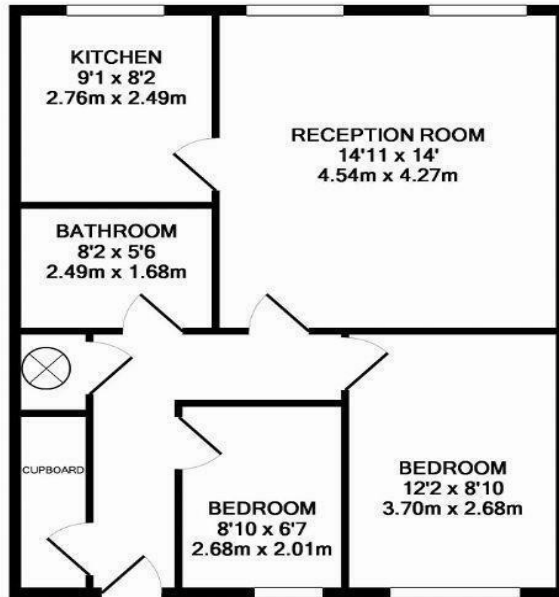

TOTAL APPROX. FLOOR AREA 600 SQ.FT. (55.7 SQ.M.)

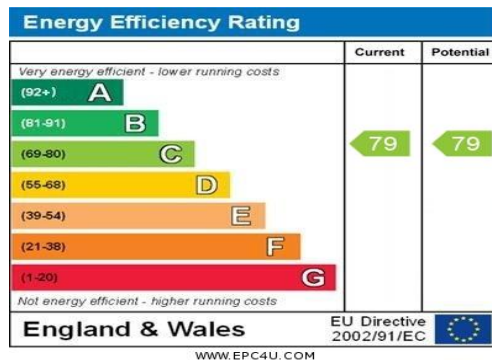

Tenure: We have been advised by the vendor that the property is tbc (please note that details of the tenure should be confirmed by any prospective purchasers solicitor).

Services: All main services are understood to be connected to the property. No services or appliances have been tested.

Agents Notes: We endeavor to make all our descriptions and dimensions as accurate as possible, however their accuracy is not guaranteed.

Property Misdescriptions Act 1991: These details do not form part of any contract. They have been produced in good faith and are intended to be a general guide to the property. None of the statements in this document are to be taken as fact and any intending purchasers are to satisfy themselves by inspections or otherwise as to the correctness of statements in these details. No person in the employment of this company has the authority to make or give any representation or warranty in relation to this property.

Make Your Move

Plumlife Move, Armitt House, Monmouth Road, Cheadle Hulme, Stockport, SK8 7EF

Tel: 0161 486 7700 Fax: 0161 485 5858 Email: move@plumlife.co.uk

www.plumlifemove.co.uk