

EMBASSY

LETTINGS & MANAGEMENT



67 Milton Road, Cambridge, CB4 1XA

£1,850 Per month

Spacious 2 Bedroom Flat/Apartment centrally located, just to the North of the Centre of Cambridge.

The Building is split into 3 Apartments, one on each floor. This Apartment is located on the First Floor.

The Entrance Hallway runs through the centre of the Apartment, to the left is a utility cupboard with washer/dryer and storage cupboard

To the right is the Master Bedroom furnished with a large double bed and Pine Wardrobe and Drawer Units

Further down the Hallway to the left is a Large Bathroom with separate Bath and Large Shower cubicle. and heated towel rail.



Floor Plan

Flat 2, 67 Milton Road, Cambridge

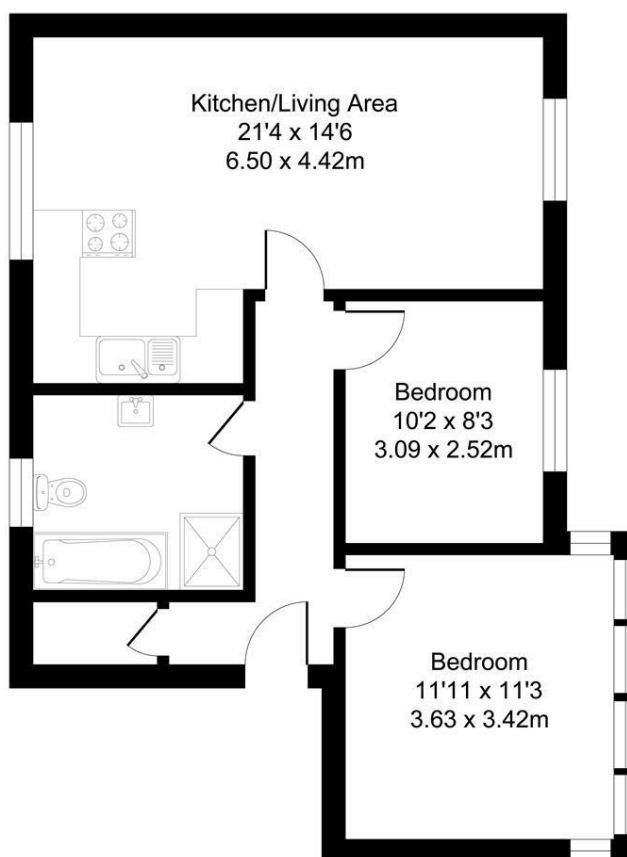

Total Area: 60.7 m² ... 654 ft²

All Measurements are approximate and for display purposes only

Area Map

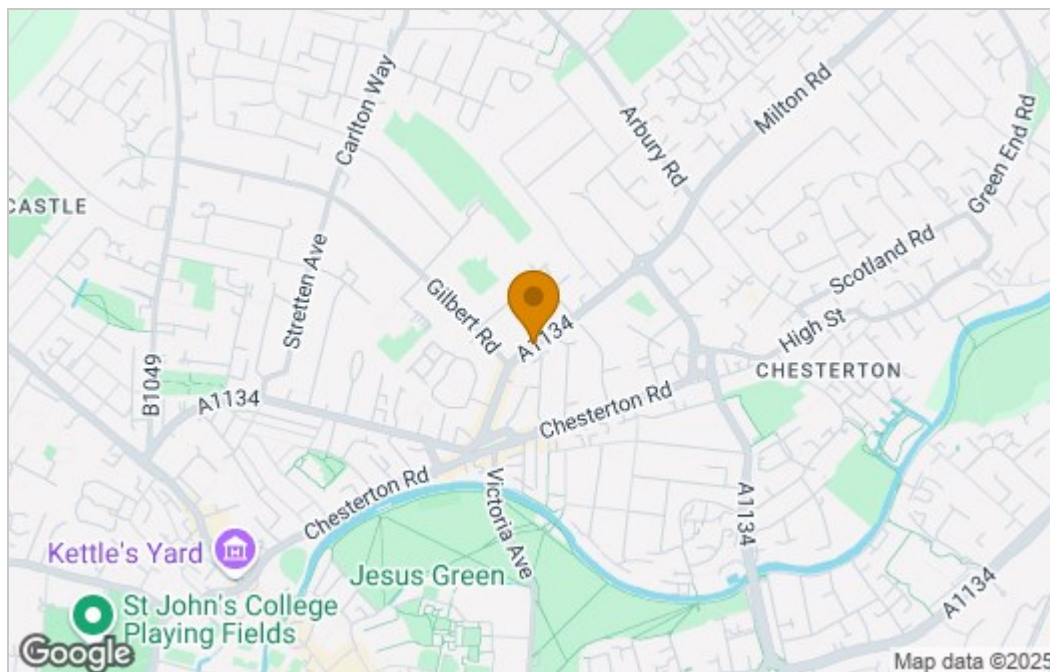

Energy Efficiency Graph

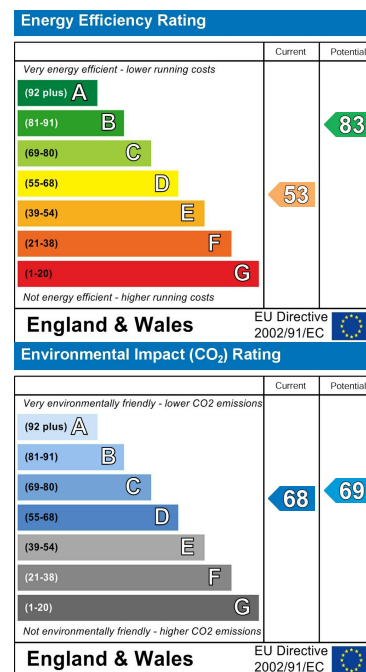

These particulars, whilst believed to be accurate are set out as a general outline only for guidance and do not constitute any part of an offer or contract. Intending purchasers should not rely on them as statements of representation of fact, but must satisfy themselves by inspection or otherwise as to their accuracy. No person in this firm's employment has the authority to make or give any representation or warranty in respect of the property.

27 Franks Lane, Cambridge, CB4 1RR

Tel: 01223 721598 Email: info@embassylettings.co.uk www.embassylettings.co.uk