



## 30 Cypress Gardens, Gloucester, GL2 0RB

£1,300 Per Calendar Month

We are pleased to present this three bedroom home located in Cypress Gardens, Longlevens available to move in November 2025.

Briefly comprising of: Entrance hall with WC, leading to the modern kitchen with integrated appliances. There is a lounge / diner with under stairs storage with double doors leading out the enclosed garden.

Upstairs there are three bedrooms, the main benefiting from a walk in wardrobe and finally a family bathroom with shower over bath.

The property further benefits from off road parking and a garage.

- Three Bedrooms
- Modern Throughout
- Kitchen with Integrated Appliances
- Master Bedroom with Walk in Wardrobe
- Private Enclosed Garden
- Garage and Parking

Approx Gross Internal Area  
66 sq m / 711 sq ft

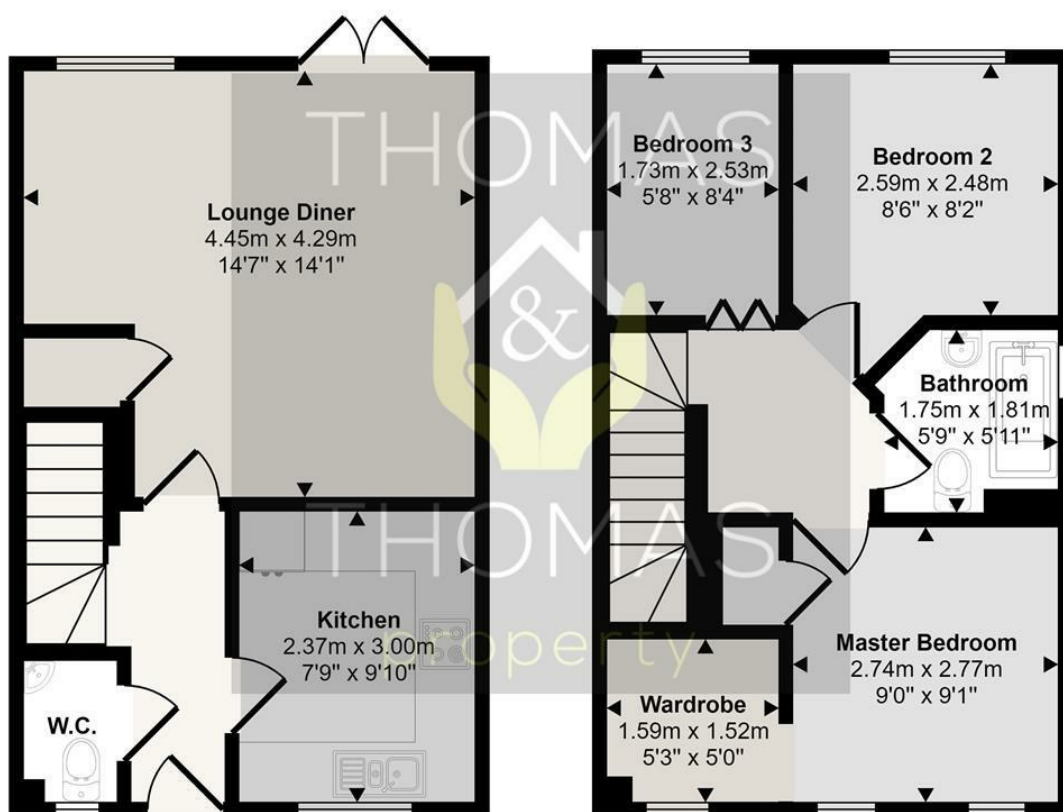

This floorplan is only for illustrative purposes and is not to scale. Measurements of rooms, doors, windows, and any items are approximate and no responsibility is taken for any error, omission or mis-statement. Icons of items such as bathroom suites are representations only and may not look like the real items. Made with Made Snappy 360.

Energy Efficiency Rating		
	Current	Potential
Very energy efficient - lower running costs		
(92 plus) <b>A</b>		
(81-91) <b>B</b>		
(69-80) <b>C</b>		
(55-68) <b>D</b>		
(39-54) <b>E</b>		
(21-38) <b>F</b>		
(1-20) <b>G</b>		
Not energy efficient - higher running costs		
<b>England &amp; Wales</b>		
	EU Directive 2002/91/EC	

Environmental Impact (CO <sub>2</sub> ) Rating		
	Current	Potential
Very environmentally friendly - lower CO <sub>2</sub> emissions		
(92 plus) <b>A</b>		
(81-91) <b>B</b>		
(69-80) <b>C</b>		
(55-68) <b>D</b>		
(39-54) <b>E</b>		
(21-38) <b>F</b>		
(1-20) <b>G</b>		
Not environmentally friendly - higher CO <sub>2</sub> emissions		
<b>England &amp; Wales</b>		
	EU Directive 2002/91/EC	

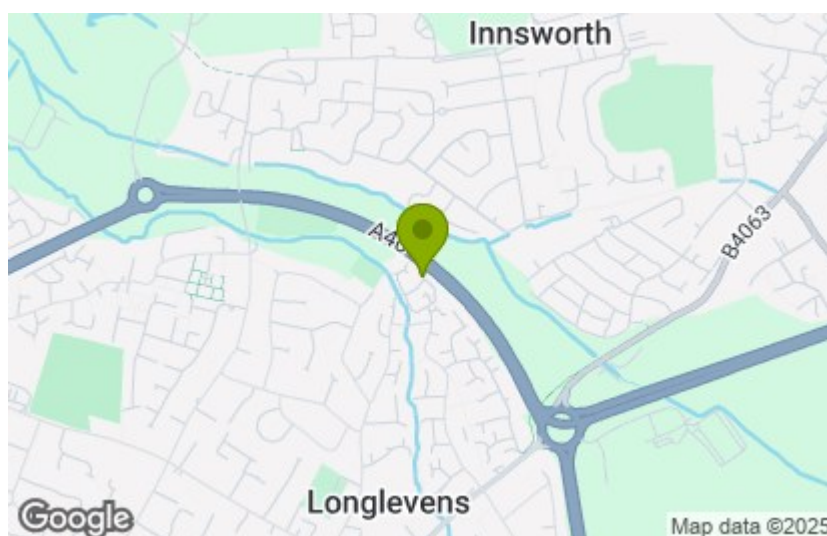

These particulars, whilst believed to be accurate are set out as a general outline only for guidance and do not constitute any part of an offer or contract. Intending purchasers should not rely on them as statements of representation of fact, but must satisfy themselves by inspection or otherwise as to their accuracy. No person in this firm's employment has the authority to make or give any representation or warranty in respect of the property.

[www.thomasproperty.co.uk](http://www.thomasproperty.co.uk)