



**21 Tidswell Close, Gloucester, GL2 4UZ**

**Offers Over £200,000**

Positioned in a quiet cul-de-sac in Quedgeley is this well presented two double bedroom property. The accommodation briefly comprises: Entrance Hall, kitchen, large storage cupboard, lounge with French doors leading onto the lovely rear garden. Upstairs offers two double bedrooms and a modern fitted bathroom with shower over bath.

Further benefits are driveway parking for two cars. UPVC double glazed windows. GSC.

Available with no onward chain

- Two Double Bedrooms
  - Well Presented
- Driveway Parking
  - Quedgeley
- Enclosed Garden
  - Chain Free



Approx Gross Internal Area  
58 sq m / 620 sq ft

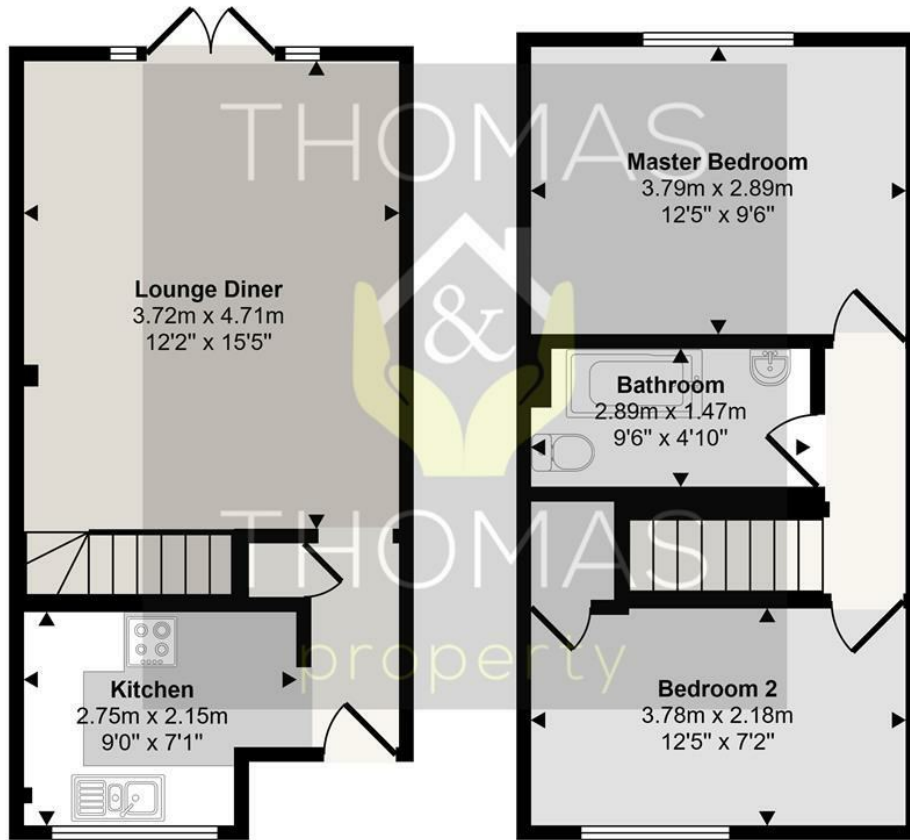

Ground Floor  
Approx 28 sq m / 299 sq ft

First Floor  
Approx 30 sq m / 321 sq ft

This floorplan is only for illustrative purposes and is not to scale. Measurements of rooms, doors, windows, and any items are approximate and no responsibility is taken for any error, omission or mis-statement. Icons of items such as bathroom suites are representations only and may not look like the real items. Made with Made Snappy 360.

Energy Efficiency Rating		
	Current	Potential
Very energy efficient - lower running costs		
(92 plus) <b>A</b>		89
(81-91) <b>B</b>		
(69-80) <b>C</b>		
(55-68) <b>D</b>		
(39-54) <b>E</b>		
(21-38) <b>F</b>		
(1-20) <b>G</b>		
Not energy efficient - higher running costs		
England & Wales	EU Directive 2002/91/EC	EU Directive 2002/91/EC

Environmental Impact (CO <sub>2</sub> ) Rating		
	Current	Potential
Very environmentally friendly - lower CO <sub>2</sub> emissions		
(92 plus) <b>A</b>		
(81-91) <b>B</b>		
(69-80) <b>C</b>		
(55-68) <b>D</b>		
(39-54) <b>E</b>		
(21-38) <b>F</b>		
(1-20) <b>G</b>		
Not environmentally friendly - higher CO <sub>2</sub> emissions		
England & Wales	EU Directive 2002/91/EC	EU Directive 2002/91/EC

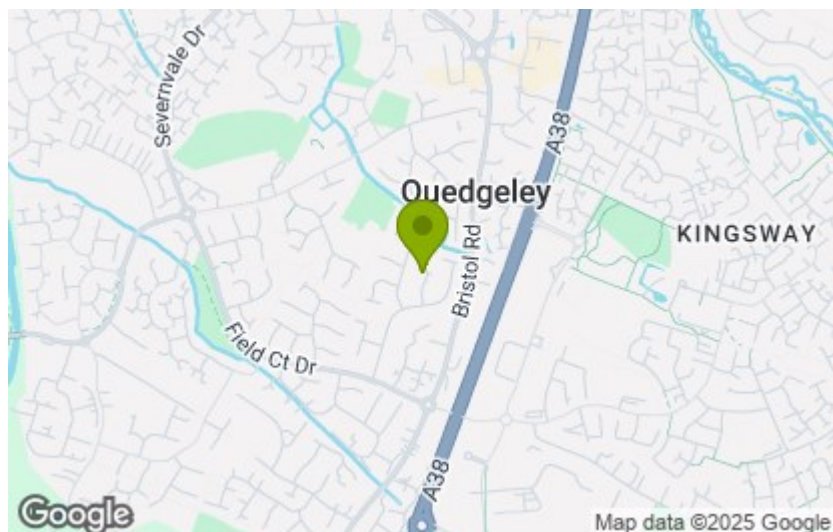

These particulars, whilst believed to be accurate are set out as a general outline only for guidance and do not constitute any part of an offer or contract. Intending purchasers should not rely on them as statements of representation of fact, but must satisfy themselves by inspection or otherwise as to their accuracy. No person in this firm's employment has the authority to make or give any representation or warranty in respect of the property.