



10 Kevin Close, Gloucester, GL4 3JA

£1,800 Per Calendar Month

Thomas and Thomas are pleased to be offering this show home condition three-bedroom semi detached, family home located in the popular Barnwood area.

The property comprises of: living room, impressive open plan kitchen / diner / lounge area with skylight windows and bi-folding doors and finally a downstairs WC. To the first floor is a family bathroom with a shower over bath and three good sized double bedrooms. The property benefits from an impressive wrap around garden, driveway parking and a garage. It is warmed via Gas Central heating.

Available August

- Semi Detached
- Three Double Bedrooms
- Open Plan Kitchen / Diner
 - Large Garden
- Off Road Parking and Garage
 - Available August

Approx Gross Internal Area
155 sq m / 1671 sq ft

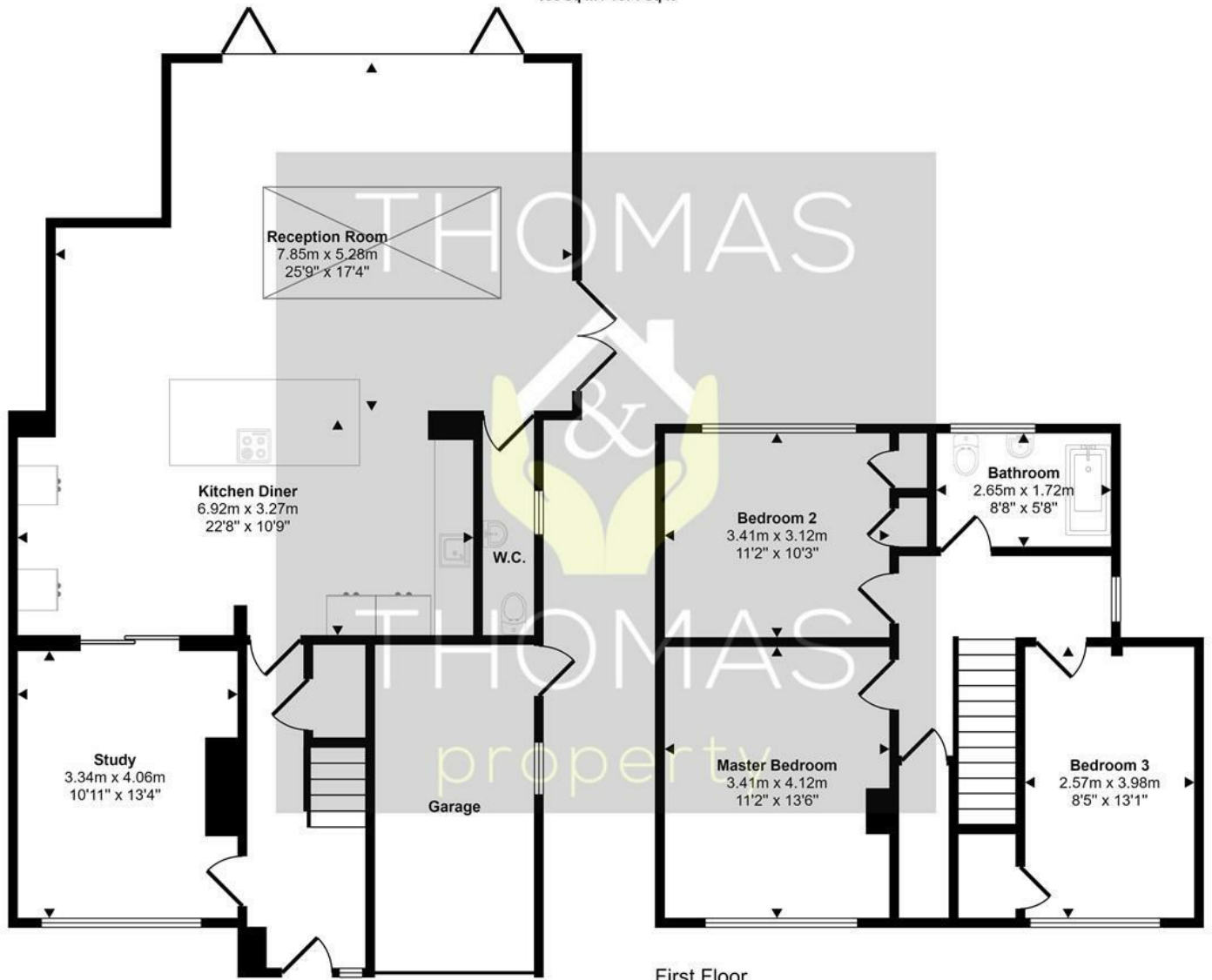

First Floor
Approx 55 sq m / 589 sq ft

Ground Floor
Approx 100 sq m / 1082 sq ft

This floorplan is only for illustrative purposes and is not to scale. Measurements of rooms, doors, windows, and any items are approximate and no responsibility is taken for any error, omission or mis-statement. Icons of items such as bathroom suites are representations only and may not look like the real items. Made with Made Snappy 360.



Energy Efficiency Rating	
Current	Potential
Very energy efficient - lower running costs	
(92 plus) A	
(81-91) B	
(69-80) C	
(55-68) D	
(39-54) E	
(21-38) F	
(1-20) G	
Not energy efficient - higher running costs	
65	79
EU Directive 2002/91/EC	

Environmental Impact (CO ₂) Rating	
Current	Potential
Very environmentally friendly - lower CO ₂ emissions	
(92 plus) A	
(81-91) B	
(69-80) C	
(55-68) D	
(39-54) E	
(21-38) F	
(1-20) G	
Not environmentally friendly - higher CO ₂ emissions	
EU Directive 2002/91/EC	

These particulars, whilst believed to be accurate are set out as a general outline only for guidance and do not constitute any part of an offer or contract. Intending purchasers should not rely on them as statements of representation of fact, but must satisfy themselves by inspection or otherwise as to their accuracy. No person in this firm's employment has the authority to make or give any representation or warranty in respect of the property.