



1 Hamlet Grove, Gloucester, GL2 9FU
Asking Price £335,000

 **3**  **2**  **1**  **B**

Thomas and Thomas are pleased to present this show home standard home located on the popular Longford estate offering off road parking for two and a garage.

Briefly comprising of: entrance hall leading to the good size living room with double aspect window. To the right is the kitchen diner with integrated dishwasher and ample space for a dining table. The utility space offers space for a washing machine and additional storage and finally a WC.

Upstairs there are three double bedrooms, the main benefiting from an en suite shower room and finally a family bathroom with shower over bath.

Outside there is a private enclosed garden, tandem parking for two cars and a garage.

- Detached
- Three Bedrooms
- En Suite & Family Bathroom
- Utility Room & WC
- Garage & Off Road Parking
- Show Home Standard Throughout

Viewing

Please contact our Thomas & Thomas property Ltd Office on 01452 348208 if you wish to arrange a viewing appointment for this property or require further information.



Approx Gross Internal Area
89 sq m / 960 sq ft

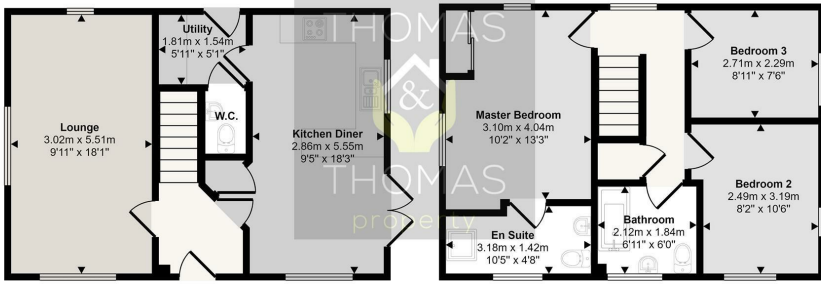

This floorplan is only for illustrative purposes and is not to scale. Measurements of rooms, doors, windows, and any items are approximate and no responsibility is taken for any error, omission or mis-statement. Icons of items such as bathroom suites are representations only and may not look like the real items. Made with Made Snappy 360.



Energy Efficiency Rating

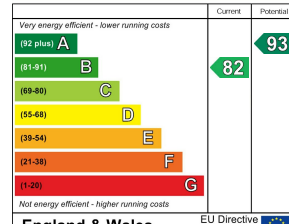

England & Wales EU Directive 2002/91/EC

Environmental Impact (CO₂) Rating

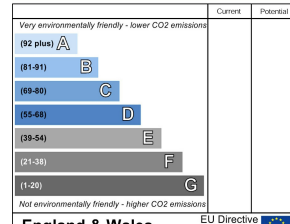

England & Wales EU Directive 2002/91/EC



These particulars, whilst believed to be accurate are set out as a general outline only for guidance and do not constitute any part of an offer or contract. Intending purchasers should not rely on them as statements of representation of fact, but must satisfy themselves by inspection or otherwise as to their accuracy. No person in this firm's employment has the authority to make or give any representation or warranty in respect of the property.