

Parkheath

Sold on Service

Exchange Court WC2R

£575 per week (£2600 pcm) Administration fees apply



A newly decorated one bedroom loft style apartment. Third floor in a purpose built block with concierge.

A bright and airy reception room leading onto a balcony.

A modern kitchen with appliances including a six hob burner.

Sizeable double bedroom with free standing wardrobe.

A contemporary shower room with stylish fixtures and fittings. Ideally located for Covent Garden's vibrant restaurants, bars and shops.

Within walking distance to Charing Cross station and Covent Garden underground station.

Exchange Court

Approximate Gross Internal Area = 51.1 sq m / 550 sq ft

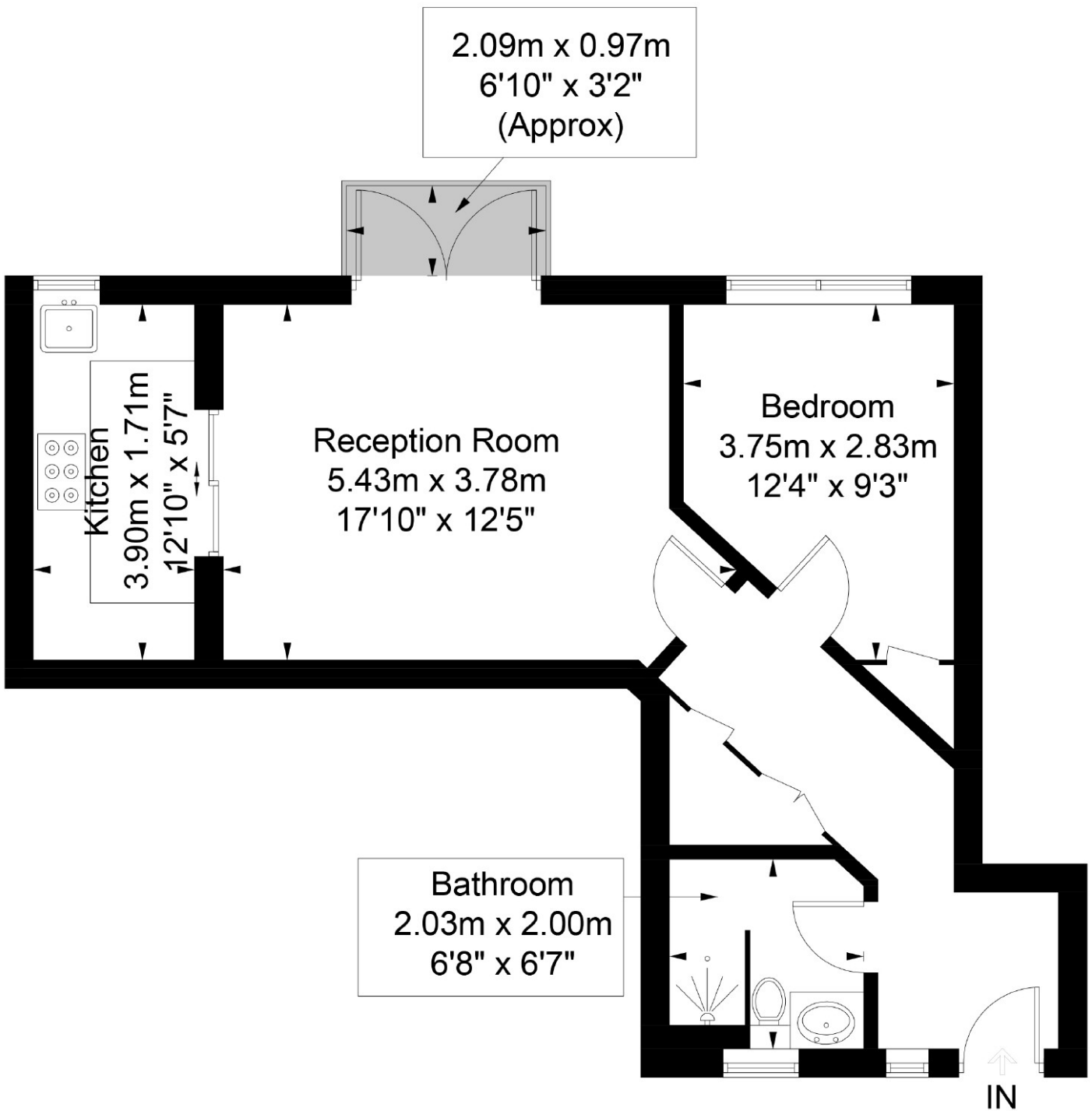

Third Floor

Illustration for identification purposes only, measurements are approximate, not to scale. FloorplansUsketch.com © 2018 (ID483858)
ELLIE CLAIRE PHOTOGRAPHY LTD

Administration fees apply

The particulars do not constitute part of an offer or contract. The particulars, including text, photographs and plans, are for the guidance only of prospective purchasers/tenants and must not be relied upon as statements of fact. The descriptions provided therein represent the opinion of the author and whilst given in good faith should not be construed as statements of fact. Nothing in these particulars shall be deemed a statement that the property is in good condition or otherwise or that any services or facilities are in good working order. All measurements are approximate.