



KNIGHTSBRIDGE  
PRIME PROPERTY



## St John's Wood Park

St John's Wood, NW8 6NJ

£1,300 Per Week



3



3



null



# St John's Wood Park



## Description

Recently Refurbished Three Double Bedroom Apartment - Located in a 24 hour Portered Gated Development in St. John's Wood.

Spanning 1,119 Sq Ft (103.9 Sq Meters) Comprising Three Double Size Bedrooms with Fitted Wardrobes, Three Fully Tiled Bathrooms (All En Suite), A Separate Kitchen And A Spacious Reception room.

Located on the 6th floor of this 24 Hr Portered Gated Development, with parking for residents only. 3 Minutes Walk to Swiss Cottage Station. Short Walk to the many cafes/restaurants and shops of St. John's Wood High Street.

Camden Council  
Tax Band F

- 24 hour portorage within a gated development
- Close proximity to cafes and restaurants of St. John's Wood High street
- Parking within the development
- Air Conditioning
- Spanning 1,119 Sq Ft (103.9 Sq Meters)
- Recently Refurbished
- 3 minutes walking from Swiss Cottage Jubilee line Station
- Fourth Floor (With Lift)
- 10 minutes walking to Primrose Hill







# Floor Plan

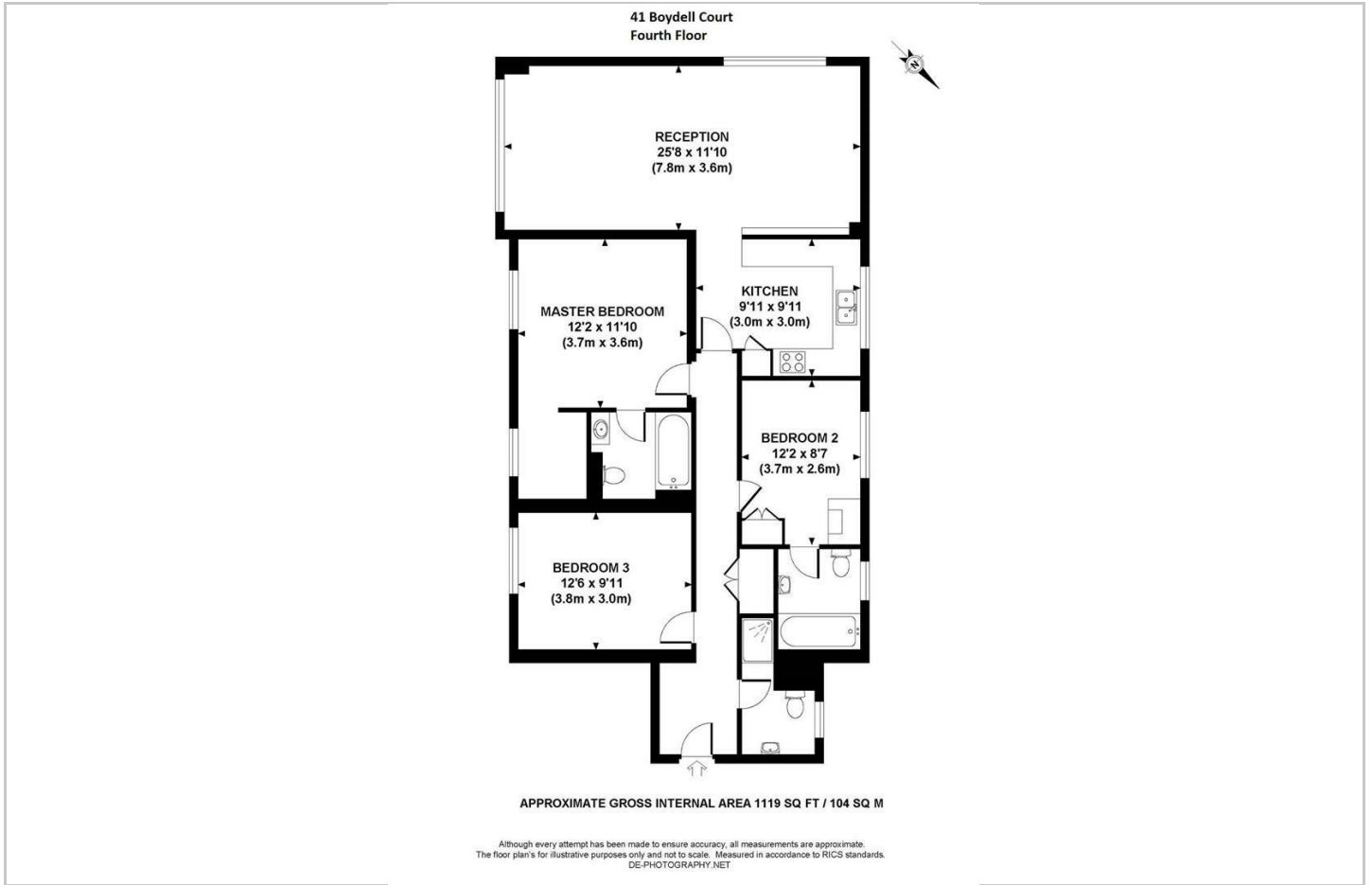

# Area Map

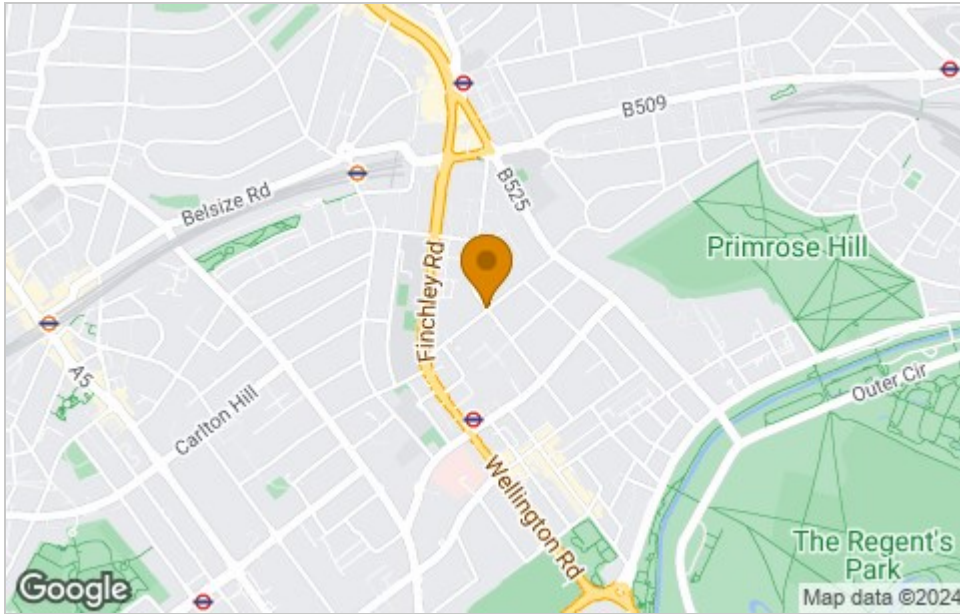

# Viewing

Please contact our Knightsbridge Prime Property Office on 020 3691 6235 if you wish to arrange a viewing appointment for this property or require further information.

These particulars, whilst believed to be accurate are set out as a general outline only for guidance and do not constitute any part of an offer or contract. Intending purchasers should not rely on them as statements of representation of fact, but must satisfy themselves by inspection or otherwise as to their accuracy. No person in this firm's employment has the authority to make or give any representation or warranty in respect of the property.

Knightsbridge Prime Property, 25 North Row, London, W1K 6DJ  
Tel: 020 3691 6235 Email: enquiries@knightsbridgeprimeproperty.com

# Energy Efficiency Graph

