



KNIGHTSBRIDGE
PRIME PROPERTY



Park Street
Mayfair, W1K 6NT
£2,950,000



Park Street



Description

This recently renovated two-bedroom lateral apartment occupies the first floor of an eye-catching red brick building, ideally positioned between Green Street and Oxford Street. <https://www.youtube.com/watch?v=3CoUxssU96s>

Spanning an impressive 1,108 square feet (103 square meters), this residence epitomizes the quintessential pied-à-terre experience.

Tucked away at the back of the building, the residence enjoys a remarkably tranquil view overlooking Red Place.

Inside, the layout comprises a generously proportioned reception room boasting lofty three-meter-high ceilings, a well-appointed kitchen separate from the living area, and a designated bar space, perfect for hosting guests. The property further offers two double bedrooms, including a primary bedroom with its own en-suite bathroom, as well as ample storage solutions throughout.

- 2 Bedroom, 2 Bathrooms
- Extensively Refurbished by Visionnaire
- 3 meter ceiling height
- Digital Automation
- Luxury Bar
- Marble Bathrooms
- Underfloor Heating
- Lift
- Separate Kitchen
- Quiet Overlook





KNIGHTSBRIDGE
PRIME PROPERTY



KNIGHTSBRIDGE
PRIME PROPERTY

Floor Plan

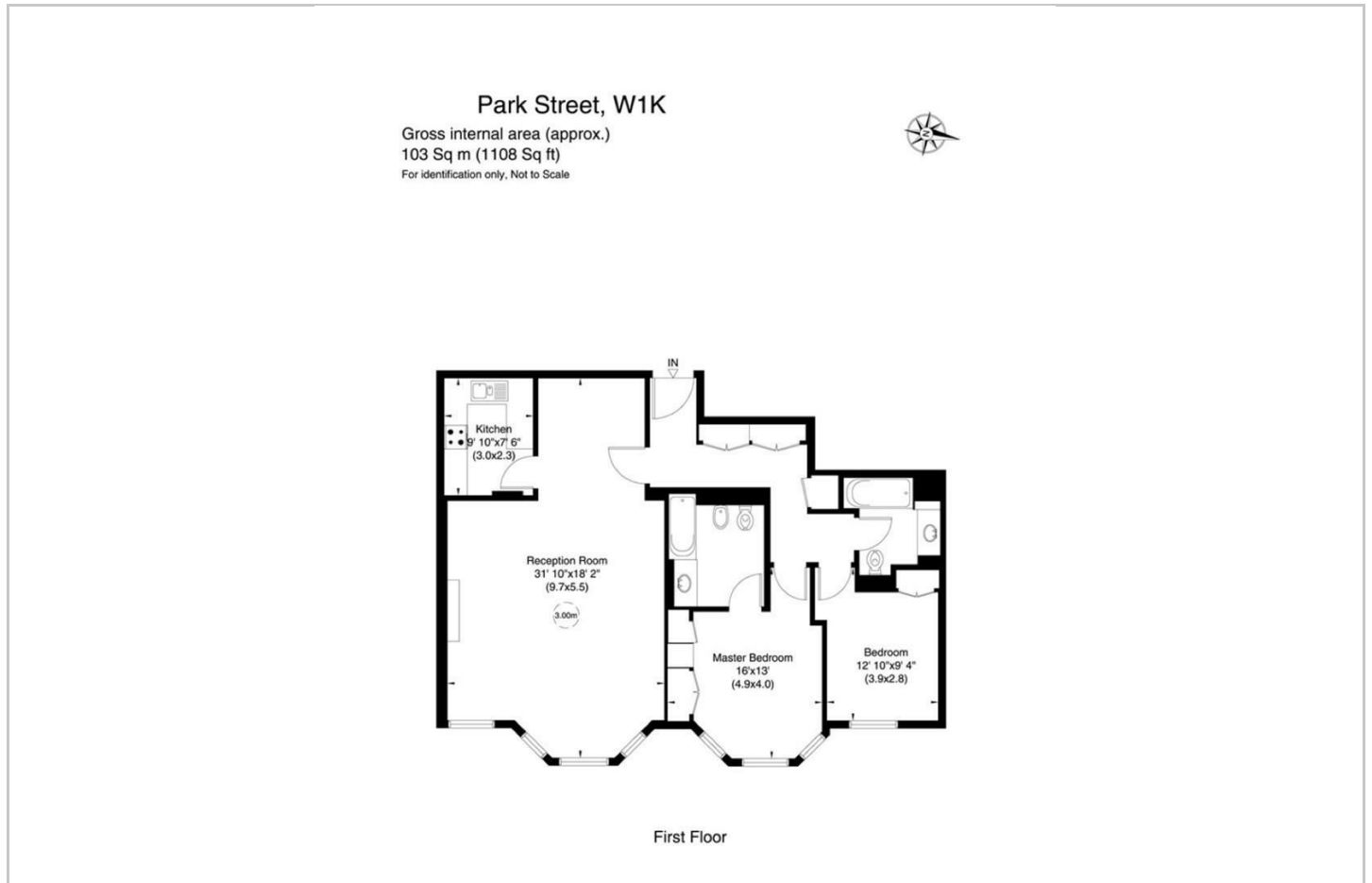

Area Map

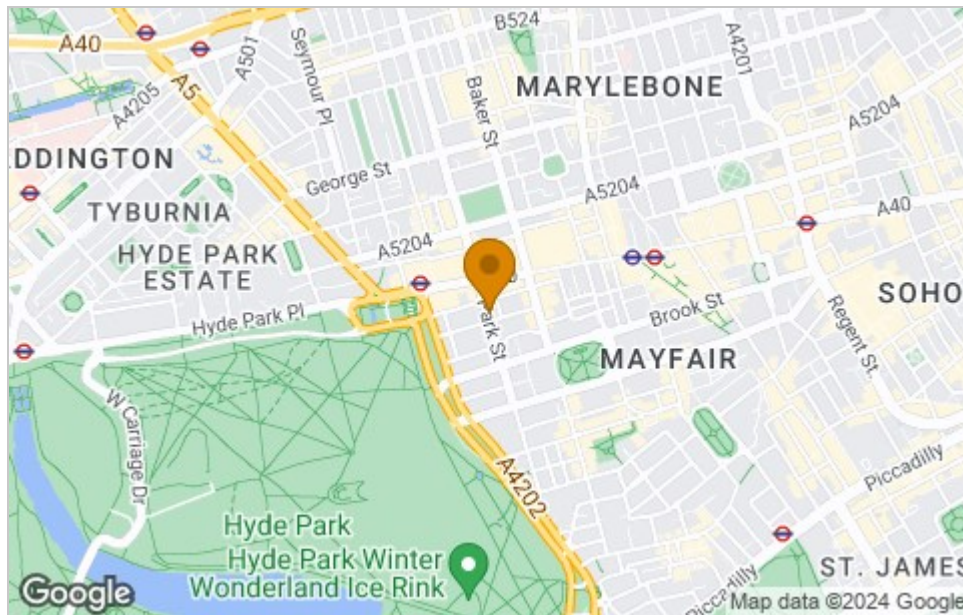

Viewing

Please contact our Knightsbridge Prime Property Office on +44 20 8051 4200 if you wish to arrange a viewing appointment for this property or require further information.

These particulars, whilst believed to be accurate are set out as a general outline only for guidance and do not constitute any part of an offer or contract. Intending purchasers should not rely on them as statements of representation of fact, but must satisfy themselves by inspection or otherwise as to their accuracy. No person in this firm's employment has the authority to make or give any representation or warranty in respect of the property.

Knightsbridge Prime Property, 1 Knightsbridge Green, Knightsbridge, London, SW1X 7QA
Tel: +44 20 8051 4200 Email: enquiries@knightsbridgeprimeproperty.com

Energy Efficiency Graph

