

Asking Price £220,000

Jayman
www.jayman.co.uk

Estate Agents



Winchester Close

Handsacre, WS15 4TP

Winchester Close, Handsacre, WS15 4TP

Jayman offer for sale this well presented two bedroom home on Winchester Close, Handsacre.

Entrance hallway

Leading into the kitchen living room and stairs to the first floor.

Kitchen 9'9" x 6'0" (2.98 x 1.85)

Modern fitted kitchen.

Living room 10'5" x 11'10" (3.19 x 3.63)

Spacious living room with feature fireplace and doors leading to the conservatory.

Conservatory 7'6" x 8'3" (2.31 x 2.52)

Spacious conservatory with doors leading out into the private rear garden.

First floor

From the left, leading into the second bedroom, bathroom and first bedroom.

Bedroom Two 8'10" x 10'5" (2.70 x 3.20)

Double bedroom with fitted wardrobes. Window to the rear of the property.

Bathroom 6'3" x 5'5" (1.91 x 1.66)

With bath and modern shower overhead, WC and hand basin.

Bedroom One 8'7" x 11'10" (2.62 x 3.62)

Double bedroom with a storage cupboard. Window to the front of the property.

Outside

To the front of the property there is a lawned area and driveway for two cars. To the rear of the property there is a private garden with patio and lawn, a shed and side access leading to the front of the property.



REQUIRE A MORTGAGE? Our independent advisor can compare "whole of market" to help find the best mortgage to suit your circumstances. Please call 01543 416 567 for a free mortgage quote including some deals only available through our network. **LEGAL CONVEYANCING** Jayman Conveyancing provides fast efficient low cost legal work with a no sale-no fee guarantee. Call 01543 416 567. **AGENTS DESCRIPTIONS** These details imply the opinion of the agent at the time these details were prepared and are subjective. It may be that the purchaser's opinion differs. **VIEWING ARRANGEMENTS** By appointment only with Jayman on 01543 416 567 **COUNCIL TAX** Please refer to www.voa.gov.uk for this information. **DESCRIPTIONS AND MEASUREMENTS** All measurements are approximate and some may be maximum on irregular walls. The plan shows the approximate layout of the rooms to show the inter relationship of relationship of one room to another but is not necessarily to scale. **CONSENTS** We have not had sight of any relevant building regulations, guarantees or planning consents and all relevant documentation pertaining to this property should be checked by your legal advisor before exchanging contracts.

GROUND FLOOR
347 sq.ft. (32.3 sq.m.) approx.

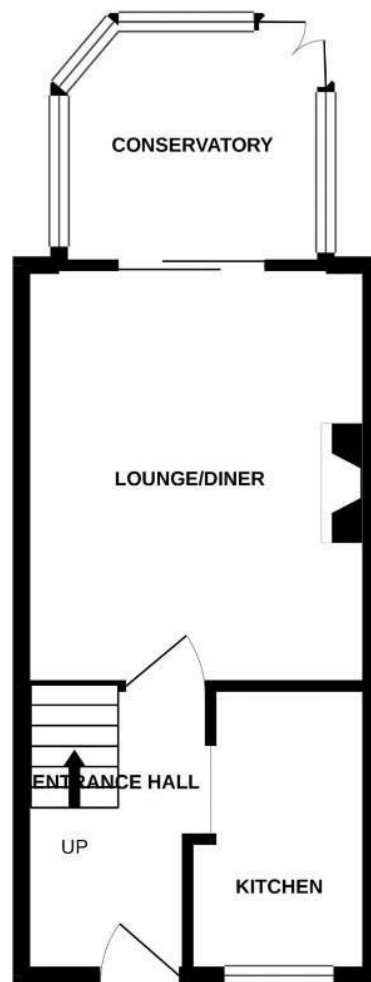

1ST FLOOR
282 sq.ft. (26.2 sq.m.) approx.

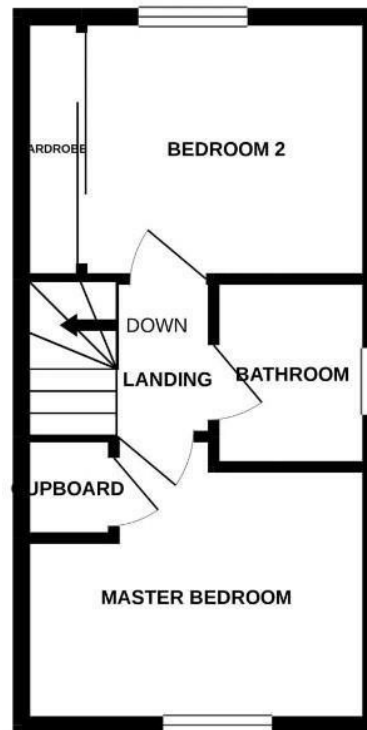

TOTAL FLOOR AREA: 630 sq.ft. (58.5 sq.m.) approx.

Whilst every attempt has been made to ensure the accuracy of the floorplan contained here, measurements of doors, windows, rooms and any other items are approximate and no responsibility is taken for any error, omission or mis-statement. This plan is for illustrative purposes only and should be used as such by any prospective purchaser. The services, systems and appliances shown have not been tested and no guarantee as to their operability or efficiency can be given.
Made with Metreplex ©2023

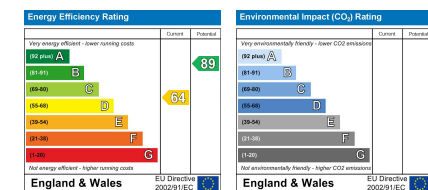
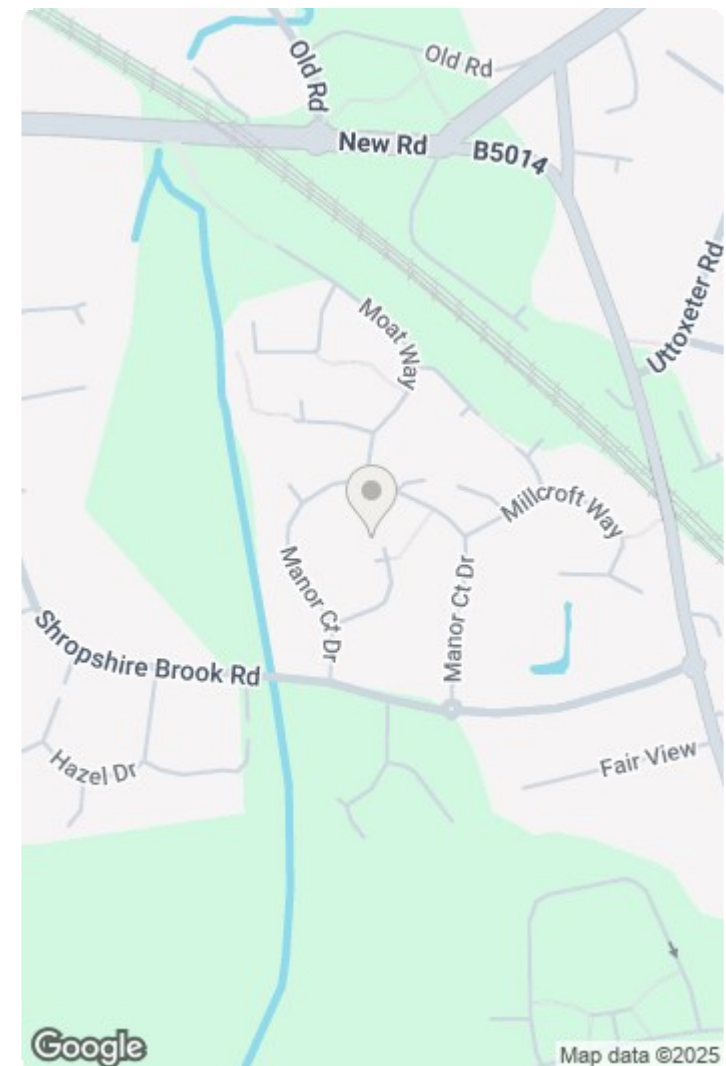

We endeavour to make our sales details accurate and reliable but they should not be relied on as statements or representations of fact and they do not constitute any part of an offer or contract. The seller does not make any representation or give any warranty in relation to the property and we have no authority to do so on behalf of the seller. Services, fittings and equipment referred to in the sales details have not been tested (unless otherwise stated) and no warranty can be given as to their condition. We would strongly recommend that all information, which we provide, about the property is verified by yourself or your advisers.

