

Asking Price £109,950

Jayman
www.jayman.co.uk

Estate Agents



Acorn Mews

Willenhall, WV13 1NY

Acorn Mews, Willenhall, WV13 1NY

Jayman offer for sale this well presented 2 bedroom ground floor flat with combined kitchen/living room , bathroom and parking space.

Entrance Hall

Communal entrance hall and airing cupboard.

Open plan Living Room / Kitchen 19'1" x 12'2" (5.82m x 3.73m)

Double glazed French doors, open plan aspect, wood effect flooring, fitted kitchen with a range of wall and base units and work surfaces over, sink and drainer unit with mixer tap, tiled walls, electric oven, electric hob, cooker hood, plumbing for washing machine, fridge freezer and spot lights to ceiling.

Bedroom 1 10'11" x 10'5" (3.35m x 3.18m)

Double glazed window to front elevation, electric wall heater and wood effect flooring.

Bedroom 2 13'5" x 8'2" (4.11m x 2.49m)

Double glazed window to front elevation, door to front elevation, electric wall heater and wood effect flooring

Bathroom

Low level WC, pedestal wash hand basin, bath with mixer tap, shower with shower screen, part tiled walls, wood effect flooring, extractor fan and spot lights to ceiling.



REQUIRE A MORTGAGE? Our independent advisor can compare "whole of market" to help find the best mortgage to suit your circumstances. Please call 01543 416 567 for a free mortgage quote including some deals only available through our network. **LEGAL CONVEYANCING** Jayman Conveyancing provides fast efficient low cost legal work with a no sale-no fee guarantee. Call 01543 416 567. **AGENTS DESCRIPTIONS** These details imply the opinion of the agent at the time these details were prepared and are subjective. It may be that the purchaser's opinion differs. **VIEWING ARRANGEMENTS** By appointment only with Jayman on 01543 416 567 **COUNCIL TAX** Please refer to www.voa.gov.uk for this information. **DESCRIPTIONS AND MEASUREMENTS** All measurements are approximate and some may be maximum on irregular walls. The plan shows the approximate layout of the rooms to show the inter relationship of relationship of one room to another but is not necessarily to scale. **CONSENTS** We have not had sight of any relevant building regulations, guarantees or planning consents and all relevant documentation pertaining to this property should be checked by your legal advisor before exchanging contracts.

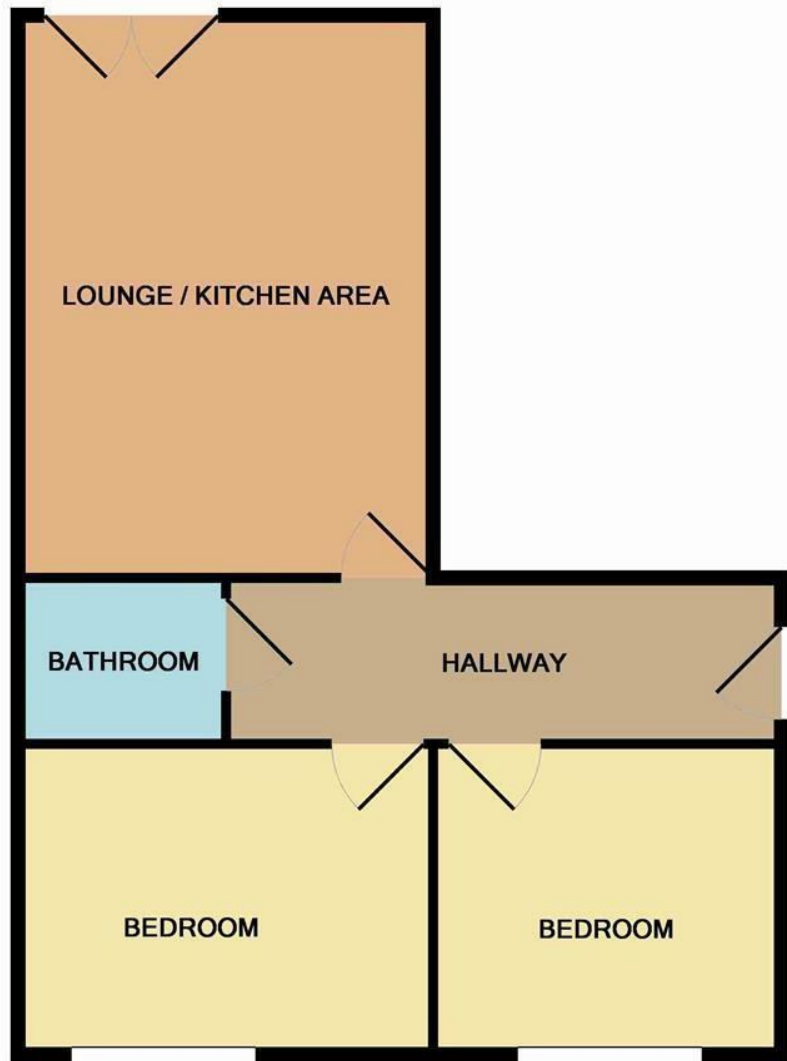

Whilst every attempt has been made to ensure the accuracy of the floor plan contained here, measurements of doors, windows, rooms and any other items are approximate and no responsibility is taken for any error, omission, or mis-statement. This plan is for illustrative purposes only and should be used as such by any prospective purchaser. The services, systems and appliances shown have not been tested and no guarantee as to their operability or efficiency can be given
 Made with Metropix ©2016

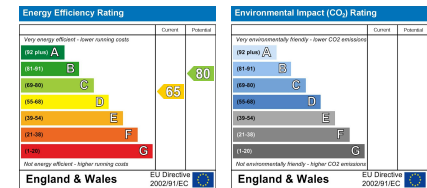
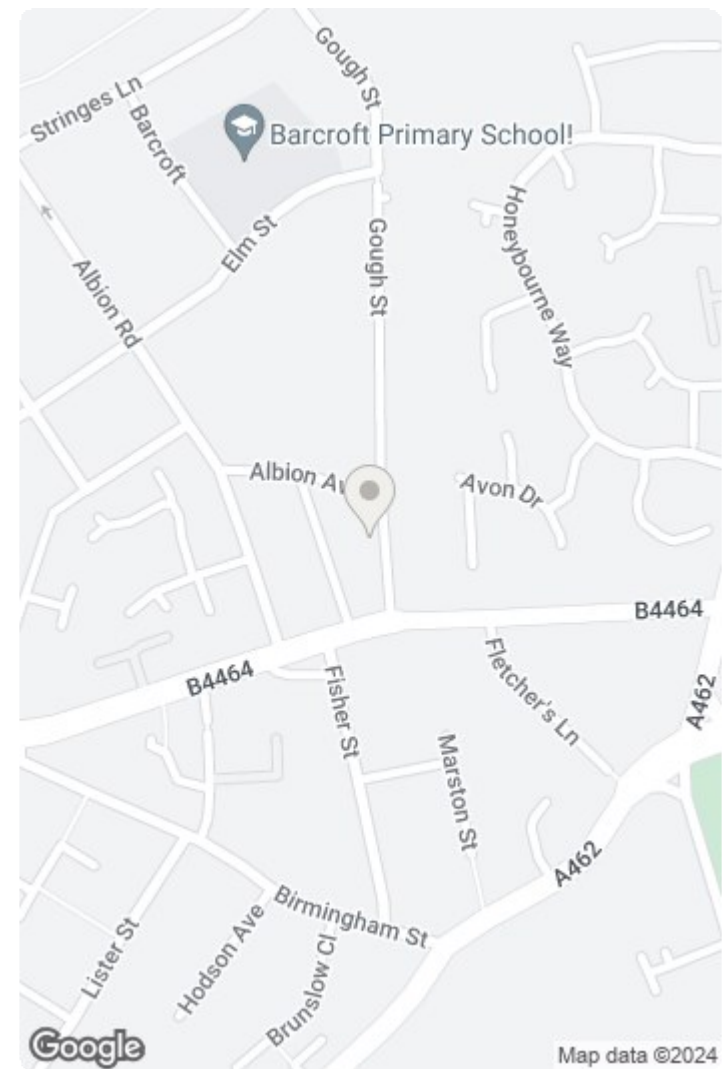

We endeavour to make our sales details accurate and reliable but they should not be relied on as statements or representations of fact and they do not constitute any part of an offer or contract. The seller does not make any representation or give any warranty in relation to the property and we have no authority to do so on behalf of the seller. Services, fittings and equipment referred to in the sales details have not been tested (unless otherwise stated) and no warranty can be given as to their condition. We would strongly recommend that all information, which we provide, about the property is verified by yourself or your advisers.

