



Farrow Close, Swanton Morley, Dereham, NR20

£260,000

3 1 1



- WELL-PRESENTED LINK-DETACHED BUNGALOW
- 16'6 LOUNGE
- FAMILY BATHROOM
- GARAGE & DRIVEWAY
- THREE BEDROOMS
- 10'7 KITCHEN
- ENCLOSED REAR GARDEN
- POPULAR VILLAGE LOCATION





GROUND FLOOR
852 sq.ft. (79.2 sq.m.) approx.

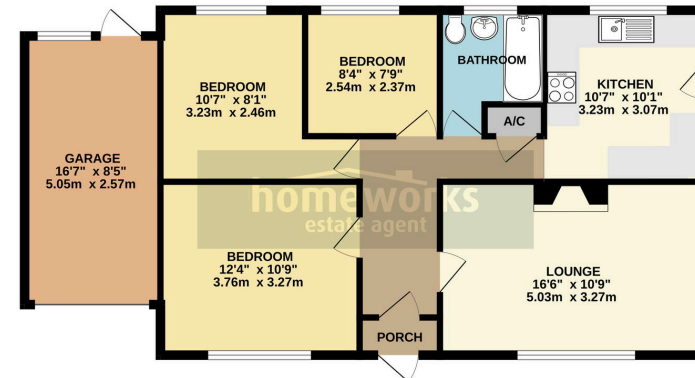

TOTAL FLOOR AREA: 852 sq.ft. (79.2 sq.m.) approx.
Whilst every attempt has been made to ensure the accuracy of the floorplan contained here, measurements of doors, windows, stairs and any other details are approximate and no responsibility is taken for any error, omission or mis-statement. This plan is for illustrative purposes only and should be used as such by any prospective purchaser. The services, systems and appliances shown have not been tested and no guarantee as to their operability or efficiency can be given. Made with Homestyler ©2023

A well-presented three bedroom link-detached bungalow in the popular village of Swanton Morley. Featuring a spacious 16'6 lounge, 10'7 kitchen, family bathroom and an enclosed rear garden. The property also offers a garage, driveway and is situated in a quiet, convenient location.

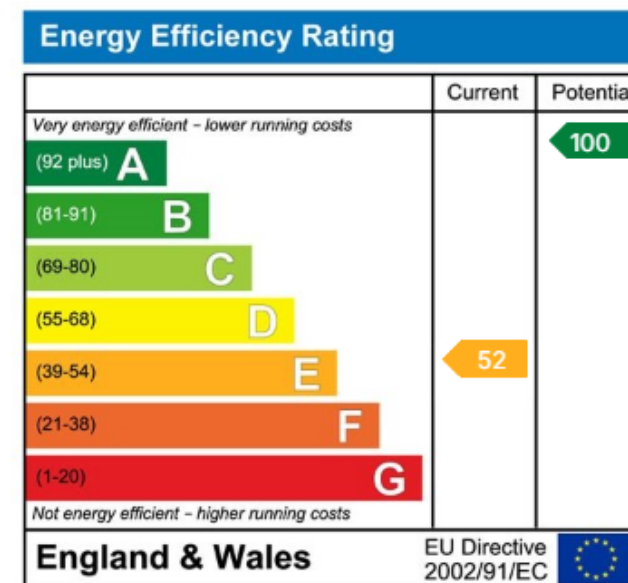

C AMOS MNAEA Managing Director
VAT no. 185 328 683



Homeworks (Dereham) Ltd. Registration Number (08951563) incorporated in England. Registered Office: 45a Norwich Road, Dereham, Norfolk, England, NR20 3AS