



17 Redrise Close, Holbury
£260,000



17 Redrise Close

Holbury, Southampton

Bright and spacious hallway that leads to the living areas. The lounge/diner is generously proportioned and a direct connection to the conservatory. The conservatory itself provides additional flexible living space.

The kitchen is fitted with a range of wall and base units and work surfaces. Direct access from the kitchen to the garden.. The ground floor also includes access to the integral garage.

Upstairs, the property offers three well-proportioned bedrooms. The family shower room features a modern shower enclosure and contemporary fittings.

Additional features of this home include gas fired central heating, which ensures warmth throughout the year, and driveway parking for multiple vehicles. The property benefits from double glazing throughout, contributing to a quiet and comfortable living environment.

Council Tax band: C

Tenure: Freehold



1 Southward House
Dibden Purlieu SO45 4PT



T: 02380 844405

info@anthonyjamesproperties.co.uk



GROUND FLOOR
623 sq.ft. (57.9 sq.m.) approx.

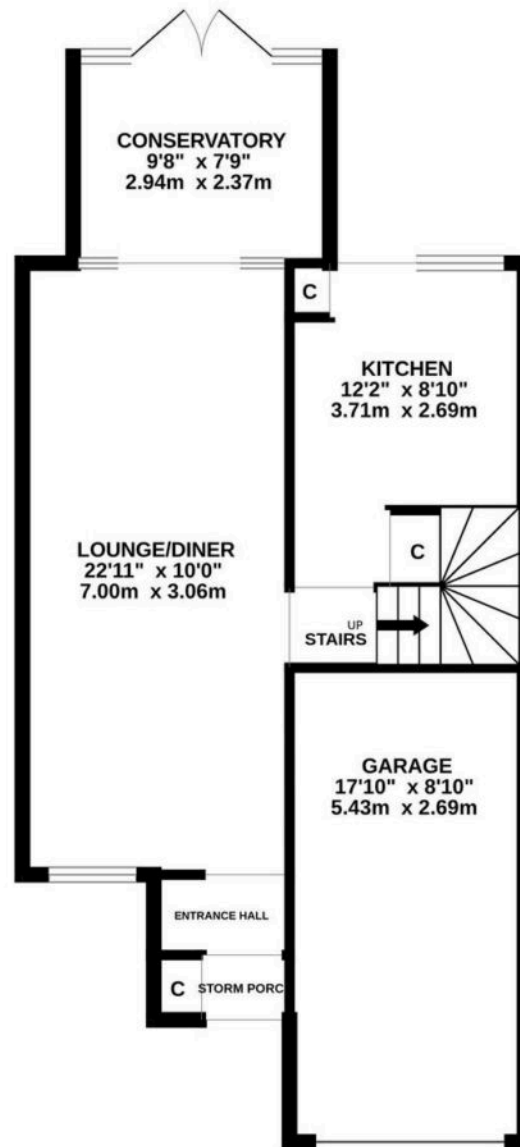

1ST FLOOR
431 sq.ft. (40.0 sq.m.) approx.

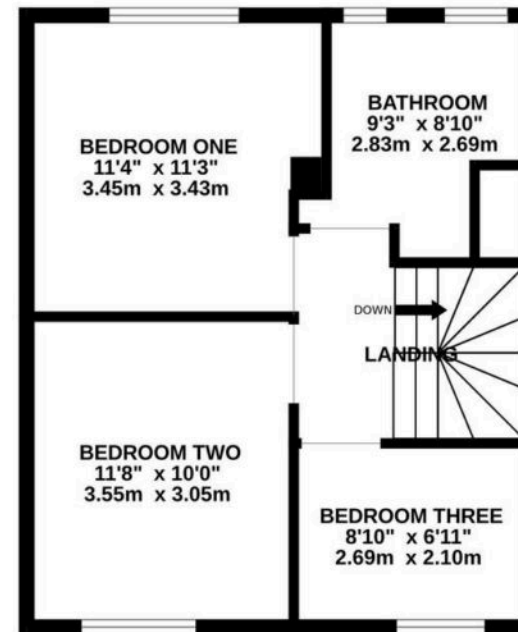

TOTAL FLOOR AREA : 1054 sq.ft. (98.0 sq.m.) approx.

Whilst every attempt has been made to ensure the accuracy of the floorplan contained here, measurements of doors, windows, rooms and any other items are approximate and no responsibility is taken for any error, omission or mis-statement. This plan is for illustrative purposes only and should be used as such by any prospective purchaser. The services, systems and appliances shown have not been tested and no guarantee as to their operability or efficiency can be given.
Made with Metropix ©2025