



7 Prospect Place, Hythe  
£525,000

  
ANTHONY JAMES  
PROPERTIES





# 7 Prospect Place

Hythe, Southampton

Nestled on the historic Hythe Waterfront, this charming character cottage, built in 1808, exudes timeless elegance and offers direct views of Southampton Water. As a Grade II listed property situated in a Conservation Area, this home boasts a prominent position in the heart of Central Hythe. The interior features a kitchen with a stunning vaulted glass ceiling, two open fires, ceiling beams, and bay windows that frame picturesque water views. Additionally, the ground floor shower room and first-floor w/c provide modern convenience whilst maintaining the property's traditional charm. The cottage-style garden is a delightful retreat, perfectly complementing the historic ambience. Off-road parking for one car adds to the convenience of this exceptional property.

The outside space of this magnificent property is truly a sight to behold, with a garden that bursts into life come Springtime. A pergola adorned with a grapevine leads to the courtyard area, while the old air raid shelter has been repurposed for storage and steps surrounded by original brick walls guide you to the main lawn. The garden's meandering flagstone steps lead to a covered parking area, timber outbuilding, and log store. The lush greenery consists of a variety of trees and plants, including Rhubarb, fig, and apple, creating a classic cottage garden atmosphere. Access to the front of the property is through a large timber gate, adding to the privacy and charm of the outdoor space. Parking is conveniently located to the rear of the



**1 Southward House**  
Dibden Purlieu SO45 4PT



**T: 02380 844405**

[info@anthonyjamesproperties.co.uk](mailto:info@anthonyjamesproperties.co.uk)

car along with additional storage and a timber







GROUND FLOOR  
561 sq.ft. (52.1 sq.m.) approx.

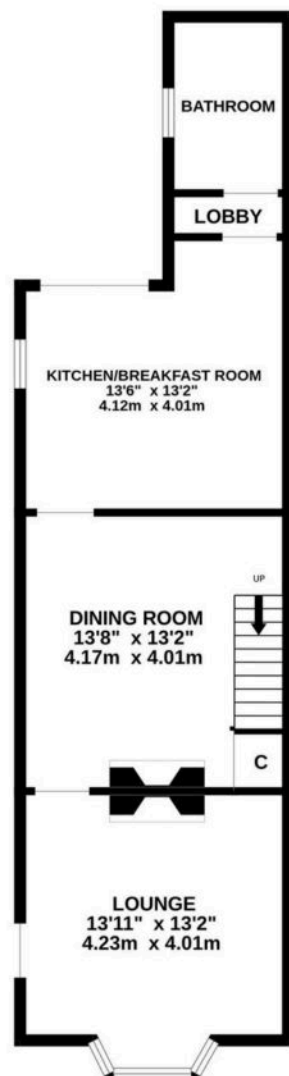

1ST FLOOR  
417 sq.ft. (38.7 sq.m.) approx.



TOTAL FLOOR AREA: 978 sq.ft. (90.8 sq.m.) approx.

Whilst every attempt has been made to ensure the accuracy of the floorplan contained here, measurements of doors, windows, rooms and any other items are approximate and no responsibility is taken for any error, omission or mis-statement. This plan is for illustrative purposes only and should be used as such by any prospective purchaser. The services, systems and appliances shown have not been tested and no guarantee as to their operability or efficiency can be given.  
Made with MetroPix ©2025