



93 Rosebery Avenue, Hythe
£349,950



93 Rosebery Avenue

Hythe, Southampton

Positioned in the popular Hythe location, this extended three bedroom semi-detached house offers a warm and inviting atmosphere. The property boasts a spacious living room with a gas fire, a well-appointed kitchen/diner, and an extended ground floor featuring a utility room and shower room. The fitted four-piece bathroom suite and good proportioned bedrooms provide comfort and functionality. With gas fired central heating and double glazing throughout, this home ensures cosy living all year round. Additionally, the property features a large garden workshop measuring 15'7" x 15'4" and driveway parking for three cars, making it convenient and practical for modern living. The low maintenance garden adds a touch of tranquillity to the outdoor space, perfect for relaxing weekends and social gatherings.

Council Tax band: C

Tenure: Freehold

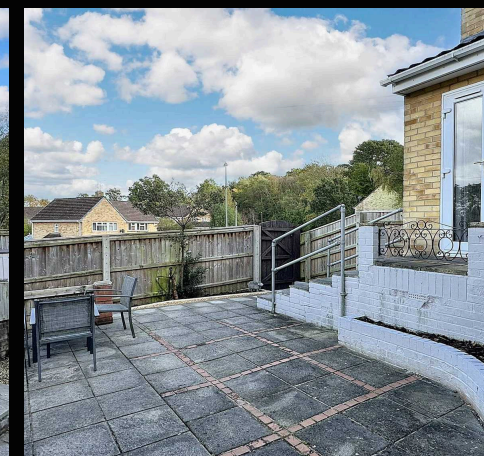

1 Southward House
Dibden Purllieu SO45 4PT



T: 02380 844405
info@anthonyjamesproperties.co.uk



GROUND FLOOR

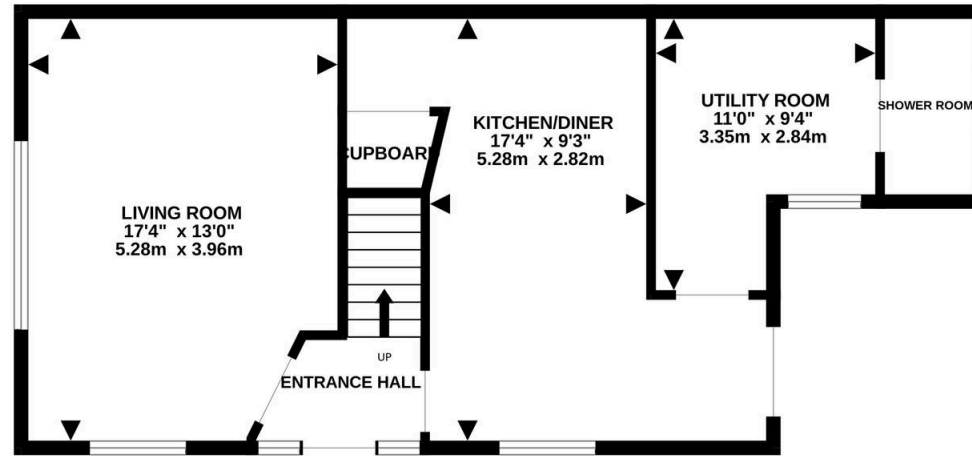

1ST FLOOR

