



17 Coppice Gate Beaulieu Road, Dibden Purlieu – SO45 4PW

£250,000 Leasehold

A beautifully presented first floor apartment offered for sale with NO ONWARD CHAIN and located within the heart of Dibden Purlieu Village. Internally there is a double bedroom with a walk in wardrobe, a living/dining room, a well appointed kitchen, a stylish shower room and a balcony. In addition to this the development benefits from a spacious communal lounge with kitchen facilities, guest accommodation (nominal charge) and generous wrap around gardens within the outside space. Parking spaces can be allocated for an annual charge.

GROUND FLOOR
561 sq.ft. (52.1 sq.m.) approx.

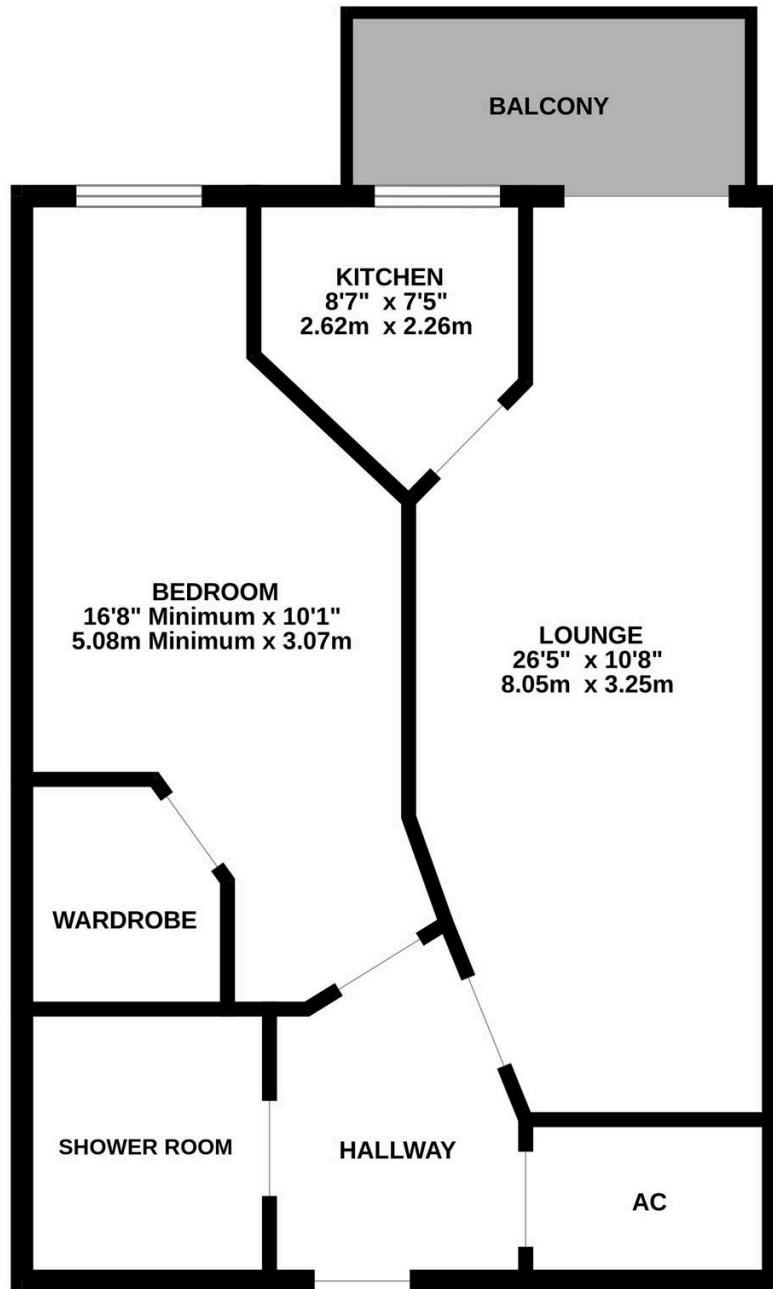

TOTAL FLOOR AREA : 561 sq.ft. (52.1 sq.m.) approx.

Whilst every attempt has been made to ensure the accuracy of the floorplan contained here, measurements of doors, windows, rooms and any other items are approximate and no responsibility is taken for any error, omission or mis-statement. This plan is for illustrative purposes only and should be used as such by any prospective purchaser. The services, systems and appliances shown have not been tested and no guarantee as to their operability or efficiency can be given.

Made with Metropix ©2024

You can include any text here. The text can be modified upon generating your brochure.



1 Southward House
Dibden Purlieu SO45 4PT



T: 02380 844405
info@anthonyjamesproperties.co.uk