

# HUNTERS®

HERE TO GET *you* THERE

**28 Paradise Grove, Horsforth, Leeds, LS18 4RN**

**£1,250 Per Calendar Month**

Property Images



# HUNTERS<sup>®</sup>

HERE TO GET *you* THERE

## Property Images



## Floorplan

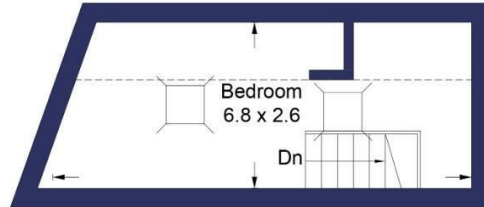

Second Floor



Ground Floor

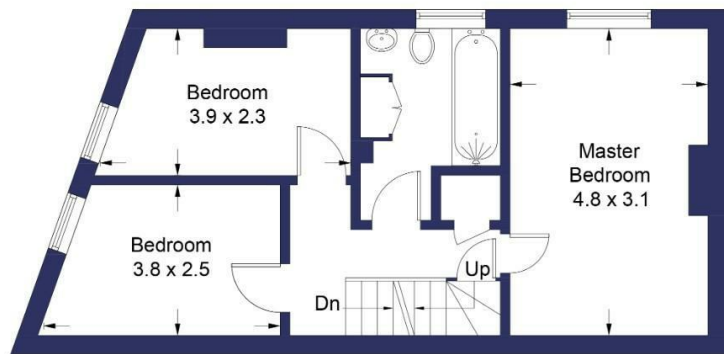

First Floor



## EPC

Energy Efficiency Rating		Current	Potential
<i>Very energy efficient - lower running costs</i>			
(92 plus) <b>A</b>			
(81-91) <b>B</b>			
(69-80) <b>C</b>			74
(55-68) <b>D</b>		46	
(39-54) <b>E</b>			
(21-38) <b>F</b>			
(1-20) <b>G</b>			
<i>Not energy efficient - higher running costs</i>			
<b>England &amp; Wales</b>		EU Directive 2002/91/EC	

## Map

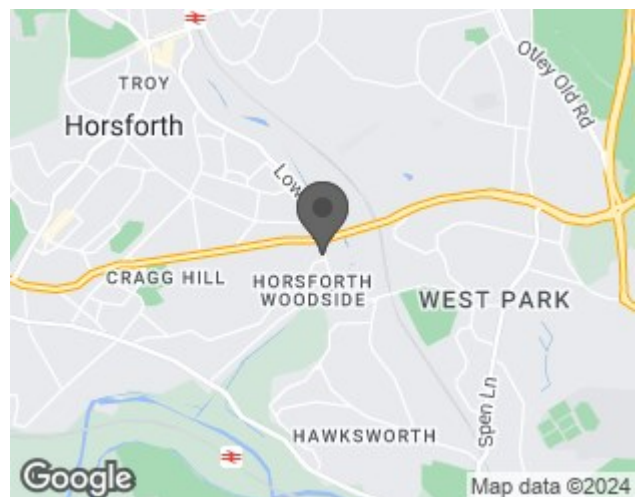

## Details

Type: House - End Terrace Beds: 4 Bathrooms: 1 Receptions: 1 Tenure:

## Summary

Paradise Grove is a four bed, period stone terrace, fantastically located for easy commuting. Equidistant between Horsforth Train Station and Kirkstall Forge it also has great bus connections and road links to all of North Leeds. It is also within walking distance of convenience stores and restaurants.

Some of this homes features:

- Four Double Bedrooms
- Large Living Room
- Clean, bright, light kitchen
- Off Street parking
- Well maintained
- Redecorated
- Family bathroom
- Fantastic location

Property Available: 22nd July 2024

Deposit: 5 weeks

Unfurnished

Call us now to book your viewing.

## Features

• FOUR BEDROOMS • STONE TERRACE • OFF STREET PARKING • WELL LOCATED FOR TRANSPORT CONNECTIONS • NEWLY DECORATED • AVAILABLE 21ST AUGUST 2023 • DEPOSIT: 5 WEEKS £1500 • EPC: E • COUNCIL TAX: B