

HUNTERS®

HERE TO GET *you* THERE

Sydney Street, Farsley, LS28

Guide Price £200,000



HUNTERS[®]

HERE TO GET *you* THERE



Sydney Street, Farsley, Pudsey, LS28

Approximate Area = 929 sq ft / 86.3 sq m

For identification only - Not to scale



SECOND FLOOR
APPROX FLOOR
AREA 17.3 SQ M
(187 SQ FT)

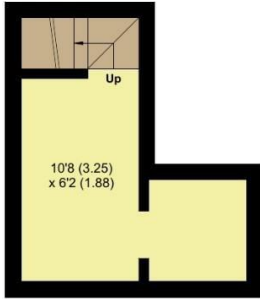

BASEMENT
AREA 10.7 SQ M
(116 SQ FT)



GROUND FLOOR
APPROX FLOOR
AREA 29 SQ M
(313 SQ FT)



FIRST FLOOR
APPROX FLOOR
AREA 29 SQ M
(313 SQ FT)



Floor plan produced in accordance with RICS Property Measurement Standards incorporating International Property Measurement Standards (IPMS2 Residential). © nichecom 2024. Produced for Hunters Property Group. REF: 1117875

EPC

Energy Efficiency Rating		Current	Potential
Very energy efficient - lower running costs			
(92 plus) A			87
(81-91) B			
(69-80) C			
(55-68) D		63	
(39-54) E			
(21-38) F			
(1-20) G			
Not energy efficient - higher running costs			
England & Wales		EU Directive 2002/91/EC	

Map

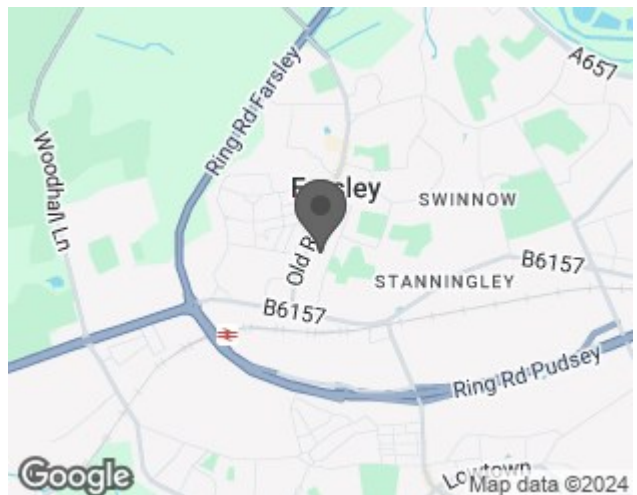

Let your lifestyle desires take centre stage. Where style meets convenience. Discover distinction. Embrace the exceptional. Unveil the enchantment of Farsley life.

Welcome to this stunning and charming stone terrace, where modern luxury meets cosy comfort in the heart of Farsley Village. Tucked away from the vibrant pulse of Town Street, yet just a leisurely 5-minute stroll from its eclectic mix of bars, galleries, coffee shops, and boutiques, this abode offers more than just a place to live – it's a gateway to the best of both worlds. Embrace the vibrant culture of Farsley Village, indulge in leisurely strolls through nearby parks and countryside, or hop on a train for an adventure in the city. The choice is yours, and the possibilities are endless.

The allure of city life isn't far away. Just a short stroll from your doorstep lies New Pudsey Train Station, a mere 0.5 miles away – a quick 10-minute walk for most. From here, it's a seamless journey into the bustling heart of Leeds City Centre, whether you're commuting for work or seeking an evening of entertainment. Enjoy the convenience of easy access to Leeds day or night, knowing you can return to the peaceful sanctuary of home whenever you desire.

Farsley's allure is on the rise, drawing in a younger, hip crowd eager to immerse themselves in its historic charm and burgeoning social scene. Once bustling mills now stand as iconic landmarks, weaving together the village's rich past with its vibrant present. Whether you seek a serene morning in Nunroyd Park, a picturesque jaunt along the canal to Leeds, or a leisurely exploration of nearby Fulneck or Calverley Woods, adventure awaits just beyond your doorstep.

Step inside this lovingly renovated home, where every detail reflects the care and craftsmanship of its current owners. A seamless blend of high-quality finishes and luxurious touches sets the stage for effortless living, inviting you to simply unpack and unwind. From the sleek modern kitchen to the inviting warmth of the fireplace, every corner exudes a sense of comfort and style.

As Farsley garners national attention for its undeniable charm and appeal, now is your chance to be part of its story. Whether you crave the buzz of community events or cherish quiet evenings at home, this property offers the perfect backdrop for your ideal lifestyle. Book your viewing to make this your new home and discover the magic of Farsley living!