

HUNTERS[®]

HERE TO GET *you* THERE



Glebe Gate

Dewsbury, WF12 0JX

Guide Price £220,000



GUIDE PRICE £220,000 - £230,000

This much improved and exceptional semi-detached family home would be of particular interest to the family purchaser in this most popular and sought after residential area of Thornhill. This would be an ideal home for those buyers wanting a modern home with high specification fixture and fittings, in a ready to move in condition with minimum of fuss or expense. Having a entrance hallway, spacious lounge, and impressive open plan dining kitchen as well as a contemporary fitted bathroom. The property has the scope to be extended to liken similar properties in the street. (Subject to obtaining the relevant planning consents) An internal viewing is a must to appreciate this beautiful family home.



ENTRANCE

Entrance through double glazed door and having laminate flooring and fitted radiator with stairs to the first floor and door into

LOUNGE 11'5" x 13'9" (3.48m x 4.20m)

A spacious front lounge with fitted laminate flooring and focal point exposed brick fire place with inset log burner and large double glazed window with fitted blinds. Door to

DINING KITCHEN 14'7" x 10'10" (4.46m x 3.32m)

A spacious open plan kitchen with plenty of natural light, designed with an L shaped design the kitchen is fitted with wall and base units with complimentary work surfaces, large belfast sink with half drainer and glass splash backs, fitted appliances include induction hob with integrated washing machine and fridge freezer, double glazed door to garden. Two double glazed windows with fitted blinds to rear with further radiator and laminate flooring throughout

LANDING

Access to three bedrooms and family bathroom with double glazed window to side, airing cupboard and access to loft (Not Inspected)

BEDROOM 1 14'0" x 8'9" (4.28m x 2.67m)

A large double bedroom with fitted radiator and double glazed window with fitted blinds

BEDROOM 2 8'7" x 10'5" (2.64m x 3.20m)

A large double bedroom with fitted radiator and double glazed window with fitted blinds

BEDROOM 3 8'5" x 5'4" (2.59m x 1.65m)

A single bedroom with fitted radiator and double glazed window with fitted blinds

BATHROOM

Three piece suite comprising of P shaped bath with fitted shower screen and tap attached mixer shower with overhead shower,pedestal wash hand basin with part tiled walls and flooring with heated chrome towel styled radiator and double glazed window with fitted blinds.

GARDEN

To the front there is tarmacadam drive providing off street parking to the front for parking for two cars and an paved pathway to the side with secure gated access leading to the patio seating area which leads onto the extensive large rear garden providing ample privacy to enjoy the summer months with al freshco dining with family and friends.

LOG CABIN

Fitted with two double glazed doors and offers an ideal place for rest and relaxation with fitted sink and low level wc and offers storage space or quite simply a place for quiet contemplation away from the family residence.

Area Map



Floor Plans

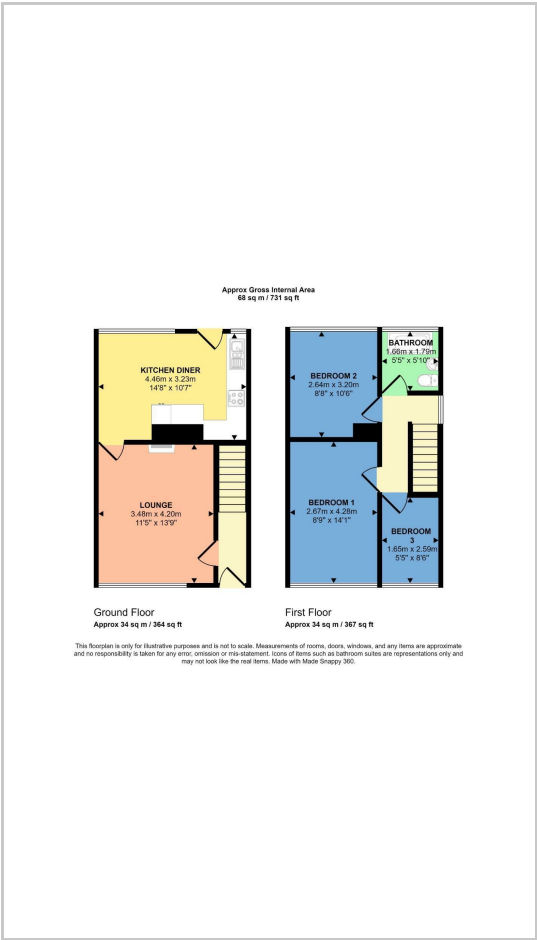

Energy Efficiency Graph

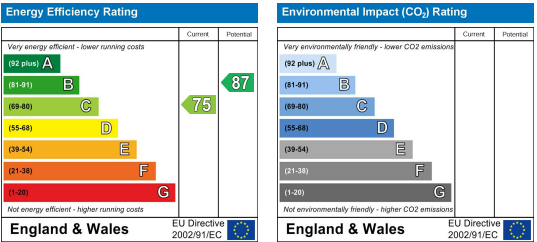

These particulars are intended to give a fair and reliable description of the property but no responsibility for any inaccuracy or error can be accepted and do not constitute an offer or contract. We have not tested any services or appliances (including central heating if fitted) referred to in these particulars and the purchasers are advised to satisfy themselves as to the working order and condition. If a property is unoccupied at any time there may be reconnection charges for any switched off/disconnected or drained services or appliances - All measurements are approximate. **THINKING OF SELLING?** If you are thinking of selling your home or just curious to discover the value of your property, Hunters would be pleased to provide free, no obligation sales and marketing advice. Even if your home is outside the area covered by our local offices we can arrange a Market Appraisal through our national network of Hunters estate agents.