

*tavistockbow*

**For Rent**



**People Make Places**



**Harlequin Court, Covent Garden WC2**

2 bedrooms | 882 sq ft

£1,200 pw





A lateral two bedroom and two bathroom apartment in a sought-after residential building with weekday porter in Covent Garden. Flooded in natural light and finished in a contemporary style, this inviting space has an open plan kitchen and and living area. Available from early July, furnished.

#### What you need to know

- Two bedrooms
- Two bathrooms
- Lateral space
- Bright outlook
- Central Covent Garden location
- Open plan kitchen
- Recently renovated
- Sought-after building
- Concierge
- Available early July







### Overview

Enviably located on the corner of Tavistock Street and Burleigh Street in the heart of London's West End, is this two bedroom and two bathroom apartment that has been finished to a contemporary aesthetic. Situated on the third floor with great natural light and views onto the surrounding streets thanks to its corner position, this well-proportioned lateral apartment features a bright open plan living space with a kitchen neatly tucked away at one end. The master bedroom features an ensuite bathroom while a further guest shower room is accessible from the hallway. Harlequin Court benefits from lift access and a weekday porter.

Harlequin Court is a collection of four period buildings featuring 41 apartments, refurbished and developed in the early 2000's and arranged around a beautiful Japanese style communal garden, which remains to this day as one of Covent Garden's most sought after residential buildings. Transport links can be accessed via Covent Garden (Piccadilly Line) Underground Station while mainline services to London Bridge and out of





London can be reached via nearby Charing Cross. Buses operate nearby on the Strand, while the Southbank, Soho, Mayfair and St James's are within walking distance.

The apartment is available in July on a furnished basis. Subject to contract and satisfactory references, the landlord offers a 12 month lease with a mutual rolling six-month break clause. Westminster Council tax band: G.



**Harlequin Court, Covent Garden WC2**



# People Make Places

London is a collection of inspiring urban villages and one of the most exciting places in the world to live, work & play.

We work with both property owners and their occupiers, sharing the story of these vibrant neighbourhoods, conveying the unique soul & energy to future custodians, the people who'll keep them buzzing.

And unlike many real estate businesses we're not just about buildings, because streets & buildings don't make a neighbourhood.

We're about building relationships, because **people make places**.

MISINTERPRETATION ACT (COPYRIGHT) DISCLAIMER: Tavistock Bow Ltd for themselves and for the vendor(s) of this property whose agents they are, given notice that: 1. These particulars do not constitute, not constitute any part of, an offer or contract. 2. None of the statements contained in these particulars as to the property are to be relied on as statements or representations of fact. 3. Any intending purchaser or lessee must satisfy themselves by inspection or otherwise as to the correctness of each of the statements contained in these particulars. 4. The vendor(s) or lessor(s) do not make or give and neither Tavistock Bow Ltd nor any person in their employment has any authority to make or give any representation or warranty whatever in relation to this property. Finance Act 1989, Unless otherwise stated all prices and rents are quote exclusive of VAT. Property Misrepresentation Act 1991; These details are believed to be correct at the time of compilation but may be subject to subsequent amendment.

Follow us:     @tavistockbow

Score	Energy rating	Current	Potential
92+	A		
81-91	B		83 B
69-80	C		
55-68	D	64 D	
39-54	E		
21-38	F		
1-20	G		

## Harlequin Court, WC2

Approximate Gross Internal Area 82 sq m / 882 sq ft

### Third Floor

1 Living / Kitchen / Dining 5.00 x 8.20M 16'4" x 26'9"	2 Bedroom 6.67 x 3.00M 21'8" x 9'8"	3 Bedroom 4.12 x 3.00M 13'5" x 9'8"
--	---	---

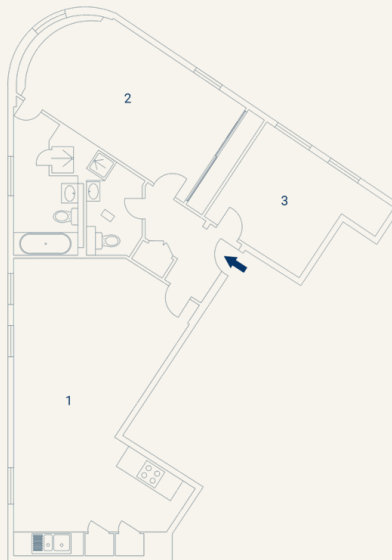

Floorplan produced for Tavistock Bow. Illustration for identification purposes only and not to scale. All measurements are approximate and not to be relied upon.

**tavistockbow**

21 New Row, Covent Garden,  
London, WC2N 4LE

t: 020 7477 2177  
e: [hello@tavistockbow.com](mailto:hello@tavistockbow.com)  
w: [tavistockbow.com](http://tavistockbow.com)

**Harlequin Court, Covent Garden WC2**

