

tavistockbow

For Sale



People Make Places



Little Adelphi, St Martins & Strand WC2

1 bedroom | 420 sq ft

£725,000





A fantastic one bedroom apartment with views towards the river Thames. Located on the 1st floor (with lift) of a great residential development on John Adam Street, just off the Strand. The Little Adelphi benefits from 24 hour portorage and secure underground parking.

What you need to know

- One double bedroom
- First floor
- Views to River Thames
- 24 hour porter
- Underground parking
- South Facing
- Separate kitchen
- Lift
- Annual service charge of £5,400
- Share of Freehold



Little Adelphi, St Martins & Strand WC2



Overview

A bright one bedroom apartment situated on the first floor of The Little Adelphi, this ever-popular and sought after portered block on John Adam Street, WC2.

Presented in fantastic condition, this secluded apartment faces south and has views over the quiet street with open views towards the River Thames.

This sought after building is served by two passenger lifts and a 24 hour concierge, with secure parking under the building. This apartment has access to a secure store room at an additional rent of £125 per year.

The River Thames and Embankment Gardens are a close stroll away. Covent Garden's bustling Piazza is within easy reach along with the many dining and retail attractions of the West End. Countless restaurants, boutiques, luxury retailers, coffee shops and more are to hand, not to mention the excellent transport links from nearby Charing Cross and Embankment stations.



Little Adelphi, St Martins & Strand WC2

People Make Places

London is collection of inspiring urban villages and one of the most exciting places in the world to live, work & play.

We work with both property owners and their occupiers, sharing the story of these vibrant neighbourhoods, conveying the unique soul & energy to future custodians, the people who'll keep them buzzing.

And unlike many real estate businesses we're not just about buildings, because streets & buildings don't make a neighbourhood.

We're about building relationships, because **people make places**.

MISINTERPRETATION ACT (COPYRIGHT) DISCLAIMER: Tavistock Bow Ltd for themselves and for the vendor(s) of this property whose agents they are, given notice that: 1. These particulars do not constitute, not constitute any part of, an offer or contract. 2. None of the statements contained in these particulars as to the property are to be relied on as statements or representations of fact. 3. Any intending purchaser or lessee must satisfy themselves by inspection or otherwise as to the correctness of each of the statements contained in these particulars. 4. The vendor(s) or lessor(s) do not make or give and neither Tavistock Bow Ltd nor any person in their employment has any authority to make or give any representation or warranty whatever in relation to this property. Finance Act 1989, Unless otherwise stated all prices and rents are quote exclusive of VAT. Property Misrepresentation Act 1991; These details are believed to be correct at the time of compilation but may be subject to subsequent amendment.

Follow us:     @tavistockbow

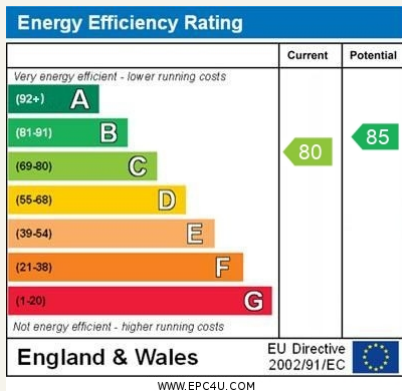

The Little Adelphi, WC2

Approximate Gross Internal Area 39 sq m / 420 sq ft

First Floor

1 Reception Room
3.81 x 3.29M
12'6" x 10'10"

2 Bedroom
3.81 x 2.88M
12'6" x 9'5"

3 Kitchen
2.31 x 2.21M
7'7" x 7'3"

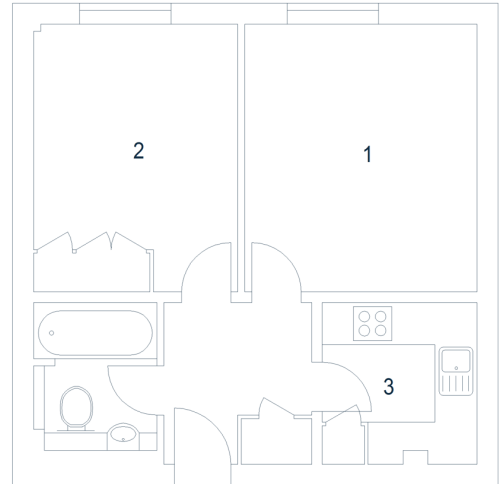

Floor Plan produced for Tavistock Bow by Mays Floorplans © . Tel 020 3397 4594
Illustration for identification purposes only, not to scale.

tavistockbow

21 New Row, Covent Garden,
London, WC2N 4LE

t: 020 7477 2177
e: hello@tavistockbow.com
w: tavistockbow.com



Little Adelphi, St Martins & Strand WC2