

HUNTERS®

HERE TO GET *you* THERE



Waudby Close

Walkington, Beverley, HU17 8SA

Offers In The Region Of £350,000



Council Tax: E



21 Waudby Close

Walkington, Beverley, HU17 8SA

Offers In The Region Of £350,000



Entrance Porch

Double glazed sliding door into porch.

Entrance Hall

Wooden front door, coving and textured ceiling, radiator and power points.

Downstairs Toilet

Single glazed window to the front aspect, low flush WC and wash hand basin.

Lounge

UPVC double glazed windows to the front and side aspects, coving, gas feature fireplace, radiator, TV point and power points.

Kitchen

UPVC double glazed windows to the side and rear aspects, range of wall and base units with roll top work surfaces, tiled splash back, sink and drainer unit, plumbed for washing machine, space or fridge/freezer, space for dryer, electric oven, electric hob, radiator and power points.

Bedroom One

UPVC double glazed window to the rear aspect, coving, fitted wardrobes, radiator and power points.

Bedroom Two

UPVC double glazed window to the rear aspect, coving, fitted wardrobes, radiator and power points.

Bedroom Three/ Dining Room

UPVC double glazed window to the front aspect, coving, radiator and power points.

Bathroom

UPVC double glazed window to the side aspect, tiled

walls, four piece bathroom suite comprising; bath with mixer taps, separate shower cubicle, low flush WC, wash hand basin with pedestal and radiator.

Loft Room

Single glazed window to the rear aspect, wash hand basin with vanity, storage cupboard and power points.

Garden

Low maintenance garden, patio area, side access and outside tap.

Parking

Private parking for ample vehicles and car port.

Material Information - Hunters Beverley

Tenure Type; FREEHOLD

Council Tax Banding;

A charming property that offers the perfect blend of countryside tranquillity and town convenience. This beautiful bungalow is nestled in a picturesque village just outside the historic town of Beverley, making it an ideal retreat for those seeking a peaceful lifestyle.

The property itself is a gem waiting to be polished, offering ample opportunities for modernising and personalising to create your dream home. Whether you are looking to add your own touch to the interiors or enhance the outdoor space, this house provides a blank canvas for your creativity to flourish.

Imagine waking up to the sound of birds chirping and the gentle rustle of leaves in the breeze, all while being just a stone's throw away from the vibrant amenities of Beverley. From quaint cafes to boutique shops, this location offers the best of both worlds - rural serenity and urban convenience.

Don't miss out on the chance to own a piece of this idyllic setting. Embrace the potential of this beautiful bungalow and turn it into the home you've always dreamed of. Book a viewing today and let your imagination run wild with the possibilities that this property has to offer.



Road Map



Hybrid Map



Terrain Map



Floor Plan

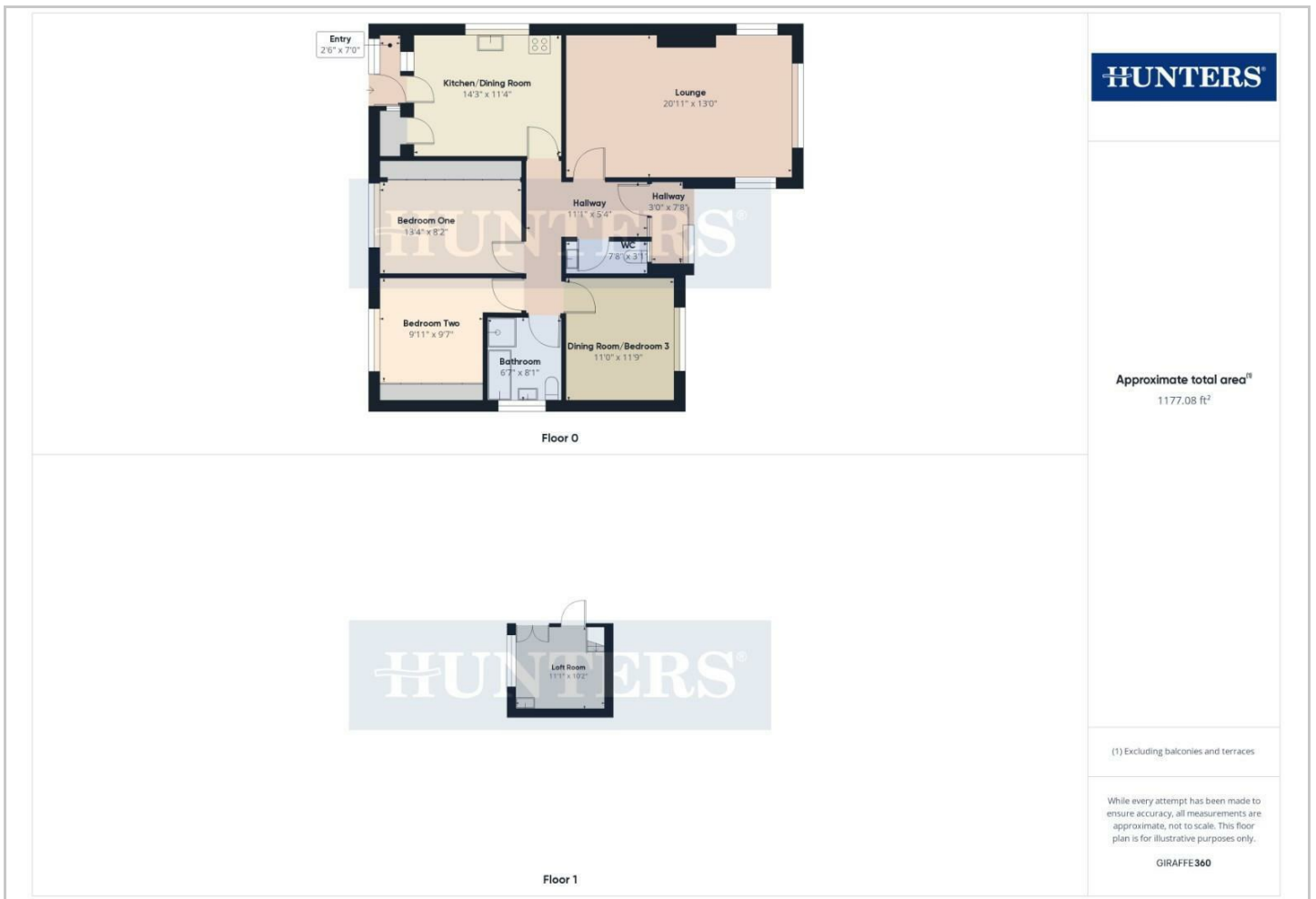

Viewing

Please contact our Hunters Beverley Office on 01482 861411 if you wish to arrange a viewing appointment for this property or require further information.

Energy Efficiency Graph

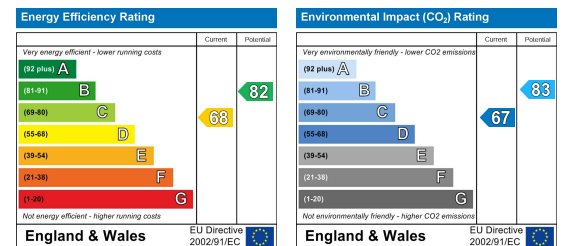

These particulars are intended to give a fair and reliable description of the property but no responsibility for any inaccuracy or error can be accepted and do not constitute an offer or contract. We have not tested any services or appliances (including central heating if fitted) referred to in these particulars and the purchasers are advised to satisfy themselves as to the working order and condition. If a property is unoccupied at any time there may be reconnection charges for any switched off/disconnected or drained services or appliances - All measurements are approximate. **THINKING OF SELLING?** If you are thinking of selling your home or just curious to discover the value of your property, Hunters would be pleased to provide free, no obligation sales and marketing advice. Even if your home is outside the area covered by our local offices we can arrange a Market Appraisal through our national network of Hunters estate agents.