



- Four bedroom house
- Refurbished by the current owners
- Two Reception Rooms
- Extended kitchen Breakfast

231 South Farm Road, Offington, Worthing, West Sussex, BN14 7TW

£425,000

W Welch Estate Agents are pleased to bring to the market this 1930's mock tudor style mid terraced house with two reception rooms as well as four bedrooms. The property is extremely well presented throughout and offers a lot of versatility in terms of living space! The accommodation consists of an entrance hall, lounge, dining room and an extended kitchen breakfast room. To the first floor landing we have, three bedrooms and a family bathroom/W.C, converted loft to create an impressive master bedroom with en-suite. Externally the property offers a front garden and private west facing garden with private parking for two cars.

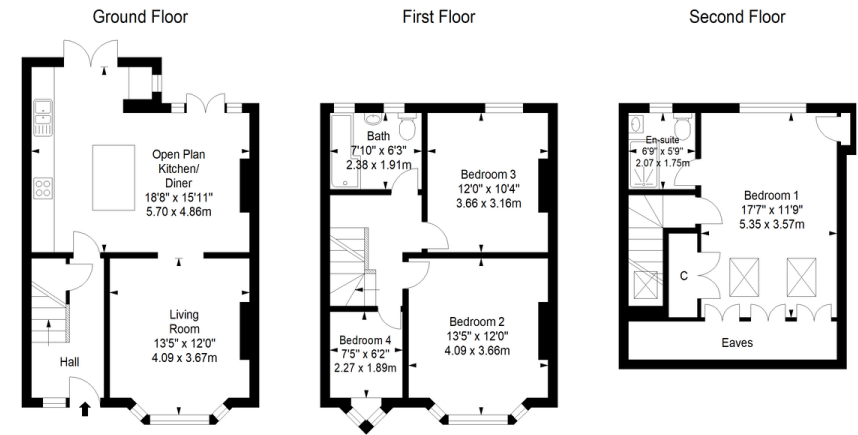

Approximate gross internal floor area 119.7 sq m/ 1288.5 sq ft  
 Whilst every care has been taken to ensure accuracy, dimensions are approximate and for illustrative purposes only.  
 All rights reserved.



%epcGraph\_c\_1\_334%

3 Marston Road, Worthing, West  
 Sussex, BN14 8BD

[www.w-welchestateagents.co.uk](http://www.w-welchestateagents.co.uk)  
 01903 898000  
[sales@w-welchestateagents.co.uk](mailto:sales@w-welchestateagents.co.uk)

Agents Note: Whilst every care has been taken to prepare these particulars, they are for guidance purposes only. All measurements are approximate and for general guidance purposes only and whilst every care has been taken to ensure their accuracy, they should not be relied upon and potential buyers/tenants are advised to recheck the measurements