



- TWO DOUBLE BEDROOMS
- MAISONETTE
- PRIVATE GARDEN
- ATTACHED GARAGE

GFF , 32 Gaisford Close, Worthing, BN14 7HX

Offers In Excess Of £275,000

W Welch Estate Agents offer for sale a two bedroom maisonette flat with private garden and Situated in a sought-after location in the Gaisford Community which is part of the Tarring Parish, close to shops and transport links. The property comprises a light and airy lounge. From the kitchen there is a door opening out to the rear garden and ability to put in access from the garden to the garage which is attached to the property. The first floor comprises two good sized family bathrooms and a family bathroom. This would make an ideal starter home, family home or investment. 50/50 Share of Freehold. Please call Tel: 01903 898000.

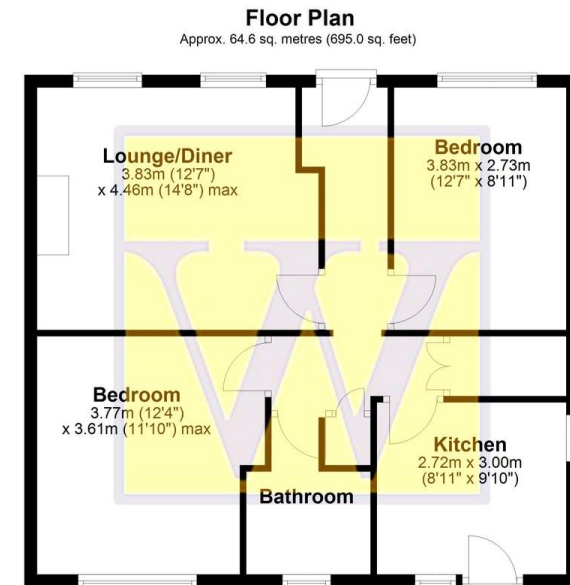

Total area: approx. 64.6 sq. metres (695.0 sq. feet)



3 Marston Road, Worthing, West
Sussex, BN14 8BD

www.w-welchestateagents.co.uk
01903 898000
sales@w-welchestateagents.co.uk

Agents Note: Whilst every care has been taken to prepare these particulars, they are for guidance purposes only. All measurements are approximate and are for general guidance purposes only and whilst every care has been taken to ensure their accuracy, they should not be relied upon and potential buyers/tenants are advised to recheck the measurements