



- LARGE GARDEN
- TWO BEDROOM
- LARGE KITCHEN/DINER
- OFF ROAD PARKING

14 Mendip Road, Salvington, Worthing, West Sussex, BN13 2LP Offers In Excess Of £275,000

W Welch are delighted to offer to the market this home situated in the sort after Lower Salvington area. Close to the rolling hills of the South Downs, this property offers it's own spacious garden, and is close to the local schools, big Tesco, bus routes and parks making it perfect for families. This property boasts a good size living area with a fireplace feature wall, and an open dining/kitchen leading onto the fantastic garden. Upstairs are two great sized bedrooms and a smart and modern bathroom. Viewing is highly recommend.



Property Description

W Welch are delighted to offer to the market this home situated in the highly sort after Salvington area. Close to the rolling hills of the South Downs, this property offers it's own spacious garden, and is close to the local schools, big Tesco, bus routes and parks making it perfect for families. This property boasts a good size living area with a fireplace feature wall, and an open dining/kitchen leading onto the fantastic garden. Upstairs are two great sized bedrooms and a smart and modern bathroom. Viewing is highly recommend.

LOUNGE

KITCHEN/DINER

BEDROOM 1

BEDROOM 2

BATHROOM

LARGE GARDEN





Ground Floor

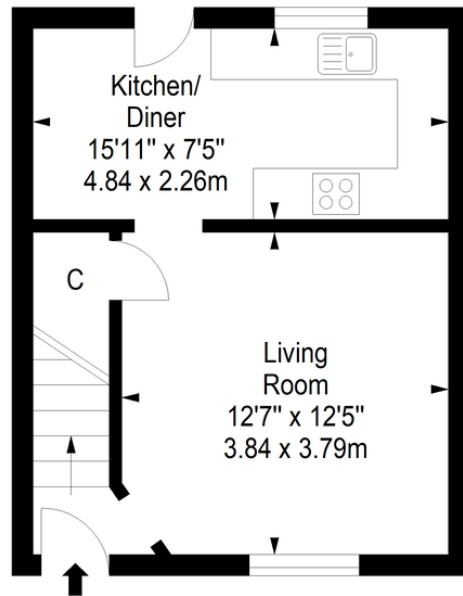

First Floor

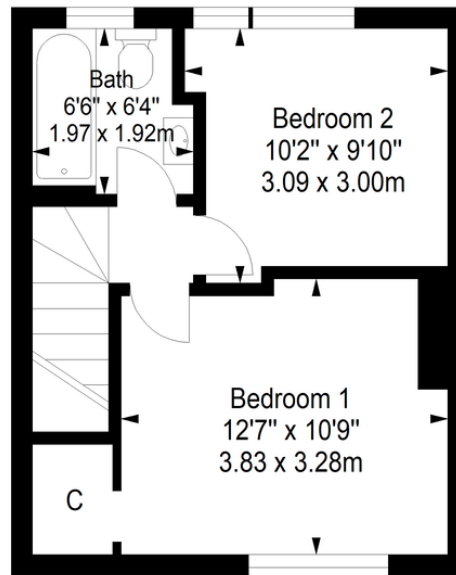

Approximate gross internal floor area 60.8 sq m/ 654.5 sq ft

Whilst every care has been taken to ensure accuracy, dimensions are approximate and for illustrative purposes only.
All rights reserved.

%epcGraph_c_1_334%

3 Marston Road, Worthing, West
Sussex, BN14 8BD

www.w-welchestateagents.co.uk
01903 898000
sales@w-welchestateagents.co.uk

Agents Note: Whilst every care has been taken to prepare these particulars, they are for guidance purposes only. All measurements are approximate and for general guidance purposes only and whilst every care has been taken to ensure their accuracy, they should not be relied upon and potential buyers/tenants are advised to recheck the measurements