

BRANOC'S
ESTATES



20 HIGH GARRETT, BRAINTREE CM7

£3,800 PER MONTH

5 Bedrooms | 3 Bathrooms | 3 Receptions

Floor Plan

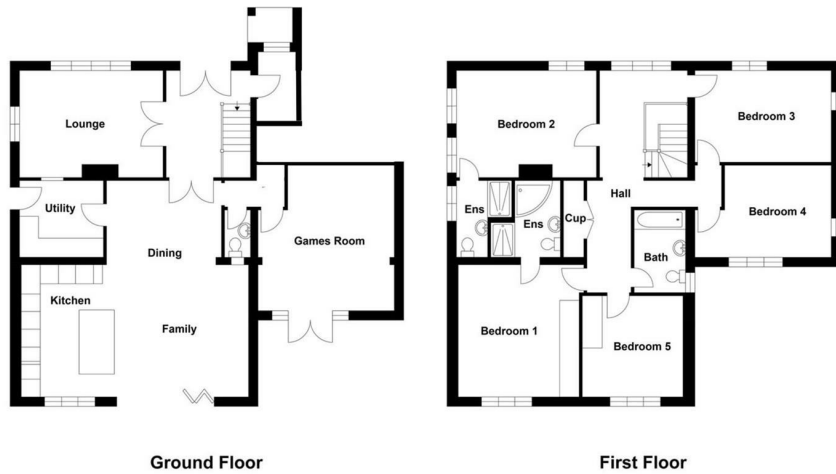

Whilst every attempt has been made to ensure the accuracy of the floor plan contained here, measurements of doors, windows, rooms and any other items are approximate and no responsibility is taken for any error, omission, or misstatement. The plan is for illustrative purposes only and should be used as such by any prospective purchaser. The services, systems and appliances shown have not been tested and no guarantee as to their operability or efficiency can be given.

Area Map

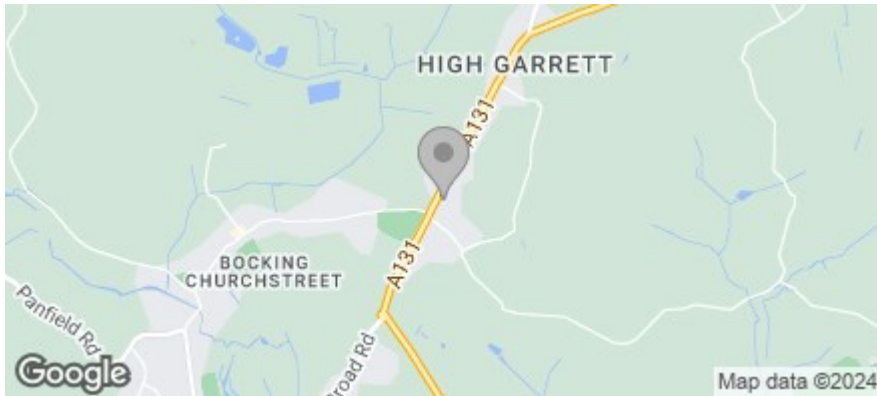

Accommodation

- FIVE BEDROOMS
- THREE RECEPTION ROOMS
- DRIVEWAY PARKING FOR MULTIPLE VEHICLES
- SWIMMING POOL WITH POOL MAINTENANCE INCLUDED IN RENT
- SUMMER HOUSE WITH ELECTRICITY AND ACCESS TO WIFI
- EASY ACCESS TO A120
- AVAILABLE DECEMBER
- TWO EN-SUITE BATHROOMS
- UTILITY ROOM

Viewing

Please contact us on 01376 386555 if you wish to arrange a viewing appointment for this property, or require further information.

Energy Efficiency Graph

Energy Efficiency Rating		Current	Potential
<i>Very energy efficient - lower running costs</i>			
(92 plus) A			
(81-91) B			
(69-80) C			
(55-68) D			
(39-54) E			
(21-38) F			
(1-20) G			
<i>Not energy efficient - higher running costs</i>			
England & Wales	EU Directive 2002/91/EC		

Environmental Impact (CO ₂) Rating		Current	Potential
<i>Very environmentally friendly - lower CO₂ emissions</i>			
(92 plus) A			
(81-91) B			
(69-80) C			
(55-68) D			
(39-54) E			
(21-38) F			
(1-20) G			
<i>Not environmentally friendly - higher CO₂ emissions</i>			
England & Wales	EU Directive 2002/91/EC		



Phone: 01376 386555
Email: info@branocsestates.co.uk
Website: www.branocsestates.co.uk

Phoenix House 5 New Street
 Braintree
 Essex
 CM7 1ER

Branocs endeavour to maintain accurate depictions of properties in Virtual Tours, Floor Plans and descriptions, however, these are intended only as a guide and purchasers must satisfy themselves by personal inspection.

